

# Construction Notice Adkins Station Expansion Project



PUCO Case No. 23-0042-EL-BNR

Submitted to:  
The Ohio Power Siting Board  
Pursuant to Ohio Administrative Code Section  
4906-6-05

Submitted by:  
Ohio Power Company

April 28, 2023

## Construction Notice for Adkins Station Expansion Project

### Construction Notice

#### Ohio Power Company Adkins Station Expansion Project

#### 4906-6-05

Ohio Power Company (the “Company”) provides the following information in accordance with the requirements of Ohio Administrative Code Section 4906-6-05.

#### 4906-6-05(B) General Information

##### B(1) Project Description

**The name of the project and applicant's reference number, names and reference number(s) of resulting circuits, a brief description of the project, and why the project meets the requirements for a Construction Notice.**

The Company proposes the Adkins Station Expansion Project (the “Project”), which is located in Darby Township, Pickaway County, Ohio. The Project involves expanding the existing Adkins Station by approximately 1.2-acre. The expansion is necessary to separate the Company’s assets from Darby Power LLC’s assets, and to provide enough space for a safe drive path around the station equipment, as well as, to accommodate a new driveway for the Company’s access to the station. No station equipment will be added, and no transmission line work is anticipated for the Project. In addition, all work will be completed within the Company’s parcel.

**Figures 1 and Figures 2**, included in **Appendix A**, show the location of the Project in relation to the surrounding vicinity.

The Project meets the requirements for a Construction Notice (CN) because it is within the types of projects defined by item 4(a) of Ohio Administrative Code Section 4906-1-01 Appendix A of the Application Requirement Matrix for Electric Power Transmission Lines:

- 4 *Construction additions to existing electric power transmission stations or converting distribution stations to transmission stations where:*
  - (a) *There is a twenty percent or less expansion of the fenced area*

The Project has been assigned PUCO Case No. 23-0042-EL-BNR.

##### B(2) Statement of Need

**If the proposed project is an electric power transmission line or gas or natural gas transmission line, a statement explaining the need for the proposed facility.**

Ohio Power Company has acquired full ownership of the Adkins 345 kV Station through the Cinergy, Columbus Southern Power, and Dayton Power & Light (“CCD”) partnership dissolution. The Company

## Construction Notice for Adkins Station Expansion Project

will need to expand the station yard to provide safe access to equipment in the station and to separate the Company's assets from those of Darby Power LLC's adjoining generating plant equipment on the site.

Failure to move forward with the proposed project expansion at Adkins Station poses potential safety issues for the Company, affects the Company's ability to adequately provide operation and maintenance activities and threatens the Company's ability to have full control of the through path from Beatty Road to Stuart Station. Since this project does not involve any topology changes, a PJM submittal is not required. The Project is listed in the Company's 2023 Long Term Forecast Report on page 114 (FE-T8, Existing Substations), see **Appendix B**.

### **B(3) Project Location**

**The applicant shall provide the location of the project in relation to existing or proposed lines and substations shown on an area system map of sufficient scale and size to show existing and proposed transmission facilities in the Project area.**

The location of the Project in relation to existing transmission lines and substations are shown on **Figure 1**.

### **B(4) Alternatives Considered**

**The applicant shall describe the alternatives considered and reasons why the proposed location or route is best suited for the proposed facility. The discussion shall include, but not be limited to, impacts associated with socioeconomic, ecological, construction, or engineering aspects of the project.**

The Project is located on property the Company has an easement on and is the most suitable location for the Project. Other alternatives would require impacting neighboring properties, as opposed to being located entirely on land the Company has an easement on. In addition, the proposed expansion of the substation eliminates the need for establishment of a new substation in another location as well as new transmission lines to tie-in a new substation to the transmission line grid. The establishment of a new substation would increase costs, impacts to other landowners, as well as increase impacts on ecological resources. The proposed expansion is located adjacent to the existing station and is situated on existing development land (i.e. gravel and/or maintained lawns), so impacts to agricultural and/or residential resources are not anticipated. Wetland and stream delineations were conducted on the Project site with identification of one wetland and one open-water, storm water retention pond. Of these delineated resources, none will be impacted by the Project. Expansion of the station in a different location would interfere with the existing Adkin Station generation facility and substation components or would impact the existing stormwater management control associated with the facility. Changes to the configuration of the generation facility, substation components, and stormwater management controls would result in greater impact to the adjacent property owners, land use, and potential to impact ecological resources. Therefore, the expansion of the substation on the west side of the existing Adkins Station represents the most suitable location and appropriate solution for meeting the Company's needs.

### **B(5) Public Information Program**

## Construction Notice for Adkins Station Expansion Project

**The applicant shall describe its public information program to inform affected property owners and tenants of the nature of the project and the proposed timeframe for project construction and restoration activities.**

The Company maintains a website (<http://aeptransmission.com/ohio/>) which provides the public access to an electronic copy of this CN and the public notice for this CN. An electronic copy of the CN will be served to the public library in each political subdivision affected by this proposed Project. The Company also retains ROW land agents that discuss Project timelines, construction and restoration activities and convey information to affected owners and tenants throughout the Project.

### **B(6) Construction Schedule**

**The applicant shall provide an anticipated construction schedule and proposed in-service date of the project.**

Construction of the Project is anticipated to begin in August 2023, and the anticipated in-service date is December 2023.

### **B(7) Area Map**

**The applicant shall provide a map of at least 1:24,000 scale clearly depicting the facility with clearly marked streets, roads, and highways, and an aerial image.**

**Figure 1** provides the proposed Project area and existing transmission facilities on a map of 1:24,000-scale (1-inch equals 2,000 feet), showing the Project on a topographic map of the Darby provided by the National Geographic Society, i-cubed. **Figure 2** shows the Project area on recent aerial photography, dated 2020, as provided by the Environmental Systems Research Institute (ESRI), at a scale of 1:2,400 (1-inch equals 200 feet).

To visit the Project site from Columbus, Ohio, take I-71 South toward Cincinnati for approximately 12 miles. Then, take Exit 94 for US-62/OH-3 toward Harrisburg. Continue on OH-3 South/US-62 West for 3 miles and then turn left onto Darby Creek Road. Continue on Darby Creek Road for 3 miles and then turn right onto Scioto-Darby Road and continue for approximately 1.5 miles. Then, turn left onto London Road and continue for 1.5 miles and then turn right onto Federal Road and continue for 1 mile. Turn left onto Drummond Road and then right onto Adkins Road. The approximate address of the Project site is 12509 Adkins Road, at latitude 39.71178°, longitude -83.17751°.

### **B(8) Property Agreements**

**The applicant shall provide a list of properties for which the applicant has obtained easements, options, and/or land use agreements necessary to construct and operate the**

## Construction Notice for Adkins Station Expansion Project

**facility and a list of the additional properties for which such agreements have not been obtained.**

All work activities are proposed on parcel (PIN# B06-0-001-00-200-00), which the Company currently has an easement on.

### **B(9) Technical Features**

**The applicant shall describe the following information regarding the technical features of the project:**

**B(9)(a) Operating characteristics, estimated number and types of structures required, and right-of-way and/or land requirements.**

The Company does not intend to install any new equipment within the proposed fence expansion area.

### **B(9)(b) Electric and Magnetic Fields**

**For electric power transmission lines that are within one hundred feet of an occupied residence or institution, the production of electric and magnetic fields during the operation of the proposed electric power transmission line.**

No occupied residences or institutions are located within 100 feet of the Project.

### **B(9)(c) Project Cost**

**The estimated capital cost of the project.**

The capital cost estimate for the proposed Project, which is comprised of applicable tangible and capital costs, is approximately \$9,715,000, using a Class 4 estimate. Pursuant to the PJM OATT, the costs for this Project will be recovered in the Ohio Power Company's FERC formula rate (Attachment H-14 to the PJM OATT) and allocated to the AEP Zone.

### **B(10) Social and Economic Impacts**

**The applicant shall describe the social and ecological impacts of the project:**

#### **B(10)(a) Land Use Characteristics**

**Provide a brief, general description of land use within the vicinity of the proposed project, including a list of municipalities, townships, and counties affected.**

An aerial photograph of the Project vicinity is provided as **Figure 2**. The Project location and vicinity have historically been primarily agricultural land. The Project is in Darby Township, Pickaway County. The Project vicinity is currently comprised of the existing Adkins Station facility, surrounded by agricultural land used for row crops, and lesser amounts of maintained lawn, old fields, open water, and palustrine emergent wetland. There are no parks, churches, cemeteries, wildlife management areas, or nature preserve lands within 1,000 feet of the Project.

## Construction Notice for Adkins Station Expansion Project

### **B(10)(b) Agricultural Land Information**

**Provide the acreage and a general description of all agricultural land, and separately all agricultural district land, existing at least sixty days prior to submission of the application within the potential disturbance area of the project.**

The Pickaway County Auditor provided a list of parcels registered as Agricultural District Land on April 26, 2023. As a result, the Project is not located within lands identified as Agricultural District Lands.

### **B(10)(c) Archaeological and Cultural Resources**

**Provide a description of the applicant’s investigation concerning the presence or absence of significant archaeological or cultural resources that may be located within the potential disturbance area of the project, a statement of the findings of the investigation, and a copy of any document produced as a result of the investigation.**

Phase I Archaeological investigations and separate History/Architecture Investigations for the Project occurred in August 2019. One previously recorded archaeological site and two historic properties were identified and found not to be eligible for listing on the National Register of Historic Places (NHRP). On September 15, 2022, the Ohio State Historic Preservation Office (“SHPO”) concurred with the recommendations and stated that the Project will have no effect on historic properties and no further investigations or consultation with SHPO is necessary. Coordination with SHPO is provided as **Appendix C**.

### **B(10)(d) Local, State, and Federal Agency Correspondence**

**Provide a list of the local, state, and federal governmental agencies known to have requirements that must be met in connection with the construction of the project, and a list of documents that have been or are being filed with those agencies in connection with siting and constructing the project.**

A Notice of Intent will be filed with the Ohio Environmental Protection Agency for authorization of construction storm water discharges under General Permit OHC000006. The Company will also coordinate storm water permitting needs with local government agencies, as necessary. The Company will implement and maintain best management practices as outlined in the Project-specific Storm Water Pollution Prevention Plan to minimize erosion and control sediment to protect surface water quality during storm events. A renewal of the OEPA General Permit Authorization for Stormwater Discharges Associated with Construction Activity Under the National Pollutant Discharge Elimination System is scheduled to occur in April 2023. As the NOI has been filed, a renewal will be submitted to the OEPA if the Project is not completed prior to the expiration of the renewal period (i.e., 180 days from date of renewal permit).

The Company’s consultant conducted a stream and wetland delineation within the Project study area. One wetland and one open-water storm water retention pond were identified within the Project study area. Additional details regarding the delineated feature are provided in Section (10) (f) below. No impacts are anticipated to the delineated resources. Therefore, a Pre-Construction Notification (PCN) under Nationwide Permit 57 to the USACE is not warranted, and the Project is compliant with non-reporting conditions of the Nationwide Permit 57 automatic Section 404/401 authorization.

## Construction Notice for Adkins Station Expansion Project

No FEMA regulated floodplains or floodways (based on FEMA map panel 39129C0150J) will be disturbed by the Project.

There are no other known local, state, or federal requirements that must be met prior to commencement of the proposed Project.

### **B(10)(e) Threatened, Endangered, and Rare Species**

**Provide a description of the applicant's investigation concerning the presence or absence of federal and state designated species (including endangered species, threatened species, rare species, species proposed for listing, species under review for listing, and species of special interest) that may be located within the potential disturbance area of the project, a statement of the findings of the investigation, and a copy of any document produced as a result of the investigation.**

On November 17, 2020, coordination letters were sent to United States Fish and Wildlife Service (USFWS) and the Ohio Department of Natural Resources (ODNR) Ohio Natural Heritage Program (ONHP) and Division of Wildlife (DOW), seeking an environmental review for the Project for potential impacts to threatened and endangered species.

Responses were received from the USFWS on November 17, 2020, and from the ODNR on January 11, 2021. According to a response letter received from the USFWS, due to the project, type, size, and location, adverse effects to federally endangered, threatened, or proposed species or proposed designated critical habitat is not anticipated. Regarding state threatened and endangered species that may occur within the Project vicinity, 40 species were listed by the ODNR. These species included: northern long-eared bat (*Myotis septentrionalis*), Indiana bat (*Myotis sodalis*), little brown bat (*Myotis lucifugus*), tricolored bat (*Perimyotis subflavus*), clubshell (*Pleurobema clava*), fanshell (*Cyprogenia stegaria*), northern riffleshell (*Epioblasma torulosa rangiana*), purple cat's paw (*Epioblasma o. obliquata*), rayed bean (*Villosa fabalis*), snuffbox (*Epioblasma triquetra*), rabbitsfoot (*Quadrula cylindrica cylindrica*), butterfly (*Ellipsaria lineolata*), ebonyshell (*Fusconaia ebenus*), elephant-ear (*Elliptio crassidens*), long-solid (*Fusconaia maculata maculata*), Ohio pigtoe (*Pleurobema cordatum*), pyramid pigtoe (*Pleurobema rubrum*), sharp-ridged pocketbook (*Lampsilis ovata*), washboard (*Megaloniais nervosa*), black sandshell (*Ligumia recta*), fawnsfoot (*Truncilla donaciformis*), pondhorn (*Unio merus tetralasmus*), threehorn wartyback (*Obliquaria reflexa*), Scioto madtom (*Noturus trautmani*), bigeye shiner (*Notropis boops*), goldeye (*Hiodon alosoides*), northern brook lamprey (*Ichthyomyzon fossor*), northern madtom (*Noturus stigmosus*), shortnose gar (*Lepisosteus platostomus*), spotted darter (*Etheostoma maculatum*), shovelnose sturgeon (*Scaphirhynchus platorynchus*), blue sucker (*Cycleptus elongatus*), lake chubsucker (*Erimyzon sucetta*), paddlefish (*Polyodon spathula*), Tippecanoe darter (*Etheostoma tippecanoe*), lark sparrow (*Chondestes grammacus*), least bittern (*Ixobrychus exilis*), northern harrier (*Circus hudsonis*), sandhill crane (*Grus canadensis*), and upland sandpiper (*Bartramia longicauda*). A species review for each of these species and potential impacts from the Project was evaluated and a summary provided below.

Presence of the Indiana bat has been established in the area, and the Division of Wildlife (DOW) recommends no summer tree cutting. However, limited summer tree cutting inside this buffer may be acceptable after further consultation with DOW. In addition, the entire state of Ohio is within the range of the northern long-eared bat, little brown bat, and tricolored bat. The DOW recommends tree cutting only



## Construction Notice for Adkins Station Expansion Project

occur from October 1 through March 31, conserving trees with loose shaggy bark and/or crevices, holes, or cavities, as well as trees with DBH  $\geq 20$ " if possible. Furthermore, the Company's consultant completed a desktop review for potential hibernaculum within 0.25 miles of the Project area and no caves, mines, and/or karst features were identified. Based on general observations during the ecological survey, the Project area is situated within an active disturbance/cleared area and no tree clearing is proposed for the Project. Therefore, potential hibernaculum or suitable foraging and roosting habitat for the Indiana bat, northern long-eared bat, little brown bat, and tricolored bat was not identified within the Project area. Therefore, no further coordination was necessary with either the ODNR and/or USFWS regarding the listed bat species. Results of the initial desktop habitat assessment has been included within **Appendix C**.

No impacts are anticipated to the clubshell, fanshell, northern riffleshell, purple cat's paw, rayed bean, Snuffbox, rabbitsfoot, butterfly, ebonyshell, elephant-ear, long-solid, Ohio pigtoe, pyramid pigtoe, sharp-ridged pocketbook, washboard, black sandshell, fawnsfoot, pondhorn, threehorn wartyback, Scioto madtom, bigeye shiner, goldeye, northern brook lamprey, northern madtom, shortnose gar, spotted darter, shovelnose sturgeon, blue sucker, lake chubsucker, paddlefish, and Tippecanoe darter as no in-water work is anticipated, and no streams were identified within the Project area.

Additionally, field surveys indicated the absence of potential nesting habitat suitable for lark sparrow, least bittern, northern harrier, sandhill crane, and upland sandpiper within the Project area. The area of the proposed expansion is associated with existing gravel and/or maintained lawn that is not suitable for the listed bird species. Therefore, and as per ODNR guidance provided in **Appendix C**, these species are not likely to be impacted by the Project if their habitat will not be impacted. Therefore, no further coordination regarding the listed bird species was warranted regarding this Project.

A copy of the agency correspondence is provided in **Appendix C**. Additional information regarding habitat assessments within the Project area is provide within the Ecological Report found in **Appendix D**.

### **B(10)(f) Areas of Ecological Concern**

**Provide a description of the applicant's investigation concerning the presence or absence of areas of ecological concern (including national and state forests and parks, floodplains, wetlands, designated or proposed wilderness areas, national and state wild and scenic rivers, wildlife areas, wildlife refuges, wildlife management areas, and wildlife sanctuaries) that may be located within the potential disturbance area of the project, a statement of the findings of the investigation, and a copy of any document produced as a result of the investigation.**

No unique ecological sites, geologic features, animal assemblages, scenic rivers, state wildlife areas, state nature preserves, state or national parks, state or national forests, or other protected natural areas were identified within the Project Area.

FEMA Flood Insurance Rate Maps were consulted to identify any floodplains/flood hazard areas that have been mapped in the Project Area (specifically, map number **39129C0150J**). Based on these maps, no mapped FEMA floodplains are located in the Project area.



## **Construction Notice for Adkins Station Expansion Project**

The Company's consultant prepared an Ecological Report, which is provided in **Appendix D**. The survey of the Project area identified one palustrine emergent (PEM) wetland and one open water, storm water retention pond. The Company does not anticipate any crossings of the delineated resources for construction of the Project.





### **B(10)(g) Unusual Conditions**

**Provide any known additional information that will describe any unusual conditions resulting in significant environmental, social, health, or safety impacts.**

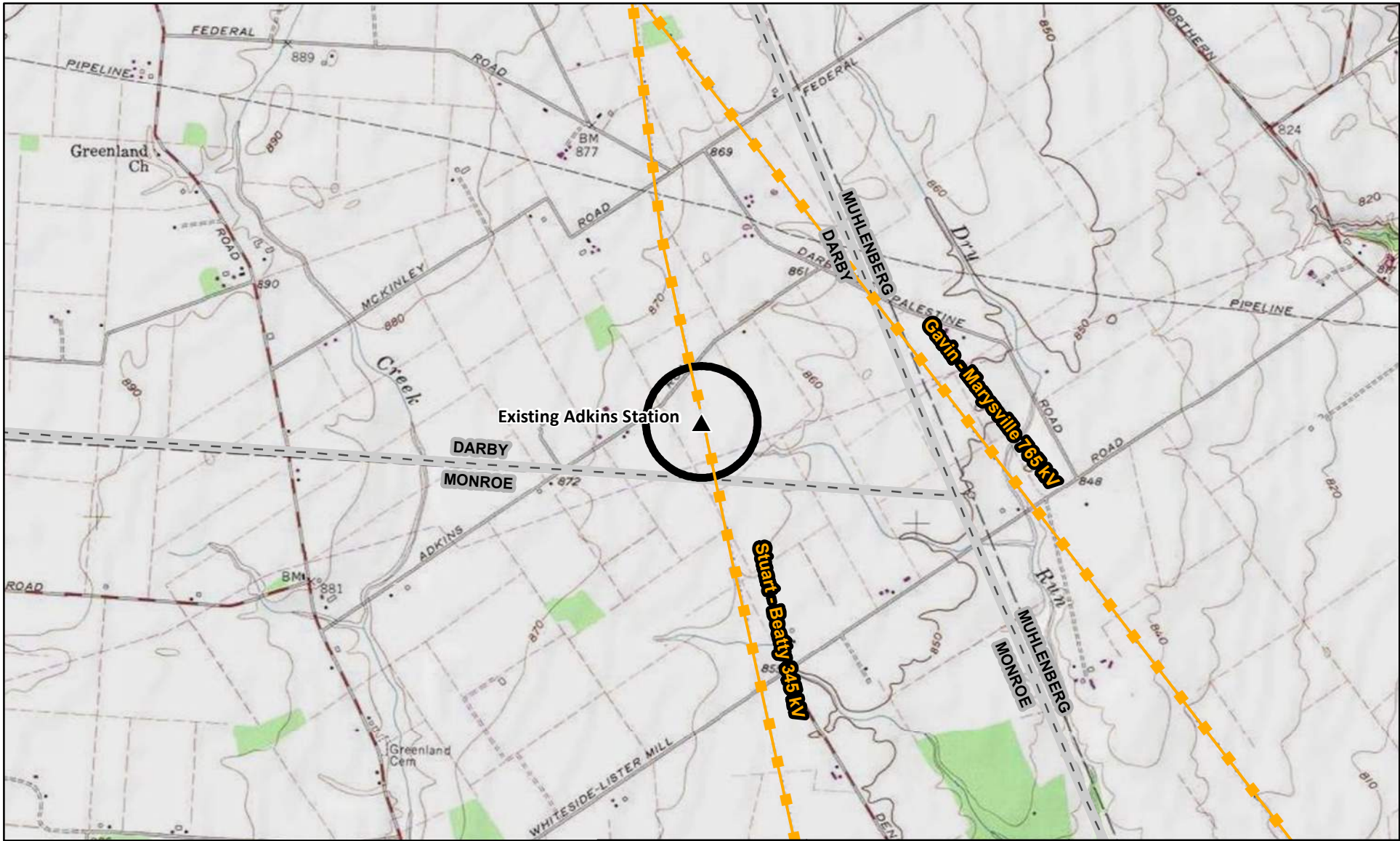
To the best of the Company's knowledge, no unusual conditions exist that would result in significant environmental, social, health, or safety impacts.

# Appendix A Project Figures



-  Station
-  Project Area
- Existing Transmission Lines**
-  345 kV
-  Township Boundary

Data Sources: AEP (2021), ESRI (2013), PowerMap (2010), National Geographic Society, i-cubed USGS 7.5 Topographic Quadrangle (Five Points)

Coordinate System:  
State Plane Ohio North  
NAD 83



March 16, 2023



**FIGURE 1  
TOPOGRAPHIC OVERVIEW**



Construction Notice  
Adkins Station  
Expansion Project

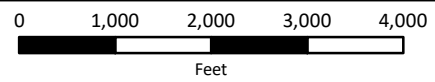



- Proposed Adkins Station Fence Line Extension
- Existing Adkins Station Fence Line
- Existing Transmission Lines**
- - - 345 kV
- Parcel Boundary

Data Sources: AEP (2021),  
ESRI (2013), USGS (2018),  
PowerMap (2010)

Coordinate System:  
State Plane Ohio South  
NAD 83



March 16, 2023



**FIGURE 2  
AERIAL MAP**



Construction Notice  
Adkins Station  
Expansion Project

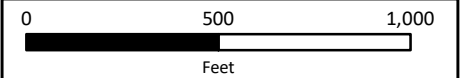

# Appendix B Long Term Forecast Report



PUCO Form FE-T8: Ohio Power Company  
Summary of Existing Substations on Transmission Lines

| Substation Name | Type Distribution (D) Transmission (T) | Voltage(s) (kV) | Line Association (FE3-T7 or FE3-T9 Notation) | Line Existing or Proposed |
|-----------------|--|-----------------|--|---------------------------|
| ACADEMIA        | T                                      | 138             | Academia - North Lexington                   | E                         |
| ACADEMIA        | T                                      | 138             | Academia - Ohio Central                      | E                         |
| ACADEMIA        | T                                      | 138             | Academia - West Mount Vernon                 | E                         |
| ADAMS (CSP)     | T                                      | 138             | Adams - Seaman                               | E                         |
| ADAMS (CSP)     | T                                      | 138             | Adams - Ware Road                            | E                         |
| ADDISON         | T                                      | 138             | Addison - Lick - Sporn                       | E                         |
| ADKINS          | T                                      | 345             | * Adkins - Atlanta (DPL)                     | E                         |
| ADKINS          | T                                      | 345             | Adkins - Beatty Road                         | E                         |
| ADKINS          | T                                      | 345             | Adkins - Darby Generation                    | E                         |
| AMLIN           | D                                      | 138             | Amlin - Dublin                               | E                         |
| AMLIN           | D                                      | 138             | Amlin - Hayden                               | E                         |
| AMLIN           | D                                      | 138             | Amlin - Hyatt                                | E                         |
| AMLIN           | D                                      | 138             | Amlin - Sumac #2                             | E                         |
| AMLIN           | D                                      | 138             | Amlin - Sumac #1                             | E                         |
| APPLE CREEK     | D                                      | 138             | East Wooster - South Canton                  | E                         |
| ASTOR           | D                                      | 138             | Astor - East Broad Street                    | E                         |
| BEATTY ROAD     | T                                      | 345             | Adkins - Beatty Road                         | E                         |
| BEATTY ROAD     | T                                      | 138             | Beatty - Bolton                              | E                         |
| BEATTY ROAD     | T                                      | 345             | Beatty - Cole                                | E                         |
| BEATTY ROAD     | T                                      | 345             | Beatty Road - Bixby                          | E                         |
| BEATTY ROAD     | T                                      | 345             | Beatty Road - Greene                         | E                         |
| BEATTY ROAD     | T                                      | 138             | Beatty Road - McComb                         | E                         |
| BEATTY ROAD     | T                                      | 138             | Beatty Road - White Road                     | E                         |
| BEATTY ROAD     | T                                      | 138             | Beatty Road - Wilson                         | E                         |
| BEATTY ROAD     | T                                      | 138             | Beatty Road - Zuber                          | E                         |
| BELDEN VILLAGE  | D                                      | 138             | Wagenhals - Wayview                          | E                         |
| BELPRE          | D                                      | 138             | *Belpre - Parkersburg (APS)                  | E                         |

## **Appendix C Agency Correspondence**



# United States Department of the Interior

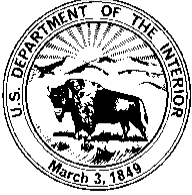

## FISH AND WILDLIFE SERVICE

Ecological Services  
4625 Morse Road, Suite 104  
Columbus, Ohio 43230  
(614) 416-8993 / FAX (614) 416-8994

November 17, 2020

Ms. Carter  
Stantec Consulting Services Inc.  
1500 Lake Shore Drive, Suite 100  
Columbus, OH 43204-3800

TAILS# 03E15000-2021-TA-0326

Re: Adkins Station Expansion Project, Pickaway County, Ohio

Dear Ms. Carter,

We have received your recent correspondence requesting information about the subject proposal. There are no Federal wilderness areas, wildlife refuges or designated critical habitat within the vicinity of the project area.

**FEDERALLY LISTED, PROPOSED, AND CANDIDATE SPECIES COMMENTS:** Due to the project, type, size, and location, we do not anticipate adverse effects to federally endangered, threatened, proposed, or candidate species. Should the project design change, or during the term of this action, additional information on listed or proposed species or their critical habitat become available, or if new information reveals effects of the action that were not previously considered, consultation with the U.S. Fish and Wildlife Service should be initiated to assess any potential impacts.

If you have questions, or if we can be of further assistance in this matter, please contact our office at (614) 416-8993 or [ohio@fws.gov](mailto:ohio@fws.gov).

Sincerely,

Patrice Ashfield  
Field Office Supervisor



# Ohio Department of Natural Resources

MIKE DEWINE, GOVERNOR

MARY MERTZ, DIRECTOR

## Office of Real Estate

*John Kessler, Chief*

2045 Morse Road – Bldg. E-2

Columbus, OH 43229

Phone: (614) 265-6621

Fax: (614) 267-4764

January 11, 2021

Kim Carter  
Stantec  
1500 Lake Shore Drive Suite 100  
Columbus OH 43204-3800

**Re:** 20-1079; Adkins Station Expansion Project

**Project:** The proposed project involves expansion of the existing Adkins Substation.

**Location:** The proposed project is located in Darby Township, Pickaway County, Ohio.

The Ohio Department of Natural Resources (ODNR) has completed a review of the above referenced project. These comments were generated by an inter-disciplinary review within the Department. These comments have been prepared under the authority of the Fish and Wildlife Coordination Act (48 Stat. 401, as amended; 16 U.S.C. 661 et seq.), the National Environmental Policy Act, the Coastal Zone Management Act, Ohio Revised Code and other applicable laws and regulations. These comments are also based on ODNR's experience as the state natural resource management agency and do not supersede or replace the regulatory authority of any local, state or federal agency nor relieve the applicant of the obligation to comply with any local, state or federal laws or regulations.

**Natural Heritage Database:** The Natural Heritage Database has no records at or within a one-mile radius of the project area.

A review of the Ohio Natural Heritage Database indicates there are no other records of state endangered or threatened plants or animals within the project area. There are also no records of state potentially threatened plants, special interest or species of concern animals, or any federally listed species. In addition, we are unaware of any unique ecological sites, geologic features, animal assemblages, scenic rivers, state wildlife areas, state nature preserves, state or national parks, state or national forests, national wildlife refuges, or other protected natural areas within the project area. The review was performed on the project area you specified in your request as well as an additional one-mile radius. Records searched date from 1980.

Please note that Ohio has not been completely surveyed and we rely on receiving information from many sources. Therefore, a lack of records for any particular area is not a statement that rare species or unique features are absent from that area. Although all types of plant communities have been surveyed, we only maintain records on the highest quality areas.

**Fish and Wildlife:** The Division of Wildlife (DOW) has the following comments.

The DOW recommends that impacts to streams, wetlands and other water resources be avoided and minimized to the fullest extent possible, and that best management practices be utilized to minimize erosion and sedimentation.

The project is within the vicinity of records for the Indiana bat (*Myotis sodalis*), a state endangered and federally endangered species. Because presence of state endangered bat species has been established in the area, summer tree cutting is not recommended, and additional summer surveys would not constitute presence/absence in the area. However, limited summer tree cutting inside this buffer may be acceptable after further consultation with DOW (contact Sarah Stankavich, [sarah.stankavich@dnr.state.oh.us](mailto:sarah.stankavich@dnr.state.oh.us)).

In addition, the entire state of Ohio is within the range of the Indiana bat (*Myotis sodalis*), a state endangered and federally endangered species, the northern long-eared bat (*Myotis septentrionalis*), a state endangered and federally threatened species, the little brown bat (*Myotis lucifugus*), a state endangered species, and the tricolored bat (*Perimyotis subflavus*), a state endangered species. During the spring and summer (April 1 through September 30), these bat species predominately roost in trees behind loose, exfoliating bark, in crevices and cavities, or in the leaves. However, these species are also dependent on the forest structure surrounding roost trees. The DOW recommends tree cutting only occur from October 1 through March 31, conserving trees with loose, shaggy bark and/or crevices, holes, or cavities, as well as trees with DBH  $\geq$  20 if possible.

The DOW also recommends that a desktop habitat assessment, followed by a field assessment if needed, is conducted to determine if there are potential hibernaculum(a) present within the project area. Information about how to conduct habitat assessments can be found in the current USFWS “Range-wide Indiana Bat Survey Guidelines.” If a habitat assessment finds that potential hibernacula are present within 0.25 miles of the project area, please send this information to Sarah Stankavich, [sarah.stankavich@dnr.state.oh.us](mailto:sarah.stankavich@dnr.state.oh.us) for project recommendations. If a potential or known hibernaculum is found, the DOW recommends a 0.25-mile tree cutting and subsurface disturbance buffer around the hibernaculum entrance, however, limited summer or winter tree cutting may be acceptable after consultation with DOW. If no tree cutting or subsurface impacts to a hibernaculum are proposed, this project is not likely to impact these species.

The project is within the range of the following listed mussel species:

Federally Endangered

clubshell (*Pleurobema clava*)  
fanshell (*Cyprogenia stegaria*)  
northern riffleshell (*Epioblasma torulosa rangiana*)  
purple cat’s paw (*Epioblasma o. obliquata*)  
rayed bean (*Villosa fabalis*)  
snuffbox (*Epioblasma triquetra*)

Federally Threatened

rabbitsfoot (*Quadrula cylindrica cylindrica*)

State Endangered

butterfly (*Ellipsaria lineolata*)  
ebonyshell (*Fusconaia ebenus*)  
elephant-ear (*Elliptio crassidens*)  
long-solid (*Fusconaia maculata maculata*)

Ohio pigtoe (*Pleurobema cordatum*)  
pyramid pigtoe (*Pleurobema rubrum*)  
sharp-ridged pocketbook (*Lampsilis ovata*)  
washboard (*Megaloniaias nervosa*)

State Threatened

black sandshell (*Ligumia recta*)  
fawnsfoot (*Truncilla donaciformis*)  
pondhorn (*Unio merus tetralasmus*)  
threehorn wartyback (*Obliquaria reflexa*)

Due to the location, and that there is no in-water work proposed in a perennial stream of sufficient size, this project is not likely to impact these species.

The project is within the range of the following listed fish species:

Federally Endangered

Scioto madtom (*Noturus trautmani*)

State Endangered

bigeye shiner (*Notropis boops*)  
goldeye (*Hiodon alosoides*)  
northern brook lamprey (*Ichthyomyzon fossor*)  
northern madtom (*Noturus stigmosus*)  
shortnose gar (*Lepisosteus platostomus*)  
spotted darter (*Etheostoma maculatum*)  
shovelnose sturgeon (*Scaphirhynchus platyrhynchus*)

State Threatened

blue sucker (*Cycleptus elongatus*)  
lake chubsucker (*Erimyzon sucetta*)  
paddlefish (*Polyodon spathula*)  
Tippecanoe darter (*Etheostoma tippecanoe*)

The DOW recommends no in-water work in perennial streams from April 15 through June 30 to reduce impacts to indigenous aquatic species and their habitat. If no in-water work is proposed in a perennial stream, this project is not likely to impact these or other aquatic species.

The project is within the range of the lark sparrow (*Chondestes grammacus*), a state endangered bird. This sparrow nests in grassland habitats with scattered shrub layers, disturbed open areas, as well as patches of bare soil. In the Oak Openings area west of Toledo, lark sparrows occupy open grass and shrubby fields along sandy beach ridges. These summer residents normally migrate out of Ohio shortly after their young fledge or leave the nest. If this type of habitat will be impacted, construction should be avoided in this habitat during the species' nesting period of May 1 to June 30. If this habitat will not be impacted, this project is not likely to impact this species.

The project is within the range of the least bittern (*Ixobrychus exilis*), a state threatened bird. This secretive marsh species prefers dense emergent wetlands with thick stands of cattails, sedges, sawgrass or other semiaquatic vegetation interspersed with woody vegetation and open water. If this type of habitat will be impacted, construction should be avoided in this habitat during the species' nesting period of May 1 to July 31. If this type of habitat will not be impacted, this project is not likely to impact this species.

The project is within the range of the northern harrier (*Circus hudsonis*), a state endangered bird. This is a common migrant and winter species. Nesters are much rarer, although they occasionally breed in large marshes and grasslands. Harriers often nest in loose colonies. The female builds a nest out of sticks on the ground, often on top of a mound. Harriers hunt over grasslands. If this type of habitat will be impacted, construction should be avoided in this habitat during the species' nesting period of May 15 to August 1. If this habitat will not be impacted, this project is not likely to impact this species.

The project is within the range of the sandhill crane (*Grus canadensis*), a state threatened species. Sandhill cranes are primarily a wetland-dependent species. On their wintering grounds, they will utilize agricultural fields; however, they roost in shallow, standing water or moist bottomlands. On breeding grounds, they require a rather large tract of wet meadow, shallow marsh, or bog for nesting. If grassland, prairie, or wetland habitat will be impacted, construction should be avoided in this habitat during the species' nesting period of April 1 to September 1. If this habitat will not be impacted, this project is not likely to have an impact on this species.

The project is within the range of the upland sandpiper (*Bartramia longicauda*), a state endangered bird. Nesting upland sandpipers utilize dry grasslands including native grasslands, seeded grasslands, grazed and ungrazed pasture, hayfields, and grasslands established through the Conservation Reserve Program (CRP). If this type of habitat will be impacted, construction should be avoided in this habitat during the species' nesting period of April 15 to July 31. If this type of habitat will not be impacted, this project is not likely to impact this species.

Due to the potential of impacts to federally listed species, as well as to state listed species, we recommend that this project be coordinated with the U.S. Fish & Wildlife Service.

**Water Resources:** The Division of Water Resources has the following comment.

The local floodplain administrator should be contacted concerning the possible need for any floodplain permits or approvals for this project. Your local floodplain administrator contact information can be found at the website below.

[http://water.ohiodnr.gov/portals/soilwater/pdf/floodplain/Floodplain%20Manager%20Community%20Contact%20List\\_8\\_16.pdf](http://water.ohiodnr.gov/portals/soilwater/pdf/floodplain/Floodplain%20Manager%20Community%20Contact%20List_8_16.pdf)

ODNR appreciates the opportunity to provide these comments. Please contact Sarah Tebbe, Environmental Specialist, at [Sarah.Tebbe@dnr.ohio.gov](mailto:Sarah.Tebbe@dnr.ohio.gov) if you have questions about these comments or need additional information.

Mike Pettegrew  
Environmental Services Administrator (Acting)



In reply, refer to  
2019-PIC-45882

September 15, 2022

Mr. Ryan J. Weller  
Weller & Associates, Inc.  
1395 West Fifth Avenue  
Columbus, Ohio 43212

**RE: Adkins Station Expansion Project, Darby Township, Pickaway County, Ohio**

Dear Mr. Weller:

This letter is in response to the correspondence received on August 26, 2022 regarding the proposed Adkins Station Expansion Project, Darby Township, Pickaway County, Ohio. We appreciate the opportunity to comment on this project. The comments of the Ohio State Historic Preservation Office (SHPO) are made pursuant to Section 149.53 of the Ohio Revised Code and the Ohio Power Siting Board rules for siting this project (OAC 4906-5). The comments of the Ohio SHPO are also submitted in accordance with the provisions of Section 106 of the National Historic Preservation Act of 1966, as amended (54 U.S.C. 306108 [36 CFR 800]).

Our office previously reviewed the *Phase I Archaeological Investigations for the 18.3 ha (45.3 ac) Adkins Station Expansion Project in Darby Township, Pickaway County, Ohio* by Ryan J. Weller (Weller & Associates, Inc. 2019) and *History/Architecture Investigations for the 18.3 ha (45.3 ac) Adkins Station Expansion Project in Darby Township, Pickaway County, Ohio* by Austin White (Weller & Associates, Inc. 2019). One (1) archaeological site, Ohio Archaeological Inventory (OAI) #33PI0650 was identified and found to be not eligible for listing on the National Register of Historic Places (NRHP). Two (2) properties fifty years of age or older were also identified with the Area of Potential Effects (APE) and were determined not eligible for listing in the NRHP. During this review, it was determined the project as proposed will have no effect on historic properties.

Our office continues to agree that the project as proposed will have no effect on historic properties. No further coordination with this office is necessary, unless the project changes or unless new or additional historic properties are discovered during implementation of this project. In such a situation, this office should be contacted. If you have any questions, please contact me at (614) 298-2022, or by e-mail at [khorrocks@ohiohistory.org](mailto:khorrocks@ohiohistory.org). Thank you for your cooperation.

Sincerely,

A handwritten signature in blue ink, appearing to read "Krista Horrocks".

Krista Horrocks, Project Reviews Manager  
Resource Protection and Review

RPR Serial No: 1094808-1094809

# Appendix D Ecological Resources Inventory Report





**Adkins Station Expansion Project,  
Pickaway County, Ohio**

**Ecological Resources Inventory  
Report**

Prepared for:

AEP Ohio Transmission Company, Inc.  
8600 Smiths Mill Road  
New Albany, OH 43054

Prepared by:

Stantec Consulting Services Inc.  
1500 Lake Shore Drive, Suite 100  
Columbus, OH 43204

January 29, 2021

# Sign-off Sheet

This document entitled Adkins Station Expansion Project, Pickaway County, Ohio was prepared by Stantec Consulting Services Inc. ("Stantec") for the account of AEP Ohio Transmission Company, Inc. (the "Client"). Any reliance on this document by any third party is strictly prohibited. The material in it reflects Stantec's professional judgment in light of the scope, schedule and other limitations stated in the document and in the contract between Stantec and the Client. The opinions in the document are based on conditions and information existing at the time the document was published and do not take into account any subsequent changes. In preparing the document, Stantec did not verify information supplied to it by others. Any use which a third party makes of this document is the responsibility of such third party. Such third party agrees that Stantec shall not be responsible for costs or damages of any kind, if any, suffered by it or any other third party as a result of decisions made or actions taken based on this document.

Prepared by 

(signature)

**Charlie Allen**

Reviewed by 

(signature)

**Jayme Huston**

Reviewed by 

(signature)

**Matt Teitt**

## Table of Contents

|            |   |           |
|------------|---|-----------|
| <b>1.0</b> | <b>INTRODUCTION</b> .....                             | <b>1</b>  |
| <b>2.0</b> | <b>METHODS</b> .....                                  | <b>2</b>  |
| 2.1        | WETLAND DELINEATION .....                             | 2         |
| 2.2        | STREAM DELINEATION.....                               | 2         |
| 2.3        | RARE SPECIES.....                                     | 2         |
| <b>3.0</b> | <b>RESULTS</b> .....                                  | <b>3</b>  |
| 3.1        | TERRESTRIAL HABITAT.....                              | 3         |
| 3.2        | WETLANDS .....  | 4         |
| 3.3        | WATERBODIES.....                                      | 7         |
| 3.4        | OPEN WATERS.....                                      | 7         |
| 3.5        | RARE, THREATENED, OR ENDANGERED SPECIES HABITAT ..... | 8         |
| <b>4.0</b> | <b>CONCLUSIONS AND RECOMMENDATIONS</b> .....          | <b>17</b> |
| <b>5.0</b> | <b>REFERENCES</b> .....                               | <b>20</b> |

### LIST OF TABLES

|          |  |   |
|----------|--|---|
| Table 1. | Vegetation Communities and Land Cover Found within the Adkins Station Expansion Project Area, Pickaway County, Ohio.....           | 3 |
| Table 2. | Summary of Wetland Resources Found within the Adkins Station Expansion Project Area, Pickaway County, Ohio.....                    | 6 |
| Table 3. | Summary of Open Water Resources Found within the Adkins Station Expansion Project, Pickaway County, Ohio.....                      | 7 |
| Table 4. | Summary of Potential Federal and State-Listed Species within the Adkins Station Expansion Project Area, Pickaway County, Ohio..... | 8 |

### LIST OF APPENDICES

|                   |   |            |
|-------------------|---|------------|
| <b>APPENDIX A</b> | <b>IMPACT TABLES</b> .....                            | <b>A.1</b> |
| A.1               | Wetland Impact table .....                            | A.1        |
| <b>APPENDIX B</b> | <b>FIGURES</b> .....                                  | <b>B.1</b> |
| B.1               | Figure 1 – Project Location Map.....                  | B.1        |
| B.2               | Figure 2 – Wetland and Waterbody Delineation Map..... | B.2        |
| B.3               | Figure 3 – Habitat Assessment Map.....                | B.3        |
| <b>APPENDIX C</b> | <b>DATA FORM</b> .....                                | <b>C.1</b> |
| C.1               | Wetland Determination Data Forms.....                 | C.1        |
| C.2               | ORAM Data Forms.....                                  | C.2        |
| <b>APPENDIX D</b> | <b>REPRESENTATIVE PHOTOGRAPHS</b> .....               | <b>D.1</b> |
| D.1               | Wetland and Waterbody Photographs .....               | D.1        |

**ADKINS STATION EXPANSION PROJECT, PICKAWAY COUNTY, OHIO**

D.2 Habitat Photographs..... D.2

**APPENDIX E AGENCY CORRESPONDENCE ..... E.1**

## ADKINS STATION EXPANSION PROJECT, PICKAWAY COUNTY, OHIO

Introduction  
January 28, 2021

### 1.0 INTRODUCTION

AEP Ohio Transmission Company, Inc. (AEP) is proposing to expand the existing Adkins station to separate the 345 kV yard from the generator equipment and expand the existing fenced area for an additional access drive in Pickaway County, Ohio (Figure 1, Appendix B). The Adkins Station Expansion Project (the Project) area includes the existing station pad and adjacent areas where the expansion work may occur. The Project is located to the east of the town of Mount Sterling and approximately 0.5 mile west of the intersection of Adkins Road and Drummond Road (Figure 1, Appendix B). A study area for the station expansion and proposed access road was surveyed for wetlands, waterbodies, open water features, upland drainage features, and potential threatened, endangered, and rare species habitat by Stantec Consulting Services Inc. (Stantec) biologists on November 18, 2020. The approximate locations of features located up to 50 feet outside of the Project area were also recorded during the field surveys, where landowner access was permitted. However, no data forms were collected on features that did not extend into the Project area. These features are shown on the Figure 2 maps in Appendix B as “approximate” wetlands, streams (waterways), open waters, and upland drainage features.

## 2.0 METHODS

### 2.1 WETLAND DELINEATION

Prior to completing the field surveys, a desktop review of the Project area was conducted using U.S. Geological Survey (USGS) topographic maps, National Wetlands Inventory (NWI) maps, U.S. Department of Agriculture (USDA) Natural Resources Conservation Service (NRCS) soil survey data, and aerial imagery mapping. Stantec completed a wetland delineation study in accordance with the *Corps of Engineers Wetlands Delineation Manual* (USACE Environmental Laboratory 1987) and the *Regional Supplement to the Corps of Engineers Wetland Delineation Manual: Midwest Region* (Version 2.0; USACE 2010). Wetland categories were classified using the Ohio Rapid Assessment Method (ORAM) for Wetlands Version 5.0 (Mack 2001).

### 2.2 STREAM DELINEATION

Streams that demonstrated a continuously defined channel (bed and bank), ordinary high water mark (OHWM), and the disturbance of terrestrial vegetation were delineated within the Project area, per the protocols outlined in the USACE's *Guidance on Ordinary High Water Mark Identification* (Regulatory Guidance Letter, No. 05-05; USACE 2005). Delineated streams were classified as ephemeral, intermittent, or perennial per definitions in the 22250 Federal Register/Vol. 85, No. 77 (effective June 22, 2020; USACE 2020). Functional assessment of streams within the Project area was based on completion of the Ohio Environmental Protection Agency's (OEPA) *Headwater Habitat Evaluation Index* (HHEI; OEPA 2018) and/or *Qualitative Habitat Evaluation Index* (QHEI; OEPA 2006). The centerline and/or the OHWM locations of each waterway were identified and surveyed using a handheld sub-meter accuracy global positioning system (GPS) unit and mapped with GIS software. Additionally, the locations of upland drainage features (which lacked a continuously defined bed and bank/OHWM) identified within the Project area were also recorded with a sub-meter accuracy GPS unit during the field surveys.

### 2.3 RARE SPECIES

Prior to conducting the field surveys, Stantec contacted the Ohio Department of Natural Resources (ODNR) and the U.S. Fish and Wildlife Service (USFWS) for information regarding rare, threatened, or endangered species and their habitats of concern within the vicinity of the Project area (Appendix E – Agency Correspondence). To assess potential impacts to rare, threatened, or endangered species, Stantec scientists conducted a pedestrian reconnaissance of the Project area, collected information on existing habitats within the Project area, and assessed the potential for these habitats to be used by these species.

Results  
January 28, 2021

### 3.0 RESULTS

#### 3.1 TERRESTRIAL HABITAT

Stantec completed field surveys within the Project area on November 18, 2020, for potentially suitable habitats for threatened and endangered species. Figure 3 (Appendix B) shows the land cover, vegetation communities, and any identified rare, threatened, or endangered species habitats observed within the Project area during the habitat assessment surveys. Representative photographs of the vegetation communities/habitats identified within the Project area are included in Appendix D of this report (photo locations are shown on Figure 3 in Appendix B). Information regarding the vegetation communities/habitats identified within the Project area is provided in Table 1.

**Table 1. Vegetation Communities and Land Cover Found within the Adkins Station Expansion Project Area, Pickaway County, Ohio**

| Vegetation Communities and Land Cover Types within the Project Area | Degree of Human-Related Ecological Disturbance  | Unique, Rare, or High Quality? | Approximate Acreage Within Project Area |
|---|---|--------------------------------|---|
| Palustrine Emergent Wetland   | Moderate Disturbance/Natural Community (dominated by native and herbaceous species and/or opportunistic invaders). Dominant species included narrow-leaf cattail ( <i>Typha angustifolia</i> ).   | No                             | 0.02                                    |
| Open Water  | Moderate Disturbance/Natural Community (dominated by native and herbaceous species and/or opportunistic invaders). Dominant species included narrow-leaf cattail.   | No                             | 0.83                                    |
| Old Field   | Extreme Disturbance/Ruderal Community (dominated by opportunistic invaders, planted non-native species, and/or native highly tolerant taxa). Dominant plant species included Canada goldenrod ( <i>Solidago canadensis</i> ), Yellow foxtail ( <i>Setaria pumila</i> ), Indian grass ( <i>Sorghastrum nutans</i> ), big bluestem ( <i>Andropogon gerardii</i> ), Fuller's teasel ( <i>Dipsacus fullonum</i> ), and Bradford pear ( <i>Pyrus calleryana</i> ). | No                             | 10.40                                   |



## ADKINS STATION EXPANSION PROJECT, PICKAWAY COUNTY, OHIO

Results

January 28, 2021

| Vegetation Communities and Land Cover Types within the Project Area | Degree of Human-Related Ecological Disturbance  | Unique, Rare, or High Quality? | Approximate Acreage Within Project Area |
|---|---|--------------------------------|---|
| Agricultural Field  | Extreme Disturbance/Ruderal Community (dominated by opportunistic invaders, planted non-native species, and/or native highly tolerant taxa). Tilled soil was present during the site visit.   | No                             | 25.78                                   |
| Maintained Lawn   | Extreme Disturbance/Ruderal Community (dominated by opportunistic invaders, planted non-native species, and/or native highly tolerant taxa). Dominant species included Kentucky bluegrass ( <i>Poa pratensis</i> ), great plantain ( <i>Plantago major</i> ), common dandelion ( <i>Taraxacum officinale</i> ) and Queen Ann's Lace ( <i>Daucus carota</i> ). | No                             | 7.07                                    |
| Industrial/Commercial Land  | Moderate to Extreme Disturbance/Ruderal Community (free of vegetation and/or dominated by opportunistic invaders, planted non-native species, and native highly tolerant taxa).   | No                             | 21.38                                   |
| <b>TOTAL</b>  |   |                                | <b>65.48</b>                            |

### 3.2 WETLANDS

Stantec completed field surveys for wetlands within the Project area on November 18, 2020. Stantec identified one wetland, Wetland 1, within the Project area in the location of wetland determination sample point SP02. Wetland 1 is considered to be potentially isolated due to its lack of hydrological connection to any jurisdictional "waters of the United States". The National Hydrological Database (NHD) depicts an intermittent stream, within the Project area as shown on Figure 2 (Appendix B). However, no stream was observed within the Project area or surrounding area during the field surveys. Therefore, Wetland 1 has no hydrological connection to any jurisdictional "waters of the United States" and is therefore considered to be potentially isolated.

Two wetland determination sample points (SP01 and SP04) were evaluated during the field surveys due to the presence of hydrophytic vegetation, hydric soils, and hydrology. The wetland determination sample points were located within constructed upland drainage features for the existing station. Although SP01 and SP04 met wetland determination criteria, per definitions in the 22250 Federal Register/Vol. 85, No. 77 (effective June 22, 2020; USACE 2020) paragraph (b)(10) stormwater control features are excluded from the "waters of the United States." The upland drainage features were constructed wholly in uplands for the purpose of conveying stormwater

## **ADKINS STATION EXPANSION PROJECT, PICKAWAY COUNTY, OHIO**

Results

January 28, 2021

runoff. Therefore, sample points SP01 and SP04 were not delineated as wetlands. Figure 2 (Appendix B) shows the location of the wetland determination sample points identified by Stantec within the Project area. Representative photographs are included in Appendix D of this report (photo locations are shown on Figure 2, Appendix B). Completed wetland determination and ORAM data forms are included in Appendix C. Information regarding the Cowardin classification and ORAM categories of the wetland is provided in Table 2 and included in Appendix A.

**ADKINS STATION EXPANSION PROJECT, PICKAWAY COUNTY, OHIO**

Results  
January 28, 2021

**Table 2. Summary of Wetland Resources Found within the Adkins Station Expansion Project Area, Pickaway County, Ohio**

| Wetland ID  | Location  |            | Isolated? | Habitat Type | Delineated Area (acre) | ORAM  |          | Nearest Proposed Structure Number | Existing Structure Number in Wetland | Proposed Structure Number in Wetland | Structure Installation Method | Proposed Impacts              |                              |
|---|-----------|------------|-----------|--------------|------------------------|-------|----------|-----------------------------------|--------------------------------------|--------------------------------------|-------------------------------|-------------------------------|------------------------------|
|   | Latitude  | Longitude  |           |              |                        | Score | Category |                                   |                                      |                                      |                               | Temporary Matting Area (acre) | Permanent Impact Area (acre) |
| Wetland 1   | 39.710958 | -83.175773 | Yes       | PEM          | 0.02                   | 16    | 1        | N/A                               | N/A                                  | N/A                                  | TBD <sup>1</sup>              | 0.00                          | 0                            |
| <b>Total:</b>   |           |            |           |              | <b>0.02</b>            |       |          |                                   |                                      |                                      | <b>0.00</b>                   | <b>0.000</b>                  |                              |
| <sup>1</sup> TBD – To be determined. Structure installation method is unknown at this time. |           |            |           |              |                        |       |          |                                   |                                      |                                      |                               |                               |                              |

## ADKINS STATION EXPANSION PROJECT, PICKAWAY COUNTY, OHIO

Results

January 28, 2021

### 3.3 WATERBODIES

Stantec completed field surveys for streams within the Project area on November 18, 2020. Stantec did not identify any streams within the Project area.

### 3.4 OPEN WATERS

Stantec completed field surveys for open waters (i.e., ponds, lakes) within the Project area on November 18, 2020. Figure 2 (Appendix B) shows the location of the open water identified by Stantec within the Project area. Representative open water photographs are included in Appendix D of this report (photo locations are shown on Figure 2, Appendix B). Details of the open water is provided in Table 3.

**Table 3. Summary of Open Water Resources Found within the Adkins Station Expansion Project, Pickaway County, Ohio**

| Open Water ID | Location  |            | Open Water Type            | Delineated area (acre) | Isolated? | Proposed Impacts |             |
|---------------|-----------|------------|----------------------------|------------------------|-----------|------------------|-------------|
|               | Latitude  | Longitude  |                            |                        |           | Fill Type        | Area (acre) |
| Open Water 01 | 39.711072 | -83.175046 | Storm Water Retention Pond | 0.83                   | N/A*      | None             | 0           |

\*Per definitions in the 22250 Federal Register/Vol. 85, No. 77 (effective June 22, 2020; USACE 2020) paragraph (b)(10) stormwater control features are excluded from the "waters of the United States."

### 3.5 RARE, THREATENED, OR ENDANGERED SPECIES HABITAT

Table 4. Summary of Potential Federal and State-Listed Species within the Adkins Station Expansion Project Area, Pickaway County, Ohio.

| Common/Scientific Name                                  | State Listed Status <sup>1,2</sup> | Federally Listed Status <sup>3</sup> | Habitat Preference <sup>2</sup>  | Habitat Observed   | Agency Comment (Appendix E)  | Potential Impacts and Avoidance Dates   |
|---|------------------------------------|--------------------------------------|--|--|--|---|
| Indiana bat / <i>Myotis sodalis</i>                     | E                                  | E                                    | The Indiana bat is likely distributed over the entire State of Ohio, though not uniformly. This species generally forages in openings and edge habitats within upland and floodplain forest, but they also forage over old fields and pastures (Brack et al. 2010). Natural roost structures include trees (live or dead) with exfoliating bark, and exposure to solar radiation. Other important factors for roost trees include relative location to other trees, a permanent water source and foraging areas. Dead trees are preferred as maternity roosts; however, live trees are often used as secondary roosts depending on microclimate conditions (USFWS 2007, USFWS 2020b). Roosts have also occasionally been found to consist of cracks and hollows in trees, utility poles, buildings, and bat boxes. Primarily use caves for hibernacula, although are also known to hibernate in abandoned underground mines (Brack et al. 2010). | No suitable winter hibernacula or summer roost habitat was observed in the Project area. | <b>ODNR</b> – The Project is within the vicinity of records for the Indiana bat. Because presence has been established in the area, summer tree cutting is not recommended. However, limited summer tree cutting inside the buffer may be acceptable after further consultation with DOW. The DOW recommends tree cutting only occur from October 1 through March 31, conserving trees with loose, shaggy bark and/or crevices, holes, or cavities, as well as trees with DBH ≥20 if possible. The DOW further recommends a desktop habitat assessment, followed by a field assessment, if needed, is conducted to determine if there are potential hibernaculum present within the project area. If no tree cutting or subsurface impacts to a hibernaculum are proposed, this project is not likely to impact these species.<br><br><b>USFWS</b> - USFWS does not anticipate adverse effects to federally endangered, threatened, proposed, or candidate species due to the Project type, size, and location | No suitable winter hibernacula or suitable summer roosting habitat were observed in the Project area. AEP does not propose any tree clearing for the Project. |
| Northern long-eared bat / <i>Myotis septentrionalis</i> | E                                  | T                                    | The northern long-eared bat is found throughout Ohio. This species generally forages in forested habitat and openings in forested habitat and utilizes cracks, cavities, and loose bark within live and dead trees, as well as buildings as roosting habitat (Brack et al. 2010, USFWS 2020a). The species utilizes caves and abandoned mines as winter hibernacula. Various sized caves are used providing they have a constant temperature, high humidity, and little to no air current (Brack et al. 2010).   | No suitable winter hibernacula or summer roost habitat was observed in the Project area. | <b>ODNR</b> – The entire state of Ohio is within the range of this bat species. Therefore, the DOW recommends tree cutting only occur from October 1 through March 31, conserving trees with loose shaggy bark and/or crevices, holes, or cavities, as well as trees with DBH ≥ 20 if possible. The DOW further recommends a desktop habitat assessment, followed by a field assessment, if needed, is conducted to determine if there are potential hibernaculum present within the project area. If no tree cutting or subsurface impacts to a hibernaculum are proposed, this   | No suitable winter hibernacula or suitable summer roosting habitat were observed in the Project area. AEP does not propose any tree clearing for the Project. |

ADKINS STATION EXPANSION PROJECT, PICKAWAY COUNTY, OHIO

Results  
January 28, 2021

| Common/Scientific Name                       | State Listed Status <sup>1,2</sup> | Federally Listed Status <sup>3</sup> | Habitat Preference <sup>2</sup>  | Habitat Observed  | Agency Comment (Appendix E)   | Potential Impacts and Avoidance Dates   |
|--|------------------------------------|--------------------------------------|--|---|---|---|
|  |                                    |                                      |  |   | <p>project is not likely to impact these species.</p> <p><b>USFWS</b> - USFWS does not anticipate adverse effects to federally endangered, threatened, proposed, or candidate species due to the Project type, size, and location</p>   |   |
| Little brown bat / <i>Myotis lucifugus</i>   | E                                  | N/A                                  | <p>This bat uses a wide range of habitats and man-made structures for roosting, including buildings and attics. Less frequently, they use hollows of trees. Winter hibernation sites typically consist of caves, tunnels, abandoned mines. Foraging habitat for this species generally occurs over water, along the edges of lakes and stream or in woodlands near waterbodies (NatureServe 2020).</p>   | <p>No suitable winter hibernacula or summer roost habitat was observed in the Project area.</p> | <p><b>ODNR</b> – The entire state of Ohio is within the range of this bat species. Therefore, the DOW recommends tree cutting only occur from October 1 through March 31, conserving trees with loose shaggy bark and/or crevices, holes, or cavities, as well as trees with DBH ≥ 20 if possible. The DOW further recommends a desktop habitat assessment, followed by a field assessment, if needed, is conducted to determine if there are potential hibernaculum present within the project area. If no tree cutting or subsurface impacts to a hibernaculum are proposed, this project is not likely to impact these species.</p> <p><b>USFWS</b> – No Comment</p> | <p>No suitable winter hibernacula or suitable summer roosting habitat were observed in the Project area. AEP does not propose any tree clearing or structure removal for the Project.</p> |
| Tricolored bat / <i>Perimyotis subflavus</i> | E                                  | N/A                                  | <p>This species is found throughout Ohio and is associated with forested landscapes, foraging near trees and along waterways. Maternity and summer roosts usually occur in dead or live tree foliage, or in the south, in clumps of Spanish moss. Maternity colonies may also use tree cavities or man-made structures, such as buildings or bridges. Caves, mines, and rock crevices may be used as night roosts between foraging (NatureServe 2020).</p> | <p>No suitable winter hibernacula or summer roost habitat was observed in the Project area.</p> | <p><b>ODNR</b> – The entire state of Ohio is within the range of this bat species. Therefore, the DOW recommends tree cutting only occur from October 1 through March 31, conserving trees with loose shaggy bark and/or crevices, holes, or cavities, as well as trees with DBH ≥ 20 if possible. The DOW further recommends a desktop habitat assessment, followed by a field assessment, if needed, is conducted to determine if there are potential hibernaculum present within the project area. If no tree cutting or subsurface impacts to a hibernaculum are proposed, this project is not likely to impact these species.</p> <p><b>USFWS</b> – No Comment</p> | <p>No suitable winter hibernacula or suitable summer roosting habitat were observed in the Project area. AEP does not propose any tree clearing for the Project.</p>                      |

ADKINS STATION EXPANSION PROJECT, PICKAWAY COUNTY, OHIO

Results  
January 28, 2021

| Common/Scientific Name                                     | State Listed Status <sup>1,2</sup> | Federally Listed Status <sup>3</sup> | Habitat Preference <sup>2</sup>   | Habitat Observed  | Agency Comment (Appendix E)  | Potential Impacts and Avoidance Dates  |
|--|------------------------------------|--------------------------------------|---|---|--|--|
| Clubshell / <i>Pleurobema clava</i>                        | E                                  | E                                    | Clubshell is found in small to medium rivers, but occasionally found in large rivers, especially those having large shoal areas. It is generally found in clean, coarse sand and gravel in runs, often just downstream of a riffle and cannot tolerate mud or slackwater conditions (USFWS 1994). Badra (2001) found the clubshell in gravel/sand substrate, runs having laminar flow (0.06-0.25 m/sec) within small to medium sized streams. | No suitable habitat was observed within the Project area. | <b>ODNR</b> – Due to the location, and that there is no in-water work proposed in a perennial stream of sufficient size, the Project is not likely to impact this species.<br><br><b>USFWS</b> - USFWS does not anticipate adverse effects to federally endangered, threatened, proposed, or candidate species due to the Project type, size, and location | No suitable habitat was observed within the Project area. Therefore, no impacts to this species are anticipated. |
| Fanshell / <i>Cyprogenia stegaria</i>                      | E                                  | E                                    | Medium to large streams and rivers with moderate to strong current in coarse sand and gravel and depth ranging from shallow to deep (NatureServe 2020).   | No suitable habitat was observed within the Project area. | <b>ODNR</b> – Due to the location, and that there is no in-water work proposed in a perennial stream of sufficient size, the Project is not likely to impact this species.<br><br><b>USFWS</b> - USFWS does not anticipate adverse effects to federally endangered, threatened, proposed, or candidate species due to the Project type, size, and location | No suitable habitat was observed within the Project area. Therefore, no impacts to this species are anticipated. |
| Northern riffleshell / <i>Epioblasma torulosa rangiana</i> | E                                  | E                                    | This mussel is found in a wide variety of streams from small to large (USFWS 2019). Habitat for this species includes riffles and firmly packed substrates of fine to coarse gravel. This mussel needs highly oxygenated water (NatureServe 2020).  | No suitable habitat was observed within the Project area. | <b>ODNR</b> – Due to the location, and that there is no in-water work proposed in a perennial stream of sufficient size, the Project is not likely to impact this species.<br><br><b>USFWS</b> - USFWS does not anticipate adverse effects to federally endangered, threatened, proposed, or candidate species due to the Project type, size, and location | No suitable habitat was observed within the Project area. Therefore, no impacts to this species are anticipated. |
| Purple cat's paw / <i>Epioblasma o. obliquata</i>          | E                                  | E                                    | This mussel can be found in medium to large rivers with moderate gradient and riffles. Substrates can be sand to gravel (NatureServe 2020).   | No suitable habitat was observed within the Project area. | <b>ODNR</b> – Due to the location, and that there is no in-water work proposed in a perennial stream of sufficient size, the Project is not likely to impact this species.<br><br><b>USFWS</b> - USFWS does not anticipate adverse effects to federally endangered, threatened, proposed, or candidate species due to the Project type, size, and location | No suitable habitat was observed within the Project area. Therefore, no impacts to this species are anticipated. |
| Rayed bean / <i>Villosa fabalis</i>                        | E                                  | E                                    | Habitat includes gravel or sandy substrate, especially in areas of thick roots of aquatic plants, increase substrate stability (Butler 2002, Parmalee and Bogan 1998). Rayed bean can be associated with shoal or riffle areas, and in shallow, wave-washed areas of glacial lakes. It is generally found in smaller, headwater creeks, but sometimes in larger rivers and open-water bodies. It can occur in shallow riffles                 | No suitable habitat was observed within the Project area. | <b>ODNR</b> – Due to the location, and that there is no in-water work proposed in a perennial stream of sufficient size, the Project is not likely to impact this species.   | No suitable habitat was observed within the Project area. Therefore, no impacts to this species are anticipated. |



ADKINS STATION EXPANSION PROJECT, PICKAWAY COUNTY, OHIO

Results  
January 28, 2021

| Common/Scientific Name                              | State Listed Status <sup>1,2</sup> | Federally Listed Status <sup>3</sup> | Habitat Preference <sup>2</sup>   | Habitat Observed  | Agency Comment (Appendix E)  | Potential Impacts and Avoidance Dates  |
|---|------------------------------------|--------------------------------------|---|---|--|--|
|   |                                    |                                      | or in lakes with water depths up to four feet. It has been found in riffles, generally in vegetation, and deeply buried in sand and gravel bound together by roots (Parmalee and Bogan 1998).   |   | <b>USFWS</b> - USFWS does not anticipate adverse effects to federally endangered, threatened, proposed, or candidate species due to the Project type, size, and location   |  |
| Snuffbox / <i>Epioblasma triquetra</i>              | E                                  | E                                    | Snuffbox is commonly found buried in the substrate. It is found in a wide range of particle sized substrates, however, swift shallow riffles with sand and gravel are where it is typically found (Parmalee and Bogan 1998, Watters et al. 2009).                     | No suitable habitat was observed within the Project area. | <b>ODNR</b> – Due to the location, and that there is no in-water work proposed in a perennial stream of sufficient size, the Project is not likely to impact this species.<br><br><b>USFWS</b> - USFWS does not anticipate adverse effects to federally endangered, threatened, proposed, or candidate species due to the Project type, size, and location | No suitable habitat was observed within the Project area. Therefore, no impacts to this species are anticipated. |
| Rabbitsfoot / <i>Quadrula cylindrica cylindrica</i> | E                                  | T                                    | The typical habitat for this species is small to medium rivers with moderate to swift currents, and in smaller streams it inhabits bars or gravel and cobble close to the fast current. Found in medium to large rivers in sand and gravel shoals (NatureServe 2020). | No suitable habitat was observed within the Project area. | <b>ODNR</b> – Due to the location, and that there is no in-water work proposed in a perennial stream of sufficient size, the Project is not likely to impact this species.<br><br><b>USFWS</b> - USFWS does not anticipate adverse effects to federally endangered, threatened, proposed, or candidate species due to the Project type, size, and location | No suitable habitat was observed within the Project area. Therefore, no impacts to this species are anticipated. |
| Butterfly / <i>Ellipsaria lineolata</i>             | E                                  | N/A                                  | This mussel prefers stable substrate containing rock, gravel and sand in swift currents of large rivers (NatureServe 2020).   | No suitable habitat was observed within the Project area. | <b>ODNR</b> – Due to the location, and that there is no in-water work proposed in a perennial stream of sufficient size, the Project is not likely to impact this species.<br><br><b>USFWS</b> – No Comment  | No suitable habitat was observed within the Project area. Therefore, no impacts to this species are anticipated. |
| Ebonysell / <i>Fusconia ebenus</i>                  | E                                  | N/A                                  | Inhabits large rivers and prefers swift water and stable sand or gravel shoals. Coarse sand and gravel substrates provide the most suitable habitat. It can occur at depths of 10-15 feet with current associated (NatureServe 2020).                                 | No suitable habitat was observed within the Project area. | <b>ODNR</b> – Due to the location, and that there is no in-water work proposed in a perennial stream of sufficient size, the Project is not likely to impact this species.<br><br><b>USFWS</b> – No Comment  | No suitable habitat was observed within the Project area. Therefore, no impacts to this species are anticipated. |
| Elephant-ear / <i>Elliptio crassidens</i>           | E                                  | N/A                                  | This mussel is found in muddy sand, sand, and rocky substrates in moderate currents. In some areas, it is common in large creeks to rivers with moderate to swift currents primarily on sand and limestone or rock substrates (NatureServe 2020).                     | No suitable habitat was observed within the Project area. | <b>ODNR</b> – Due to the location, and that there is no in-water work proposed in a perennial stream of sufficient size, the Project is not likely to impact this species.<br><br><b>USFWS</b> – No Comment  | No suitable habitat was observed within the Project area. Therefore, no impacts to this species are anticipated. |

ADKINS STATION EXPANSION PROJECT, PICKAWAY COUNTY, OHIO

Results  
January 28, 2021

| Common/Scientific Name                           | State Listed Status <sup>1,2</sup> | Federally Listed Status <sup>3</sup> | Habitat Preference <sup>2</sup>   | Habitat Observed  | Agency Comment (Appendix E)   | Potential Impacts and Avoidance Dates  |
|--|------------------------------------|--------------------------------------|---|---|---|--|
| Long-solid / <i>Fusconaia maculata maculata</i>  | E                                  | N/A                                  | This species is found in medium to large rivers in gravel with a strong current (NatureServe 2020).   | No suitable habitat was observed within the Project area. | <b>ODNR</b> – Due to the location, and that there is no in-water work proposed in a perennial stream of sufficient size, the Project is not likely to impact this species.<br><br><b>USFWS</b> – No Comment | No suitable habitat was observed within the Project area. Therefore, no impacts to this species are anticipated. |
| Ohio pigtoe / <i>Pleurobema cordatum</i>         | E                                  | N/A                                  | Occurs in medium to large rivers directly above riffles of gravel, cobble, and boulder, but occasionally in muddy or sandy or gravel habitats at great depths (NatureServe 2020).   | No suitable habitat was observed within the Project area. | <b>ODNR</b> – Due to the location, and that there is no in-water work proposed in a perennial stream of sufficient size, the Project is not likely to impact this species.<br><br><b>USFWS</b> – No Comment | No suitable habitat was observed within the Project area. Therefore, no impacts to this species are anticipated. |
| Pyramid pigtoe / <i>Pleurobema rubrum</i>        | E                                  | N/A                                  | This mussel is a riffle and shoal species that prefers the swift currents of coarse gravel, sand, and mud substrates within medium to large rivers (NatureServe 2020).  | No suitable habitat was observed within the Project area. | <b>ODNR</b> – Due to the location, and that there is no in-water work proposed in a perennial stream of sufficient size, the Project is not likely to impact this species.<br><br><b>USFWS</b> – No Comment | No suitable habitat was observed within the Project area. Therefore, no impacts to this species are anticipated. |
| Sharp-ridged pocketbook / <i>Lampsilis ovata</i> | E                                  | N/A                                  | Very generalized in habitat preference, adapting well to both impoundment situations as well as free-flowing, shallow rivers. Usually found in moderate to strong current, it can survive in standing water. The most suitable substrate consists of a mixture of gravel and coarse sand mixed with some silt or mud (NatureServe 2020).                        | No suitable habitat was observed within the Project area. | <b>ODNR</b> – Due to the location, and that there is no in-water work proposed in a perennial stream of sufficient size, the Project is not likely to impact this species.<br><br><b>USFWS</b> – No Comment | No suitable habitat was observed within the Project area. Therefore, no impacts to this species are anticipated. |
| Washboard / <i>Megaloniais nervosa</i>           | E                                  | N/A                                  | Occurs in large rivers, typically in main channel or overbank areas of reservoirs. It is found in areas of slow current with muddy to coarse gravel substrates and water can be up to 50 feet (NatureServe 2020).   | No suitable habitat was observed within the Project area. | <b>ODNR</b> – Due to the location, and that there is no in-water work proposed in a perennial stream of sufficient size, the Project is not likely to impact this species.<br><br><b>USFWS</b> – No Comment | No suitable habitat was observed within the Project area. Therefore, no impacts to this species are anticipated. |
| Black sandshell / <i>Ligumia recta</i>           | T                                  | N/A                                  | Typically found in medium-sized to large rivers in locations with strong current and substrates of coarse sand and gravel with cobbles in water depths from several inches to six feet or more (NatureServe 2020).  | No suitable habitat was observed within the Project area. | <b>ODNR</b> – Due to the location, and that there is no in-water work proposed in a perennial stream of sufficient size, the Project is not likely to impact this species.<br><br><b>USFWS</b> – No Comment | No suitable habitat was observed within the Project area. Therefore, no impacts to this species are anticipated. |
| Fawnsfoot / <i>Truncilla donaciformis</i>        | T                                  | N/A                                  | This species occurs in both large and medium-sized rivers at normal depths varying from less than three feet up to 15 to 18 feet in big rivers such as the Tennessee. A substrate of either sand or mud is suitable and although it is typically found in moderate current, it can adapt to a lake or embayment environment lacking current (NatureServe 2020). | No suitable habitat was observed within the Project area. | <b>ODNR</b> – Due to the location, and that there is no in-water work proposed in a perennial stream of sufficient size, the Project is not likely to impact this species.<br><br><b>USFWS</b> – No Comment | No suitable habitat was observed within the Project area. Therefore, no impacts to this species are anticipated. |

ADKINS STATION EXPANSION PROJECT, PICKAWAY COUNTY, OHIO

Results  
January 28, 2021

| Common/Scientific Name                              | State Listed Status <sup>1,2</sup> | Federally Listed Status <sup>3</sup> | Habitat Preference <sup>2</sup>  | Habitat Observed  | Agency Comment (Appendix E)  | Potential Impacts and Avoidance Dates  |
|---|------------------------------------|--------------------------------------|--|---|--|--|
| Pondhorn / <i>Uniomerus tetralasmus</i>             | T                                  | N/A                                  | This species typically inhabits the quiet or slow-moving, shallow waters of sloughs, borrow pits, ponds, ditches, and meandering streams. It is tolerant of poor water conditions and can be found well buried in a substrate of fine silt and/or mud. It has been known to survive for extended periods of time when a pond or slough has temporarily dried up by burying itself deep into the substrate (NatureServe 2020).  | No suitable habitat was observed within the Project area. | <b>ODNR</b> – Due to the location, and that there is no in-water work proposed in a perennial stream of sufficient size, the Project is not likely to impact this species.<br><br><b>USFWS</b> – No Comment  | No suitable habitat was observed within the Project area. Therefore, no impacts to this species are anticipated. |
| Threehorn wartyback / <i>Obliquaria reflexa</i>     | T                                  | N/A                                  | Habitat includes large rivers with moderately strong current and stable substrate of gravel, sand, and mud (NatureServe 2020).   | No suitable habitat was observed within the Project area. | <b>ODNR</b> – Due to the location, and that there is no in-water work proposed in a perennial stream of sufficient size, the Project is not likely to impact this species.<br><br><b>USFWS</b> – No Comment  | No suitable habitat was observed within the Project area. Therefore, no impacts to this species are anticipated. |
| Scioto Madtom / <i>Noturus trautmani</i>            | N/A                                | E                                    | Only 18 individuals of the Scioto madtom have ever been found. Of those, 14 were found in the fall of 1957 and none have been seen since. No other fish has been searched for more persistently by researchers in Ohio than this species. This fish has never been found outside of Ohio and all 18 individuals were found in a small area of Big Darby Creek. They were found in the tail end of riffles over a sand and gravel substrate. Since all of the individuals were found in the fall it has been speculated that they may spend the remainder of the year further upstream. They likely eat various aquatic invertebrates like most other madtom species (ODNR Division of Wildlife 2020b). | No suitable habitat was observed within the Project area. | <b>ODNR</b> – If no in-water work is proposed in a perennial stream, this Project is not likely to impact this or other aquatic species.<br><br><b>USFWS</b> - USFWS does not anticipate adverse effects to federally endangered, threatened, proposed, or candidate species due to the Project type, size, and location | No suitable habitat was observed within the Project area. Therefore, no impacts to this species are anticipated. |
| Bigeye shiner / <i>Notropis boops</i>               | E                                  | N/A                                  | Flowing pools of moderately clear creeks and small to medium rivers with large permanent pools over bottom of clear sand, gravel, or rock. Often at stream margin in beds of emergent vegetation (NatureServe 2020).   | No suitable habitat was observed within the Project area. | <b>ODNR</b> – If no in-water work is proposed in a perennial stream, this Project is not likely to impact this or other aquatic species.<br><br><b>USFWS</b> – No Comment  | No suitable habitat was observed within the Project area. Therefore, no impacts to this species are anticipated. |
| Goldeye / <i>Hiodon alosoides</i>                   | E                                  | N/A                                  | This fish is found in large rivers and are rather tolerant of turbid waters from clay silts. They do not, however, tolerate industrial chemical pollutants. They are often found in areas with swift currents, often below dams. This fish is found in the Ohio River and its larger tributaries, particularly the Scioto River (ODNR Division of Wildlife 2020b).   | No suitable habitat was observed within the Project area. | <b>ODNR</b> – If no in-water work is proposed in a perennial stream, this Project is not likely to impact this or other aquatic species.<br><br><b>USFWS</b> – No Comment  | No suitable habitat was observed within the Project area. Therefore, no impacts to this species are anticipated. |
| Northern brook lamprey / <i>Ichthyomyzon fossor</i> | E                                  | N/A                                  | Adult lampreys are found in clear brooks with fast flowing water and sand or gravel bottoms. Juveniles are found in slow moving water buried in soft substrate in medium to large streams (ODNR Division of Wildlife 2020b).   | No suitable habitat was observed within the Project area. | <b>ODNR</b> – If no in-water work is proposed in a perennial stream, this Project is not likely to impact this or other aquatic species.<br><br><b>USFWS</b> – No Comment  | No suitable habitat was observed within the Project area. Therefore, no impacts to this species are anticipated. |

ADKINS STATION EXPANSION PROJECT, PICKAWAY COUNTY, OHIO

Results  
January 28, 2021

| Common/Scientific Name                                    | State Listed Status <sup>1,2</sup> | Federally Listed Status <sup>3</sup> | Habitat Preference <sup>2</sup>  | Habitat Observed  | Agency Comment (Appendix E)   | Potential Impacts and Avoidance Dates  |
|---|------------------------------------|--------------------------------------|--|---|---|--|
| Northern madtom / <i>Noturus stigmosus</i>                | E                                  | N/A                                  | Habitat includes deep, swift riffles of large rivers with substrates of cobble and boulders (ODNR Division of Wildlife 2020b).   | No suitable habitat was observed within the Project area. | <b>ODNR</b> – If no in-water work is proposed in a perennial stream, this Project is not likely to impact this or other aquatic species.<br><br><b>USFWS</b> – No Comment | No suitable habitat was observed within the Project area. Therefore, no impacts to this species are anticipated. |
| Shortnose gar / <i>Lepisosteus platostomus</i>            | E                                  | N/A                                  | This fish is found in large rivers and associated overflow ponds and backwaters. This fish is found in the Ohio River and some of its larger tributaries, particularly the Scioto River (ODNR Division of Wildlife 2020b).   | No suitable habitat was observed within the Project area. | <b>ODNR</b> – If no in-water work is proposed in a perennial stream, this Project is not likely to impact this or other aquatic species.<br><br><b>USFWS</b> – No Comment | No suitable habitat was observed within the Project area. Therefore, no impacts to this species are anticipated. |
| Spotted darter / <i>Etheostoma maculatum</i>              | E                                  | N/A                                  | This fish is found in medium sized rivers and streams. They are typically found in areas of swift current at the top or bottom end of a riffle where there are many very large boulders or flab slabs or rock. They spend most of their time hiding under the upstream edge of these large rocks with their heads sticking out watching for food (ODNR Division of Wildlife 2020b).  | No suitable habitat was observed within the Project area. | <b>ODNR</b> – If no in-water work is proposed in a perennial stream, this Project is not likely to impact this or other aquatic species.<br><br><b>USFWS</b> – No Comment | No suitable habitat was observed within the Project area. Therefore, no impacts to this species are anticipated. |
| Shovelnose sturgeon / <i>Scaphirhynchus platyrhynchus</i> | E                                  | N/A                                  | Habitat includes large rivers with sand and gravel substrates and fast current (ODNR Division of Wildlife 2020b).  | No suitable habitat was observed within the Project area. | <b>ODNR</b> – If no in-water work is proposed in a perennial stream, this Project is not likely to impact this or other aquatic species.<br><br><b>USFWS</b> – No Comment | No suitable habitat was observed within the Project area. Therefore, no impacts to this species are anticipated. |
| Blue sucker / <i>Cycleptus elongatus</i>                  | T                                  | N/A                                  | Habitat includes the largest rivers and lower portions of major tributaries. Usually occurs in channels and flowing pools with moderate current (NatureServe 2020).  | No suitable habitat was observed within the Project area. | <b>ODNR</b> – If no in-water work is proposed in a perennial stream, this Project is not likely to impact this or other aquatic species.<br><br><b>USFWS</b> – No Comment | No suitable habitat was observed within the Project area. Therefore, no impacts to this species are anticipated. |
| Lake chubsucker / <i>Erimyzon sucetta</i>                 | T                                  | N/A                                  | This fish is found in natural lakes and very sluggish streams or marshes with dense aquatic vegetation and clear waters primarily found in glacially formed natural lakes often referred to as pothole or kettle lakes. This species is found in the group of lakes between Bellefontaine and Urbana, and three slow moving stream systems that have interconnected wetland complexes which include Killbuck Marsh, the upper Cuyahoga River, and the Black Fork of Symmes Creek including Jackson Lake (ODNR Division of Wildlife 2020b). | No suitable habitat was observed within the Project area. | <b>ODNR</b> – If no in-water work is proposed in a perennial stream, this Project is not likely to impact this or other aquatic species.<br><br><b>USFWS</b> – No Comment | No suitable habitat was observed within the Project area. Therefore, no impacts to this species are anticipated. |
| Paddlefish / <i>Polyodon spathula</i>                     | T                                  | N/A                                  | This fish is found in the Ohio River and its larger tributaries, preferring sluggish pools and backwater areas (ODNR Division of Wildlife 2020b).  | No suitable habitat was observed within the Project area. | <b>ODNR</b> – If no in-water work is proposed in a perennial stream, this Project is not likely to impact this or other aquatic species.<br><br><b>USFWS</b> – No Comment | No suitable habitat was observed within the Project area. Therefore, no impacts to this species are anticipated. |

ADKINS STATION EXPANSION PROJECT, PICKAWAY COUNTY, OHIO

Results  
January 28, 2021

| Common/Scientific Name                           | State Listed Status <sup>1,2</sup> | Federally Listed Status <sup>3</sup> | Habitat Preference <sup>2</sup>  | Habitat Observed  | Agency Comment (Appendix E)  | Potential Impacts and Avoidance Dates  |
|--|------------------------------------|--------------------------------------|--|---|--|--|
| Tippecanoe darter / <i>Etheostoma tippecanoe</i> | T                                  | N/A                                  | This fish prefers medium to large streams in the Ohio River drainage system and are found in riffles of moderate current with substrate of gravel or cobble sized rocks (ODNR Division of Wildlife 2020b).   | No suitable habitat was observed within the Project area.   | <b>ODNR</b> – If no in-water work is proposed in a perennial stream, this Project is not likely to impact this or other aquatic species.<br><br><b>USFWS</b> – No Comment  | No suitable habitat was observed within the Project area. Therefore, no impacts to this species are anticipated.         |
| Lark Sparrow / <i>Chondestes grammacus</i>       | E                                  | N/A                                  | This species is found in shortgrass, mixed-grass, and tallgrass prairie with shrub components (NatureServe 2020).  | No suitable habitat was observed within the Project area.   | <b>ODNR</b> – The Project is within the range of the lark sparrow. Therefore, DOW recommends if suitable habitat will be impacted, construction should be avoided in suitable habitat during the species' nesting period of May 1 to June 30. If suitable habitat will not be impacted, the Project is not likely to impact this species.<br><br><b>USFWS</b> – No Comment   | No suitable habitat was observed within the Project area. Therefore, no impacts to this species are anticipated.         |
| Least Bittern / <i>Ixobrychus exilis</i>         | T                                  | N/A                                  | The least bittern hides in dense emergent marshes, particularly where there are thick cattail stands (ODNR Division of Wildlife 2020b). The ODNR response letter adds that habitat should be interspersed with woody vegetation (Appendix E).  | No suitable habitat was observed within the Project area.   | <b>ODNR</b> – The Project is within the range of the least bittern. Therefore, DOW recommends if suitable habitat will be impacted, construction should be avoided in this habitat during the species' nesting period of May 1 to July 31. If suitable habitat will not be impacted, the Project is not likely to impact this species.<br><br><b>USFWS</b> – No Comment      | No suitable habitat was observed within the Project area. Therefore, no impacts to this species are anticipated.         |
| Norther harrier / <i>Circus hudsonis</i>         | E                                  | N/A                                  | Northern harriers hunt low over grasslands. It is a common migrant and winter species; nesters are much rarer, although they occasionally breed in large marshes and grasslands (ODNR Division of Wildlife 2020b).   | No suitable habitat was observed within the Project area.   | <b>ODNR</b> – The Project is within the range of the northern harrier. Therefore, DOW recommends if suitable habitat will be impacted, construction should be avoided in this habitat during the species' nesting period of May 15 to August 1. If suitable habitat will not be impacted, the Project is not likely to impact this species.<br><br><b>USFWS</b> – No Comment | No suitable habitat was observed within the Project area. Therefore, no impacts to this species are anticipated.         |
| Sandhill crane / <i>Grus canadensis</i>          | T                                  | N/A                                  | Sandhill cranes are primarily a wetland dependent species. They will utilize agricultural fields for their wintering grounds. However, they roost in shallow, standing water or moist bottomlands. They require rather large tracts of wet meadows, shallow marsh or bog for breeding and nesting. Sandhill cranes are seasonal residents (ODNR Division of Wildlife 2020b). | Potential suitable wintering habitat (agriculture fields) was observed within the Project area. No suitable nesting habitat was observed within the Project area. | <b>ODNR</b> – The Project is within the range of the sandhill crane. Therefore, DOW recommends is grassland, prairie, or wetland habitat will be impacted, construction should be avoided in this habitat during the species' nesting period of April 1 to September 1. If this habitat will not be impacted, the Project is not likely to have an impact on this species.   | No suitable nesting habitat was observed within the Project area. Therefore, no impacts to this species are anticipated. |

ADKINS STATION EXPANSION PROJECT, PICKAWAY COUNTY, OHIO

Results  
January 28, 2021

| Common/Scientific Name                         | State Listed Status <sup>1,2</sup> | Federally Listed Status <sup>3</sup> | Habitat Preference <sup>2</sup>  | Habitat Observed  | Agency Comment (Appendix E)   | Potential Impacts and Avoidance Dates  |
|--|------------------------------------|--------------------------------------|--|---|---|--|
|  |                                    |                                      |  |   | USFWS – No Comment  |  |
| Upland sandpiper / <i>Bartramia longicauda</i> | E                                  | N/A                                  | This species is found in extensive, open tracts of short grassland habitat. This species nests in dry grasslands including native grasslands, seeded grasslands, grazed and ungrazed pasture, hayfields, and grasslands established through Conservation Reserve Program (ODNR DOW 2020b). | No suitable habitat was observed within the Project area. | ODNR – The Project is within the range of the upland sandpiper. Therefore, DOW recommends if suitable habitat will be impacted, construction should be avoided in suitable habitat during the species' nesting period of April 15 to July 31. If suitable habitat will not be impacted, the Project is not likely to impact this species.<br><br>USFWS – No Comment | No suitable habitat was observed within the Project area. Therefore, no impacts to this species are anticipated. |

<sup>1</sup>Status Key: E = Endangered; T = Threatened

## **4.0 CONCLUSIONS AND RECOMMENDATIONS**

Stantec conducted a wetland and waterbodies delineation and a preliminary habitat assessment for threatened and endangered species within the Project area on November 18, 2020. During the field surveys, one PEM wetland totaling approximately 0.02 acres and one open water, storm water retention pond, totaling approximately 0.83 acres were delineated. No streams were delineated within the Project area.

Two wetland determination sample points (SP01 and SP04) were evaluated during the field surveys due to the presence of hydrophytic vegetation, hydric soils, and hydrology. The wetland determination sample points were located within constructed upland drainage features for the existing station. Although SP01 and SP04 met wetland determination criteria, per definitions in the 22250 Federal Register/Vol. 85, No. 77 (effective June 22, 2020; USACE 2020) paragraph (b)(10) stormwater control features are excluded from the “waters of the United States.” The upland drainage features were constructed wholly in uplands for the purpose of conveying stormwater runoff. Therefore, sample points SP01 and SP04 were not delineated as wetlands.

The information provided by Stantec regarding wetland boundaries is based on an analysis of the wetland and upland conditions present within the Project Area at the time of the field work. The delineations were performed by experienced and qualified professionals using regulatory agency-accepted practices and sound professional judgment.

An ODNR Ohio Natural Heritage Program data request and environmental review request letter was sent to the ODNR Office of Real Estate on November 17, 2020. The ODNR Office of Real Estate response letter dated January 11, 2021 (Appendix E), stated the Natural Heritage Database has no records at or within a one-mile radius of the Project area.

The letter also indicated the Project is within the vicinity of records for the Indiana bat. Because presence of the bat species has been established in the area, the Division of Wildlife (DOW) recommends no summer tree cutting. However, limited summer tree cutting inside this buffer may be acceptable after further consultation with DOW. In addition, the entire state of Ohio is within the range of the northern long-eared bat, little brown bat, and tricolored bat. The DOW recommends tree cutting only occur from October 1 through March 31, conserving trees with loose shaggy bark and/or crevices, holes, or cavities, as well as trees with DBH  $\geq$  20” if possible. The DOW also recommends that a desktop habitat assessment, followed by a field assessment if needed, is conducted to determine if there are potential hibernaculum present within the Project area. The desktop assessment, using ODNR interactive tools (ODNR Division of Geological Survey Karst Interactive Map and ODNR Division of Mineral Resources Mines of Ohio Map) revealed no karst features or abandon underground mines within or near the Project area. During field surveys, Stantec did not observe winter hibernacula or suitable foraging and roosting habitat for the Indiana bat, northern long-eared bat, little brown bat, and tricolored bat.

## ADKINS STATION EXPANSION PROJECT, PICKAWAY COUNTY, OHIO

Conclusions and Recommendations  
January 28, 2021

According to the ODNR response letter, the Project is within the range of the federally listed endangered clubshell, fanshell, northern riffleshell, purple cat's paw, rayed bean and snuffbox, and the federally listed threatened rabbitsfoot, and the state-listed endangered butterfly, ebonyshell, elephant-ear, long-solid, Ohio pigtoe, pyramid pigtoe, sharp-ridged pocketbook, and washboard, and the state-listed threatened black sandshell, fawnsfoot, pondhorn, and threehorn wartyback. However, due to the location, and/or that there is no in-water work proposed in a perennial stream, this Project is not likely to impact these species. During field surveys, Stantec did not identify any streams within the Project area, therefore, impacts to freshwater mussels is not likely.

According to the ODNR response letter, the Project is within the range of the federally listed endangered Scioto madtom, and the state-listed endangered bigeye shiner, goldeye, northern brook lamprey, northern madtom, shortnose gar, spotted darter, and shovelnose sturgeon, and the state-listed threatened blue sucker, lake chubsucker, paddlefish and Tippecanoe darter. The ODNR DOW recommends no in-water work in perennial streams from April 15 to June 30 to reduce impacts to indigenous aquatic species and their habitat. However, if no in-water work proposed in a perennial stream, this Project is not likely to impact these species. During field surveys, Stantec did not identify any streams within the Project area, therefore, impacts to aquatic species is not likely.

According to the ODNR response letter, the Project is within the range of the lark sparrow (*Chondestes grammacus*; state endangered). This species nests in grassland habitats with scattered shrub layers, disturbed open areas, as well as patches of bare soil. The DOW recommends if this type of habitat will be impacted, construction should be avoided in this habitat during the species' nesting period of May 1 to June 30. Field surveys did not identify any potential suitable habitat for this species within the Project area, therefore, no impacts to this species are anticipated.

According to the ODNR response letter, the Project is within the range of the least bittern (*Ixobrychus exilis*; state threatened). This species prefers dense emergent wetlands with thick stands of cattails, sedges, sawgrass or other semiaquatic vegetation interspersed with woody vegetation and open water. The DOW states, if suitable habitat will be impacted, construction should be avoided in this habitat during the species' nesting period of May 1 to July 3. Field surveys did not identify any potential suitable habitat for this species within the Project area, therefore, no impacts to this species are anticipated.

According to the ODNR response letter, the Project is within the range of the northern harrier (*Circus hudsonius*; state endangered). This species occasionally breed in large marshes and grasslands. Harriers often nest in loose colonies and the female will build a nest out of sticks on the ground, often on top of a mound. Harriers hunt over grasslands. The DOW states, if this type of habitat will not be impacted, this Project is not likely to impact this species. Field surveys did not identify any potential suitable habitat for this species within the Project area, therefore, no impacts to this species are anticipated.



## ADKINS STATION EXPANSION PROJECT, PICKAWAY COUNTY, OHIO

Conclusions and Recommendations  
January 28, 2021

According to the ODNR response letter the Project is within the range of the sandhill crane (*Grus canadensis*; state threatened). This species is primarily a wetland-dependent species. On their breeding grounds, they require a rather large tract of wet meadow, shallow marsh, or bog for nesting. The DOW states, if grassland, prairie, or wetland habitat will be impacted, construction should be avoided in this habitat during the species' nesting period of April 1 to September 1. Field surveys identified potential suitable wintering habitat (agriculture fields) within the Project area. However, no suitable potential nesting habitat was observed within the Project area, therefore, no impacts to this species are anticipated.

According to the ONDR response letter, the Project is within the range of the upland sandpiper (*Bartramia longicauda*; state endangered). This species utilizes dry grasslands including native grasslands, seeded grasslands, grazed and ungrazed pasture, hayfields, and grasslands established through the Conservation Reserve Program (CRP). The DOW states if this type of habitat will be impacted, construction should be avoided in this habitat during the species' nesting period of April 15 to July 31. Field surveys did not identify any potential suitable habitat for this species within the Project area, therefore, no impacts to this species are anticipated.

A technical assistance request letter was also submitted to the USFWS on November 17, 2020. The USFWS response letter dated November 17, 2020, stated that USFWS does not anticipate adverse effects to federally endangered, threatened, proposed, or candidate species due to the Project type, size, and location (Appendix E).

## ADKINS STATION EXPANSION PROJECT, PICKAWAY COUNTY, OHIO

### References

January 28, 2021

## 5.0 REFERENCES

Brack, Virgil Jr., Dale W. Sparks, John O. Whitaker Jr., Brianne L. Walters, and Angela Boyer. 2010. Bats of Ohio. Indiana State University Center for North American Bat Research and Conservation.

Butler, R. S. 2002. Status assessment report for the rayed bean, *Villosa fabalis*, occurring in the Mississippi River and Great Lakes systems. U.S. Fish and Wildlife Service Regions 3, 4, and 5, and Canada. 62 pp.

Cowardin, L.M., V. Carter V., F.C. Golet, and E.T. LaRoe. 1979. Classification of Wetlands and Deepwater Habitats of the United States. U.S. Fish and Wildlife Service Report No. FWS/OBS/-79/31. Washington, D.C.

Mack, J.J. 2001. Ohio Rapid Assessment Method for Wetlands, Manual for Using Version 5.0. Ohio EPA Technical Bulletin Wetland/2001-1-1. Ohio Environmental Protection Agency, Division of Surface Water, 401 Wetland Ecology Unit, Columbus, Ohio.

NatureServe. 2020. NatureServe Explorer: An online encyclopedia of life [web application]. Version 7.1. NatureServe, Arlington, VA. U.S.A. Available at <http://explorer.natureserve.org>. Accessed December 2020.

Ohio Department of Natural Resources (ODNR) Division of Wildlife. 2020a. State Listed Wildlife Species by County. Available at <https://ohiodnr.gov/wps/portal/gov/odnr-core/documents/wildlife-documents/state-listed-wildlife-county>. Accessed January 2021.

ODNR and U.S. Fish and Wildlife Service (USFWS). 2020. Ohio Mussel Survey Protocol (April 2020). Available at <https://ohiodnr.gov/static/documents/wildlife/permits/dow-protocol-ohio-mussel-survey.pdf>. Accessed January 2021.

Ohio Environmental Protection Agency (OEPA). 2006. Methods for Assessing Habitat in Flowing Waters: Using the Qualitative Habitat Evaluation Index (QHEI).

Ohio EPA. 2018. Field Methods for Evaluating Primary Headwater Streams in Ohio. Version 4.0. Ohio EPA Division of Surface Water, Columbus, Ohio. 129 pp.

Parmalee, P. W. and A. E. Bogan. 1998. The Freshwater Mussels of Tennessee. University of Tennessee Press: Knoxville, Tennessee. 328 pp.

U.S. Army Corps of Engineers (USACE), Environmental Laboratory. 1987. Corps of Engineers Wetlands Delineation Manual, Technical Report Y 87 1, U.S. Army Engineer Waterway Experiment Station, Vicksburg, Mississippi.

USACE. 2005. Guidance on Ordinary High Water Mark Identification (Regulatory Guidance Letter, No.05-05). Available online at

## ADKINS STATION EXPANSION PROJECT, PICKAWAY COUNTY, OHIO

### References

January 28, 2021

<https://www.nap.usace.army.mil/Portals/39/docs/regulatory/rgls/rgl05-05.pdf>. Accessed November 2019.

USACE. 2010. *Regional Supplement to the Corps of Engineers Wetland Delineation Manual: Midwest Region (Version 2.0)*, ed. J. S. Wakeley, R. W. Lichvar, and C. V. Noble. ERDC/EL TR-10-16. Vicksburg, MS: U.S. Army Engineer Research and Development Center.

USACE. 2020. The Navigable Waters Protection Rule: Definition of "Waters of the United States"; Vol 85, No. 77. Fed. Reg. 22250. April 21, 2020. Federal Register: The Daily Journal of the United States. Available at <https://www.federalregister.gov/documents/2020/04/21/2020-02500/the-navigable-waters-protection-rule-definition-of-waters-of-the-united-states>.

United States Fish and Wildlife Service (USFWS). 1994. Clubshell (*Pleurobema clava*) and Northern Riffleshell (*Epioblasma torulosa rangiana*) Recovery Plan. Prepared for the U.S. Fish and Wildlife Service, Hadley, Massachusetts. 68 pp.

USFWS. 2007. Indiana bat (*Myotis sodalis*) draft recovery plan: First revision. U.S. Fish and Wildlife Service, Ft. Snelling, Minnesota. 258 pp.

USFWS. 2018. Federally-Listed Threatened, Endangered, Proposed, and Candidate Species County Distribution. Available at <https://www.fws.gov/midwest/endangered/lists/ohio-cty.html>. Accessed November 2020.

## Appendix A **IMPACT TABLES**

### A.1 WETLAND IMPACT TABLE

**ADKINS STATION EXPANSION PROJECT  
WETLAND TABLE**

| Wetland ID  | Location  |            | Isolated? | Habitat Type | Delineated Area (acre) | ORAM  |          | Nearest Proposed Structure Number | Existing Structure Number in Wetland | Proposed Structure Number in Wetland | Structure Installation Method | Proposed Impacts              |                              |
|---|-----------|------------|-----------|--------------|------------------------|-------|----------|-----------------------------------|--------------------------------------|--------------------------------------|-------------------------------|-------------------------------|------------------------------|
|   | Latitude  | Longitude  |           |              |                        | Score | Category |                                   |                                      |                                      |                               | Temporary Matting Area (acre) | Permanent Impact Area (acre) |
| Wetland 1   | 38.710958 | -83.175773 | Yes       | PEM          | 0.02                   | 16    | 1        | N/A                               | N/A                                  | N/A                                  | TBD <sup>1</sup>              | 0.00                          | 0                            |
| <b>Total:</b>   |           |            |           |              | <b>0.02</b>            |       |          |                                   |                                      |                                      | <b>0.00</b>                   | <b>0.000</b>                  |                              |
| <sup>1</sup> TBD – To be determined. Structure installation method is unknown at this time. |           |            |           |              |                        |       |          |                                   |                                      |                                      |                               |                               |                              |

Figures  
January 20, 2021

## Appendix B **FIGURES**

### B.1 **FIGURE 1 – PROJECT LOCATION MAP**



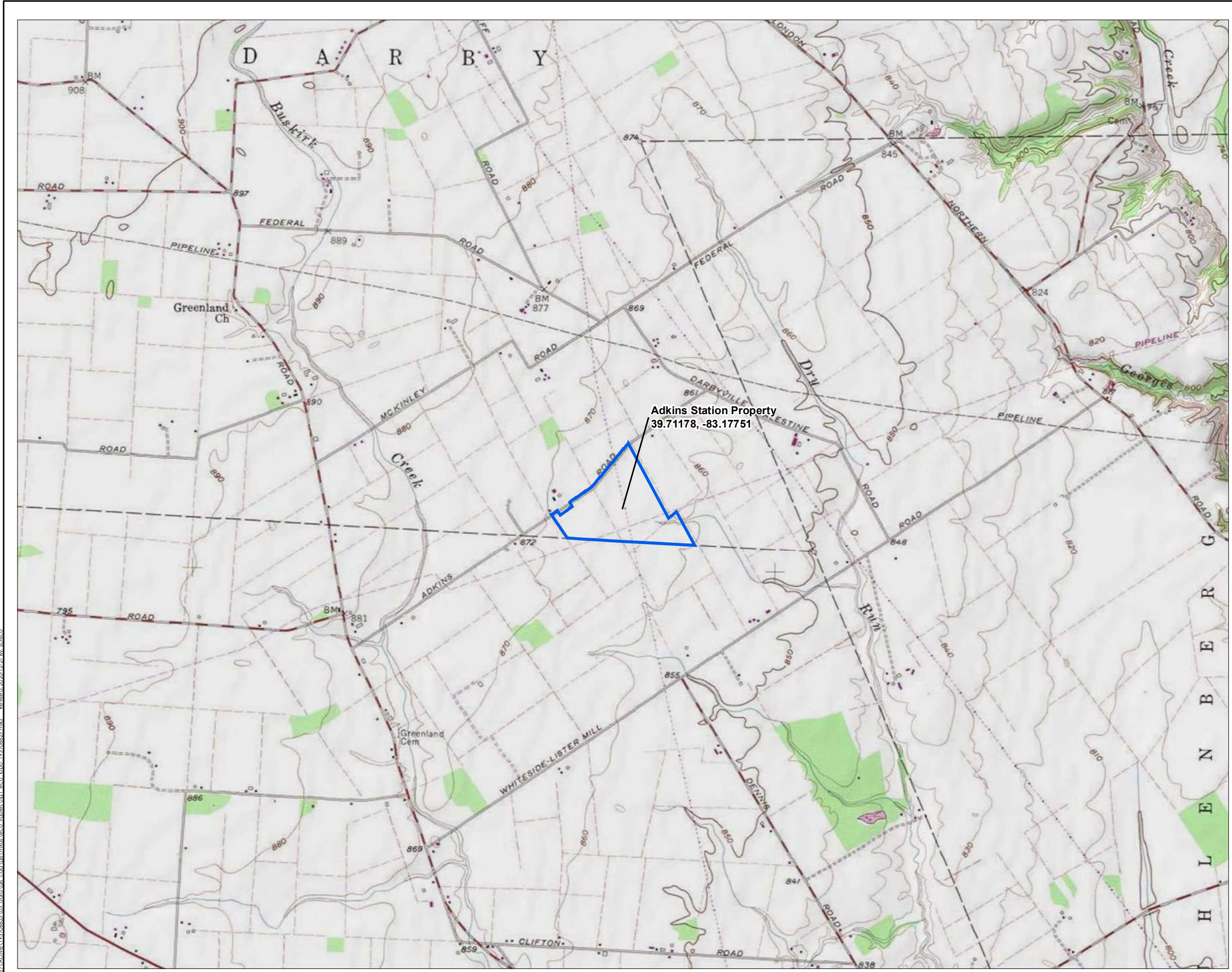
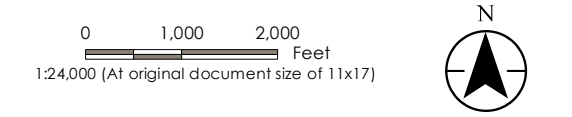

Figure No. **1**  
 Title **Project Location Map**

Client/Project  
 AEP Ohio Transmission Company, Inc.  
 Adkins Station Expansion Project

Project Location 193706823  
 Pickaway County, Ohio Prepared by SEC on 2020-12-07  
 Technical Review by JH on 2020-12-14  
 Independent Review by MT on 2020-12-17



Legend  
 Project Area

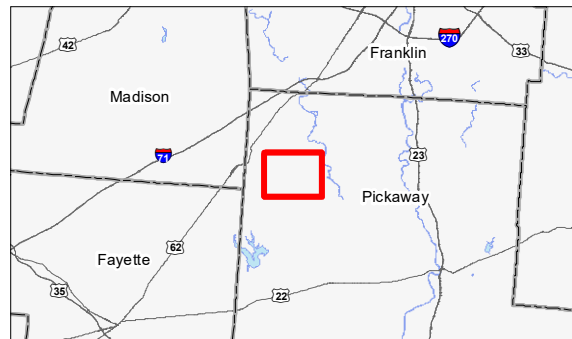

Notes  
 1. Coordinate System: NAD 1983 StatePlane Ohio South FIPS 3402 Feet  
 2. Data Sources Include: Stantec, AEP, USGS, NAD83  
 3. Background: USGS 7.5 Quadrangles - Five Points, OH (1975)



V:\193706823\193706823\03\_cadd\work\_cadd\work\mxd\seco\_figures\1a1\_eco\_bco\_193706823.mxd - Reviset:2020-12-21 8:56:50 AM

Figures  
January 20, 2021

## **B.2 FIGURE 2 – WETLAND AND WATERBODY DELINEATION MAP**



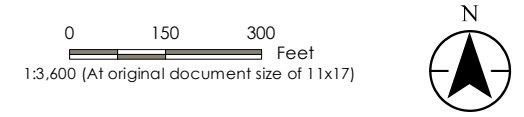

Figure No.  
**2**  
 Title  
**Wetland and Waterbody  
 Delineation Map**

Client/Project  
 AEP Ohio Transmission Company, Inc.  
 Adkins Station Expansion Project

Project Location  
 Pickaway County,  
 Ohio

193706823  
 Prepared by SEC on 2020-12-07  
 Technical Review by JH on 2020-12-14  
 Independent Review by MT on 2020-12-17



- Legend**
- Project Area
  - Photo Locations
  - Wetland Determination Sample Point
  - ▲ Existing Culvert
  - ~ Upland Drainage Feature
  - Field Delineated Emergent Wetland
  - Field Delineated Open Water
  - National Wetlands Inventory Feature\*
  - FEMA Flood Hazard Area\*
    - 100-year Flood Zone
    - 100-year Floodway

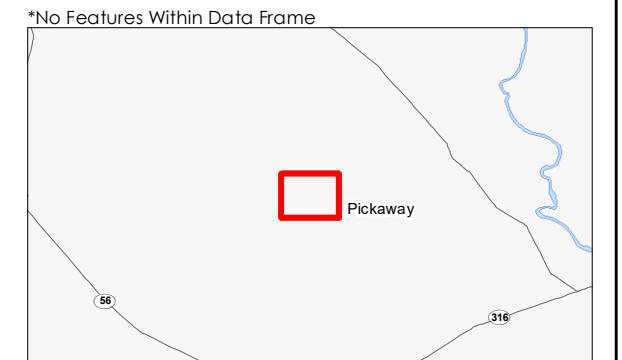

**Notes**

1. Coordinate System: NAD 1983 StatePlane Ohio South FIPS 3402 Feet
2. Data Sources Include: Stantec, AEP, USGS, USFWS, FEMA, NADS, OGRIP
3. Orthophotography: 2019 NAIP



V:\193706823\193706823\_03\_data\work\_cad\wgs\mxd\eco\_figures\Map2\_eco\_an\deets\_193706823.mxd Revised: 2020-12-21 By: cfrico

Figures  
January 20, 2021

### **B.3    FIGURE 3 – HABITAT ASSESSMENT MAP**

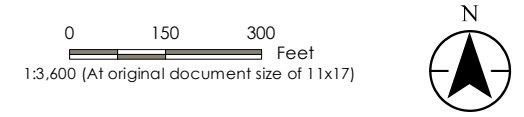



Figure No.  
**3**  
 Title  
**Habitat Assessment Map**

Client/Project  
 AEP Ohio Transmission Company, Inc.  
 Adkins Station Expansion Project

Project Location  
 Pickaway County, Ohio  
 193706823  
 Prepared by SEC on 2020-12-07  
 Technical Review by JH on 2020-12-14  
 Independent Review by MT on 2020-12-17



- Legend**
- Project Area
  - Photo Locations
  - Existing Culvert
  - Upland Drainage Feature
  - Field Delineated Emergent Wetland
  - Field Delineated Open Water
- Habitat Area**
- Agricultural Field
  - Maintained Lawn
  - Old Field
  - Industrial

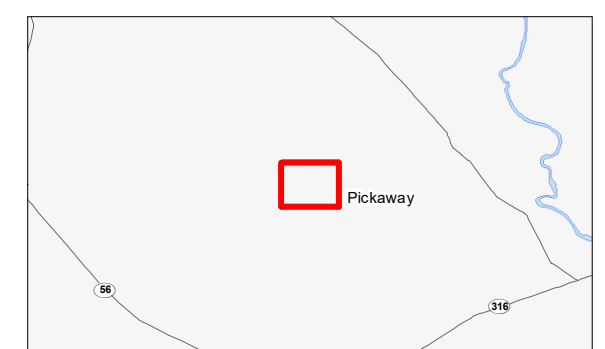

**Notes**

1. Coordinate System: NAD 1983 StatePlane Ohio South FIPS 3402 Feet
2. Data Sources Include: Stantec, AEP, USGS, USFWS, FEMA, NADS, OGRIP
3. Orthophotography: 2019 NAIP



V:\193706823\193706823\_03\_data\ok\_cad\ok\_mxd\eco\_habarea\_193706823.mxd - Revised: 2020-12-21 By: scisco

Disclaimer: Stantec assumes no responsibility for data supplied in electronic format. The recipient accepts full responsibility for verifying the accuracy and completeness of the data. The recipient releases Stantec, its officers, employees, consultants and agents, from any and all claims arising in any way from the content or provision of the data.

Data Form  
January 20, 2021

## Appendix C **DATA FORM**

### C.1 WETLAND DETERMINATION DATA FORMS



**WETLAND DETERMINATION DATA FORM – Midwest Region**

Project/Site: Adkins Station City/County: Pickaway Co. Darby Twp. Sampling Date: 11/18/20  
 Applicant/Owner: AEP State: OH Sampling Point: SP01  
 Investigator(s): A. Sjollema, C.Allen Section, Township, Range: \_\_\_\_\_  
 Landform (hillslope, terrace, etc.): Ditch/Depression Local relief (concave, convex, none): Concave  
 Slope (%): 1% Lat: 39.711535 Long: -83.175816 Datum: \_\_\_\_\_  
 Soil Map Unit Name: Kokomo silty clay loam, 0-2% slopes NWI classification: N/A

Are climatic / hydrologic conditions on the site typical for this time of year? Yes  No \_\_\_\_\_ (If no, explain in Remarks.)  
 Are Vegetation N, Soil N, or Hydrology Y significantly disturbed? Are "Normal Circumstances" present? Yes \_\_\_\_\_ No   
 Are Vegetation N, Soil N, or Hydrology N naturally problematic? (If needed, explain any answers in Remarks.)

**SUMMARY OF FINDINGS – Attach site map showing sampling point locations, transects, important features, etc.**

|  |  |
|--|--|
| Hydrophytic Vegetation Present? Yes <input checked="" type="checkbox"/> No _____<br>Hydric Soil Present? Yes <input checked="" type="checkbox"/> No _____<br>Wetland Hydrology Present? Yes <input checked="" type="checkbox"/> No _____ | Is the Sampled Area within a Wetland? Yes _____ No <input checked="" type="checkbox"/> |
| Remarks: <u>Sample point found within constructed upland drainage feature, with rock check dams affecting hydrology. Drains into existing storm water retention pond.</u>  |  |

**VEGETATION – Use scientific names of plants.**

| Tree Stratum (Plot size: <u>30'</u> )          | Absolute % Cover | Dominant Species? | Indicator Status |   |
|--|------------------|-------------------|------------------|---|
| 1. _____                                       | _____            | _____             | _____            | <b>Dominance Test worksheet:</b><br>Number of Dominant Species That Are OBL, FACW, or FAC: <u>1</u> (A)<br><br>Total Number of Dominant Species Across All Strata: <u>1</u> (B)<br><br>Percent of Dominant Species That Are OBL, FACW, or FAC: <u>100%</u> (A/B)  |
| 2. _____                                       | _____            | _____             | _____            |   |
| 3. _____                                       | _____            | _____             | _____            |   |
| 4. _____                                       | _____            | _____             | _____            |   |
| 5. _____                                       | _____            | _____             | _____            |   |
| _____ = Total Cover                            |                  |                   |                  | <b>Prevalence Index worksheet:</b><br>Total % Cover of: _____ Multiply by: _____<br>OBL species _____ x 1 = _____<br>FACW species _____ x 2 = _____<br>FAC species _____ x 3 = _____<br>FACU species _____ x 4 = _____<br>UPL species _____ x 5 = _____<br>Column Totals: _____ (A) _____ (B)<br><br>Prevalence Index = B/A = _____   |
| Sapling/Shrub Stratum (Plot size: <u>15'</u> ) | Absolute % Cover | Dominant Species? | Indicator Status |   |
| 1. _____                                       | _____            | _____             | _____            |   |
| 2. _____                                       | _____            | _____             | _____            |   |
| 3. _____                                       | _____            | _____             | _____            |   |
| 4. _____                                       | _____            | _____             | _____            |   |
| 5. _____                                       | _____            | _____             | _____            |   |
| _____ = Total Cover                            |                  |                   |                  |   |
| Herb Stratum (Plot size: <u>5'</u> )           | Absolute % Cover | Dominant Species? | Indicator Status | <b>Hydrophytic Vegetation Indicators:</b><br><input checked="" type="checkbox"/> 1 - Rapid Test for Hydrophytic Vegetation<br><input checked="" type="checkbox"/> 2 - Dominance Test is >50%<br><input type="checkbox"/> 3 - Prevalence Index is ≤3.0 <sup>1</sup><br><input type="checkbox"/> 4 - Morphological Adaptations <sup>1</sup> (Provide supporting data in Remarks or on a separate sheet)<br><input type="checkbox"/> Problematic Hydrophytic Vegetation <sup>1</sup> (Explain)<br><br><sup>1</sup> Indicators of hydric soil and wetland hydrology must be present, unless disturbed or problematic. |
| 1. <u>Typha angustifolia</u>                   | <u>85</u>        | <u>Y</u>          | <u>OBL</u>       |   |
| 2. _____                                       | _____            | _____             | _____            |   |
| 3. _____                                       | _____            | _____             | _____            |   |
| 4. _____                                       | _____            | _____             | _____            |   |
| 5. _____                                       | _____            | _____             | _____            |   |
| 6. _____                                       | _____            | _____             | _____            |   |
| 7. _____                                       | _____            | _____             | _____            |   |
| 8. _____                                       | _____            | _____             | _____            |   |
| 9. _____                                       | _____            | _____             | _____            |   |
| 10. _____                                      | _____            | _____             | _____            |   |
| <u>85</u> = Total Cover                        |                  |                   |                  |   |
| Woody Vine Stratum (Plot size: <u>30'</u> )    | Absolute % Cover | Dominant Species? | Indicator Status | <b>Hydrophytic Vegetation Present?</b> Yes <input checked="" type="checkbox"/> No _____   |
| 1. _____                                       | _____            | _____             | _____            |   |
| 2. _____                                       | _____            | _____             | _____            | _____ = Total Cover   |

Remarks: (Include photo numbers here or on a separate sheet.)

15% open ground

**SOIL**

Sampling Point: SP01

| Profile Description: (Describe to the depth needed to document the indicator or confirm the absence of indicators.)   |               |    |   |    |                   |  |         |         |
|---|---------------|----|---|----|-------------------|--|---------|---------|
| Depth (inches)  | Matrix        |    | Redox Features  |    |                   |  | Texture | Remarks |
|   | Color (moist) | %  | Color (moist)   | %  | Type <sup>1</sup> | Loc <sup>2</sup>   |         |         |
| 0-7   | 2.5YR 5/3     | 98 | 10YR 5/6  | 2  | C                 | M  | L       |         |
| 7-20  | 2.5YR 4/1     | 60 | 10YR 5/6  | 38 | C                 | M  | SiC     |         |
|   |               |    | 10YR 2/1  | 2  | D                 | M  | SiC     |         |
|   |               |    |   |    |                   |  |         |         |
|   |               |    |   |    |                   |  |         |         |
|   |               |    |   |    |                   |  |         |         |
|   |               |    |   |    |                   |  |         |         |
|   |               |    |   |    |                   |  |         |         |
| <sup>1</sup> Type: C=Concentration, D=Depletion, RM=Reduced Matrix, MS=Masked Sand Grains.  |               |    |   |    |                   | <sup>2</sup> Location: PL=Pore Lining, M=Matrix.   |         |         |
| <b>Hydric Soil Indicators:</b>  |               |    |   |    |                   | <b>Indicators for Problematic Hydric Soils<sup>3</sup>:</b>  |         |         |
| <input type="checkbox"/> Histosol (A1)<br><input type="checkbox"/> Histic Epipedon (A2)<br><input type="checkbox"/> Black Histic (A3)<br><input type="checkbox"/> Hydrogen Sulfide (A4)<br><input type="checkbox"/> Stratified Layers (A5)<br><input type="checkbox"/> 2 cm Muck (A10)<br><input type="checkbox"/> Depleted Below Dark Surface (A11)<br><input type="checkbox"/> Thick Dark Surface (A12)<br><input type="checkbox"/> Sandy Mucky Mineral (S1)<br><input type="checkbox"/> 5 cm Mucky Peat or Peat (S3) |               |    | <input type="checkbox"/> Sandy Gleyed Matrix (S4)<br><input type="checkbox"/> Sandy Redox (S5)<br><input type="checkbox"/> Stripped Matrix (S6)<br><input type="checkbox"/> Loamy Mucky Mineral (F1)<br><input type="checkbox"/> Loamy Gleyed Matrix (F2)<br><input checked="" type="checkbox"/> Depleted Matrix (F3)<br><input type="checkbox"/> Redox Dark Surface (F6)<br><input type="checkbox"/> Depleted Dark Surface (F7)<br><input type="checkbox"/> Redox Depressions (F8) |    |                   | <input type="checkbox"/> Coast Prairie Redox (A16)<br><input type="checkbox"/> Dark Surface (S7)<br><input type="checkbox"/> Iron-Manganese Masses (F12)<br><input type="checkbox"/> Very Shallow Dark Surface (TF12)<br><input type="checkbox"/> Other (Explain in Remarks) |         |         |
| <b>Restrictive Layer (if observed):</b>   |               |    |   |    |                   |  |         |         |
| Type: <u>N/A</u>  |               |    |   |    |                   |  |         |         |
| Depth (Inches): _____   |               |    |   |    |                   | Hydric Soil Present? Yes <input checked="" type="checkbox"/> No <input type="checkbox"/>   |         |         |
| Remarks:  |               |    |   |    |                   |  |         |         |

**HYDROLOGY**

| Wetland Hydrology Indicators:   |   |  |  |
|---|---|--|--|
| Primary Indicators (minimum of one is required: check all that apply)   |   | Secondary Indicators (minimum of two required)   |  |
| <input checked="" type="checkbox"/> Surface Water (A1)  | <input type="checkbox"/> Water-Stained Leaves (B9)                  | <input type="checkbox"/> Surface Soil Cracks (B6)  |  |
| <input checked="" type="checkbox"/> High Water Table (A2)   | <input type="checkbox"/> Aquatic Fauna (B13)                        | <input type="checkbox"/> Drainage Patterns (B10)   |  |
| <input checked="" type="checkbox"/> Saturation (A3)   | <input type="checkbox"/> True Aquatic Plants (B14)                  | <input type="checkbox"/> Dry-Season Water Table (C2)   |  |
| <input type="checkbox"/> Water Marks (B1)   | <input type="checkbox"/> Hydrogen Sulfide Odor (C1)                 | <input type="checkbox"/> Crayfish Burrows (C8)   |  |
| <input type="checkbox"/> Sediment Deposits (B2)   | <input type="checkbox"/> Oxidized Rhizospheres on Living Roots (C3) | <input type="checkbox"/> Saturation Visible on Aerial Imagery (C9)                             |  |
| <input type="checkbox"/> Drift Deposits (B3)  | <input type="checkbox"/> Presence of Reduced Iron (C4)              | <input type="checkbox"/> Stunted or Stressed Plants (D1)                                       |  |
| <input type="checkbox"/> Algal Mat or Crust (B4)  | <input type="checkbox"/> Recent Iron Reduction in Tilled Soils (C6) | <input type="checkbox"/> Geomorphic Position (D2)  |  |
| <input type="checkbox"/> Iron Deposits (B5)   | <input type="checkbox"/> Thin Muck Surface (C7)                     | <input type="checkbox"/> FAC-Neutral Test (D5)   |  |
| <input type="checkbox"/> Inundation Visible on Aerial Imagery (B7)  | <input type="checkbox"/> Gauge or Well Data (D9)                    |  |  |
| <input type="checkbox"/> Sparsely Vegetated Concave Surface (B8)  | <input type="checkbox"/> Other (Explain in Remarks)                 |  |  |
| <b>Field Observations:</b>  |   |  |  |
| Surface Water Present? Yes <input checked="" type="checkbox"/> No <input type="checkbox"/>                          | Depth (inches): <u>0.5"</u>   | Wetland Hydrology Present? Yes <input checked="" type="checkbox"/> No <input type="checkbox"/> |  |
| Water Table Present? Yes <input checked="" type="checkbox"/> No <input type="checkbox"/>                            | Depth (inches): <u>8"</u>   |  |  |
| Saturation Present? (includes capillary fringe) Yes <input checked="" type="checkbox"/> No <input type="checkbox"/> | Depth (inches): <u>6"</u>   |  |  |
| Describe Recorded Data (stream gauge, monitoring well, aerial photos, previous inspections), if available:          |   |  |  |
| Remarks:  |   |  |  |

**WETLAND DETERMINATION DATA FORM – Midwest Region**

Project/Site: Adkins Station City/County: Pickaway Co. Darby Twp. Sampling Date: 11/18/20  
 Applicant/Owner: AEP State: OH Sampling Point: SP02  
 Investigator(s): A. Sjollema, C. Allen Section, Township, Range: \_\_\_\_\_  
 Landform (hillslope, terrace, etc.): Depression Local relief (concave, convex, none): Concave  
 Slope (%): 0% Lat: 39.710863 Long: -83.175834 Datum: \_\_\_\_\_  
 Soil Map Unit Name: Kokomo silty clay loam, 0-2% slopes NWI classification: N/A

Are climatic / hydrologic conditions on the site typical for this time of year? Yes  No \_\_\_\_\_ (If no, explain in Remarks.)  
 Are Vegetation Y, Soil N, or Hydrology N significantly disturbed? Are "Normal Circumstances" present? Yes  No \_\_\_\_\_  
 Are Vegetation N, Soil N, or Hydrology N naturally problematic? (If needed, explain any answers in Remarks.)

**SUMMARY OF FINDINGS – Attach site map showing sampling point locations, transects, important features, etc.**

|  |  |
|--|--|
| Hydrophytic Vegetation Present? Yes <input checked="" type="checkbox"/> No _____<br>Hydric Soil Present? Yes <input checked="" type="checkbox"/> No _____<br>Wetland Hydrology Present? Yes <input checked="" type="checkbox"/> No _____ | Is the Sampled Area within a Wetland? Yes <input checked="" type="checkbox"/> No _____ |
| Remarks: <u>Veg is mowed, drains to man made ditch</u>   |  |

**VEGETATION – Use scientific names of plants.**

| Tree Stratum (Plot size: <u>30'</u> )   | Absolute % Cover | Dominant Species? | Indicator Status |   |  |
|---|------------------|-------------------|------------------|---|--|
| 1. _____  | _____            | _____             | _____            | <b>Dominance Test worksheet:</b><br>Number of Dominant Species That Are OBL, FACW, or FAC: <u>1</u> (A)<br><br>Total Number of Dominant Species Across All Strata: <u>1</u> (B)<br><br>Percent of Dominant Species That Are OBL, FACW, or FAC: <u>100%</u> (A/B)  |  |
| 2. _____  | _____            | _____             | _____            |   |  |
| 3. _____  | _____            | _____             | _____            |   |  |
| 4. _____  | _____            | _____             | _____            |   |  |
| 5. _____  | _____            | _____             | _____            |   |  |
| _____ = Total Cover   |                  |                   |                  | <b>Prevalence Index worksheet:</b><br>Total % Cover of: _____ Multiply by: _____<br>OBL species _____ x 1 = _____<br>FACW species _____ x 2 = _____<br>FAC species _____ x 3 = _____<br>FACU species _____ x 4 = _____<br>UPL species _____ x 5 = _____<br>Column Totals: _____ (A) _____ (B)<br><br>Prevalence Index = B/A = _____ |  |
| Sapling/Shrub Stratum (Plot size: <u>15'</u> )  | Absolute % Cover | Dominant Species? | Indicator Status |   |  |
| 1. _____  | _____            | _____             | _____            |   |  |
| 2. _____  | _____            | _____             | _____            |   |  |
| 3. _____  | _____            | _____             | _____            |   |  |
| 4. _____  | _____            | _____             | _____            |   |  |
| 5. _____  | _____            | _____             | _____            |   |  |
| _____ = Total Cover   |                  |                   |                  |   |  |
| Herb Stratum (Plot size: <u>5'</u> )  | Absolute % Cover | Dominant Species? | Indicator Status |   |  |
| 1. <u>Typha angustifolia</u>  | <u>100</u>       | <u>Y</u>          | <u>OBL</u>       |   |  |
| 2. _____  | _____            | _____             | _____            |   |  |
| 3. _____  | _____            | _____             | _____            |   |  |
| 4. _____  | _____            | _____             | _____            |   |  |
| 5. _____  | _____            | _____             | _____            |   |  |
| 6. _____  | _____            | _____             | _____            |   |  |
| 7. _____  | _____            | _____             | _____            |   |  |
| 8. _____  | _____            | _____             | _____            |   |  |
| 9. _____  | _____            | _____             | _____            |   |  |
| 10. _____   | _____            | _____             | _____            |   |  |
| _____ = Total Cover   |                  |                   |                  |   |  |
| Woody Vine Stratum (Plot size: <u>30'</u> )   | Absolute % Cover | Dominant Species? | Indicator Status |   |  |
| 1. _____  | _____            | _____             | _____            |   |  |
| 2. _____  | _____            | _____             | _____            |   |  |
| _____ = Total Cover   |                  |                   |                  |   |  |
| Remarks: (Include photo numbers here or on a separate sheet.)<br><u>Typha has been recently mowed. Other veg includes P. capillare, S. pumila, C. frankii</u> |                  |                   |                  | <b>Hydrophytic Vegetation Present?</b> Yes <input checked="" type="checkbox"/> No _____   |  |

**SOIL**Sampling Point: SP02

| Profile Description: (Describe to the depth needed to document the indicator or confirm the absence of indicators.) |               |    |                |   |                   |                  |         |         |
|---|---------------|----|----------------|---|-------------------|------------------|---------|---------|
| Depth (inches)  | Matrix        |    | Redox Features |   |                   |                  | Texture | Remarks |
|   | Color (moist) | %  | Color (moist)  | % | Type <sup>1</sup> | Loc <sup>2</sup> |         |         |
| 0-3   | 2.5Y 3/2      | 30 | 2.5Y 5/4       | 4 | C                 | M                | SiC     |         |
|   | 2.5Y 4/2      | 66 |                |   |                   |                  |         |         |
| 3-16  | 2.5Y 3/2      | 65 | 2.5Y 5/4       | 5 | C                 | M                | SiC     |         |
|   | 2.5Y 4/2      | 30 |                |   |                   |                  |         |         |
| 16-20   | 2.5Y 3/2      | 50 | 10YR 3/6       | 3 | C                 | M                | SiC     |         |
|   | 2.5Y 4/2      | 47 |                |   |                   |                  |         |         |

<sup>1</sup>Type: C=Concentration, D=Depletion, RM=Reduced Matrix, MS=Masked Sand Grains. <sup>2</sup>Location: PL=Pore Lining, M=Matrix.

|  |   |  |   |  |   |
|--|---|--|---|--|---|
| <b>Hydric Soil Indicators:</b>                             |   |  | <b>Indicators for Problematic Hydric Soils<sup>3</sup>:</b> |  |   |
| <input type="checkbox"/> Histosol (A1)                     | <input type="checkbox"/> Sandy Gleyed Matrix (S4) | <input type="checkbox"/> Coast Prairie Redox (A16)   | <input type="checkbox"/> Histic Epipedon (A2)               | <input type="checkbox"/> Sandy Redox (S5)                | <input type="checkbox"/> Dark Surface (S7)                |
| <input type="checkbox"/> Black Histic (A3)                 | <input type="checkbox"/> Stripped Matrix (S6)     | <input type="checkbox"/> Iron-Manganese Masses (F12) | <input type="checkbox"/> Hydrogen Sulfide (A4)              | <input type="checkbox"/> Loamy Mucky Mineral (F1)        | <input type="checkbox"/> Very Shallow Dark Surface (TF12) |
| <input type="checkbox"/> Stratified Layers (A5)            | <input type="checkbox"/> Loamy Gleyed Matrix (F2) | <input type="checkbox"/> Other (Explain in Remarks)  | <input type="checkbox"/> 2 cm Muck (A10)                    | <input checked="" type="checkbox"/> Depleted Matrix (F3) |   |
| <input type="checkbox"/> Depleted Below Dark Surface (A11) | <input type="checkbox"/> Redox Dark Surface (F6)  |  | <input type="checkbox"/> Thick Dark Surface (A12)           | <input type="checkbox"/> Depleted Dark Surface (F7)      |   |
| <input type="checkbox"/> Sandy Mucky Mineral (S1)          | <input type="checkbox"/> Redox Depressions (F8)   |  | <input type="checkbox"/> 5 cm Mucky Peat or Peat (S3)       |  |   |

<sup>3</sup>Indicators of hydrophytic vegetation and wetland hydrology must be present, unless disturbed or problematic.

|  |  |   |
|--|--|---|
| <b>Restrictive Layer (if observed):</b><br>Type: <u>N/A</u><br>Depth (Inches): _____ |  | <b>Hydric Soil Present?</b> Yes <input checked="" type="checkbox"/> No <input type="checkbox"/> |
|--|--|---|

Remarks: \_\_\_\_\_

**HYDROLOGY**

| Wetland Hydrology Indicators:   |  |
|---|--|
| Primary Indicators (minimum of one is required: check all that apply) | Secondary Indicators (minimum of two required)                     |
| <input type="checkbox"/> Surface Water (A1)                           | <input type="checkbox"/> Surface Soil Cracks (B6)                  |
| <input type="checkbox"/> High Water Table (A2)                        | <input type="checkbox"/> Drainage Patterns (B10)                   |
| <input type="checkbox"/> Saturation (A3)                              | <input type="checkbox"/> Dry-Season Water Table (C2)               |
| <input type="checkbox"/> Water Marks (B1)                             | <input type="checkbox"/> Crayfish Burrows (C8)                     |
| <input type="checkbox"/> Sediment Deposits (B2)                       | <input type="checkbox"/> Saturation Visible on Aerial Imagery (C9) |
| <input type="checkbox"/> Drift Deposits (B3)                          | <input type="checkbox"/> Stunted or Stressed Plants (D1)           |
| <input type="checkbox"/> Algal Mat or Crust (B4)                      | <input checked="" type="checkbox"/> Geomorphic Position (D2)       |
| <input type="checkbox"/> Iron Deposits (B5)                           | <input checked="" type="checkbox"/> FAC-Neutral Test (D5)          |
| <input type="checkbox"/> Inundation Visible on Aerial Imagery (B7)    | <input type="checkbox"/> Other (Explain in Remarks)                |
| <input type="checkbox"/> Sparsely Vegetated Concave Surface (B8)      |  |

|  |                       |   |
|--|-----------------------|---|
| <b>Field Observations:</b>   |                       | <b>Wetland Hydrology Present?</b> Yes <input checked="" type="checkbox"/> No <input type="checkbox"/> |
| Surface Water Present? Yes <input type="checkbox"/> No <input checked="" type="checkbox"/> | Depth (inches): _____ |   |
| Water Table Present? Yes <input type="checkbox"/> No <input checked="" type="checkbox"/>   | Depth (inches): _____ |   |
| Saturation Present? Yes <input type="checkbox"/> No <input checked="" type="checkbox"/>    | Depth (inches): _____ |   |

(includes capillary fringe)

Describe Recorded Data (stream gauge, monitoring well, aerial photos, previous inspections), if available:

Remarks: \_\_\_\_\_



**WETLAND DETERMINATION DATA FORM – Midwest Region**

Project/Site: Adkins Station City/County: Pickaway Co. Darby Twp. Sampling Date: 11/18/20  
 Applicant/Owner: AEP State: OH Sampling Point: SP03  
 Investigator(s): A. Sjollema, C.Allen Section, Township, Range: \_\_\_\_\_  
 Landform (hillslope, terrace, etc.): Terrace Local relief (concave, convex, none): None  
 Slope (%): 1% Lat: 39.710824 Long: -83.175768 Datum: \_\_\_\_\_  
 Soil Map Unit Name: Kokomo silty clay loam, 0-2% slopes NWI classification: N/A

Are climatic / hydrologic conditions on the site typical for this time of year? Yes  No \_\_\_\_\_ (If no, explain in Remarks.)  
 Are Vegetation N, Soil N, or Hydrology N significantly disturbed? Are "Normal Circumstances" present? Yes  No \_\_\_\_\_  
 Are Vegetation N, Soil N, or Hydrology N naturally problematic? (If needed, explain any answers in Remarks.)

**SUMMARY OF FINDINGS – Attach site map showing sampling point locations, transects, important features, etc.**

|  |  |
|--|--|
| Hydrophytic Vegetation Present? Yes _____ No <input checked="" type="checkbox"/><br>Hydric Soil Present? Yes _____ No <input checked="" type="checkbox"/><br>Wetland Hydrology Present? Yes _____ No <input checked="" type="checkbox"/> | Is the Sampled Area within a Wetland? Yes _____ No <input checked="" type="checkbox"/> |
| Remarks: _____<br>_____<br>_____   |  |

**VEGETATION – Use scientific names of plants.**

| Tree Stratum (Plot size: <u>30'</u> )   | Absolute % Cover | Dominant Species? | Indicator Status |   |
|---|------------------|-------------------|------------------|---|
| 1. _____  | _____            | _____             | _____            | <b>Dominance Test worksheet:</b><br>Number of Dominant Species That Are OBL, FACW, or FAC: <u>1</u> (A)<br><br>Total Number of Dominant Species Across All Strata: <u>2</u> (B)<br><br>Percent of Dominant Species That Are OBL, FACW, or FAC: <u>50%</u> (A/B)   |
| 2. _____  | _____            | _____             | _____            |   |
| 3. _____  | _____            | _____             | _____            |   |
| 4. _____  | _____            | _____             | _____            |   |
| 5. _____  | _____            | _____             | _____            |   |
| _____ = Total Cover   |                  |                   |                  | <b>Prevalence Index worksheet:</b><br>Total % Cover of: _____ Multiply by: _____<br>OBL species _____ x 1 = _____<br>FACW species _____ x 2 = _____<br>FAC species <u>65</u> x 3 = <u>195</u><br>FACU species <u>35</u> x 4 = <u>140</u><br>UPL species _____ x 5 = _____<br>Column Totals: <u>100</u> (A) <u>335</u> (B)<br><br>Prevalence Index = B/A = <u>3.35</u> |
| <b>Sapling/Shrub Stratum (Plot size: <u>15'</u>)</b>                            |                  |                   |                  |   |
| 1. _____  | _____            | _____             | _____            |   |
| 2. _____  | _____            | _____             | _____            |   |
| 3. _____  | _____            | _____             | _____            |   |
| 4. _____  | _____            | _____             | _____            |   |
| 5. _____  | _____            | _____             | _____            |   |
| _____ = Total Cover   |                  |                   |                  |   |
| <b>Herb Stratum (Plot size: <u>5'</u>)</b>                                      |                  |                   |                  |   |
| 1. <u>Setaria pumila</u>  | <u>65</u>        | <u>Y</u>          | <u>FAC</u>       | <b>Hydrophytic Vegetation Indicators:</b><br>___ 1 - Rapid Test for Hydrophytic Vegetation<br>___ 2 - Dominance Test is >50%<br>___ 3 - Prevalence Index is ≤3.0 <sup>1</sup><br>___ 4 - Morphological Adaptations <sup>1</sup> (Provide supporting data in Remarks or on a separate sheet)<br>___ Problematic Hydrophytic Vegetation <sup>1</sup> (Explain)          |
| 2. <u>Sorghastrum nutans</u>  | <u>25</u>        | <u>Y</u>          | <u>FACU</u>      |   |
| 3. <u>Solidago canadensis</u>   | <u>10</u>        | <u>N</u>          | <u>FACU</u>      |   |
| 4. _____  | _____            | _____             | _____            |   |
| 5. _____  | _____            | _____             | _____            |   |
| 6. _____  | _____            | _____             | _____            |   |
| 7. _____  | _____            | _____             | _____            |   |
| 8. _____  | _____            | _____             | _____            |   |
| 9. _____  | _____            | _____             | _____            |   |
| 10. _____   | _____            | _____             | _____            |   |
| <u>100</u> = Total Cover  |                  |                   |                  |   |
| <b>Woody Vine Stratum (Plot size: <u>30'</u>)</b>                               |                  |                   |                  |   |
| 1. _____  | _____            | _____             | _____            |   |
| 2. _____  | _____            | _____             | _____            |   |
| _____ = Total Cover   |                  |                   |                  |   |
| Remarks: (Include photo numbers here or on a separate sheet.)<br>_____<br>_____ |                  |                   |                  |   |

**SOIL**

Sampling Point: SP03

| Profile Description: (Describe to the depth needed to document the indicator or confirm the absence of indicators.)   |               |    |  |   |                   |  |         |         |
|---|---------------|----|--|---|-------------------|--|---------|---------|
| Depth (inches)  | Matrix        |    | Redox Features   |   |                   |  | Texture | Remarks |
|   | Color (moist) | %  | Color (moist)  | % | Type <sup>1</sup> | Loc <sup>2</sup>   |         |         |
| 0-3   | 10YR 3/2      | 95 | 10YR 5/6   | 5 | C                 | M  | SiC     |         |
| 3-15  | 10YR 5/6      | 50 | 7.5YR 5/8  | 5 | C                 | M  | SiC     |         |
|   | 10YR 3/2      | 45 |  |   |                   |  |         |         |
| 15-20   | 10YR 3/1      | 50 | 10YR 5/6   | 4 | C                 | M  | SiC     |         |
|   | 10YR 4/2      | 46 |  |   |                   |  |         |         |
|   |               |    |  |   |                   |  |         |         |
|   |               |    |  |   |                   |  |         |         |
|   |               |    |  |   |                   |  |         |         |
| <sup>1</sup> Type: C=Concentration, D=Depletion, RM=Reduced Matrix, MS=Masked Sand Grains.  |               |    |  |   |                   | <sup>2</sup> Location: PL=Pore Lining, M=Matrix.   |         |         |
| <b>Hydric Soil Indicators:</b>  |               |    |  |   |                   | <b>Indicators for Problematic Hydric Soils<sup>3</sup>:</b>  |         |         |
| <input type="checkbox"/> Histosol (A1)<br><input type="checkbox"/> Histic Epipedon (A2)<br><input type="checkbox"/> Black Histic (A3)<br><input type="checkbox"/> Hydrogen Sulfide (A4)<br><input type="checkbox"/> Stratified Layers (A5)<br><input type="checkbox"/> 2 cm Muck (A10)<br><input type="checkbox"/> Depleted Below Dark Surface (A11)<br><input type="checkbox"/> Thick Dark Surface (A12)<br><input type="checkbox"/> Sandy Mucky Mineral (S1)<br><input type="checkbox"/> 5 cm Mucky Peat or Peat (S3) |               |    | <input type="checkbox"/> Sandy Gleyed Matrix (S4)<br><input type="checkbox"/> Sandy Redox (S5)<br><input type="checkbox"/> Stripped Matrix (S6)<br><input type="checkbox"/> Loamy Mucky Mineral (F1)<br><input type="checkbox"/> Loamy Gleyed Matrix (F2)<br><input type="checkbox"/> Depleted Matrix (F3)<br><input type="checkbox"/> Redox Dark Surface (F6)<br><input type="checkbox"/> Depleted Dark Surface (F7)<br><input type="checkbox"/> Redox Depressions (F8) |   |                   | <input type="checkbox"/> Coast Prairie Redox (A16)<br><input type="checkbox"/> Dark Surface (S7)<br><input type="checkbox"/> Iron-Manganese Masses (F12)<br><input type="checkbox"/> Very Shallow Dark Surface (TF12)<br><input type="checkbox"/> Other (Explain in Remarks) |         |         |
| <b>Restrictive Layer (if observed):</b>   |               |    |  |   |                   |  |         |         |
| Type: <u>N/A</u>  |               |    |  |   |                   |  |         |         |
| Depth (Inches): _____   |               |    |  |   |                   | <b>Hydric Soil Present?</b> Yes _____ No <input checked="" type="checkbox"/>   |         |         |
| Remarks:  |               |    |  |   |                   |  |         |         |

**HYDROLOGY**

| Wetland Hydrology Indicators:  |   |  |  |
|--|---|--|--|
| Primary Indicators (minimum of one is required: check all that apply)                                      |   | Secondary Indicators (minimum of two required)                                     |  |
| <input type="checkbox"/> Surface Water (A1)  | <input type="checkbox"/> Water-Stained Leaves (B9)                  | <input type="checkbox"/> Surface Soil Cracks (B6)                                  |  |
| <input type="checkbox"/> High Water Table (A2)   | <input type="checkbox"/> Aquatic Fauna (B13)                        | <input type="checkbox"/> Drainage Patterns (B10)                                   |  |
| <input type="checkbox"/> Saturation (A3)   | <input type="checkbox"/> True Aquatic Plants (B14)                  | <input type="checkbox"/> Dry-Season Water Table (C2)                               |  |
| <input type="checkbox"/> Water Marks (B1)  | <input type="checkbox"/> Hydrogen Sulfide Odor (C1)                 | <input type="checkbox"/> Crayfish Burrows (C8)                                     |  |
| <input type="checkbox"/> Sediment Deposits (B2)  | <input type="checkbox"/> Oxidized Rhizospheres on Living Roots (C3) | <input type="checkbox"/> Saturation Visible on Aerial Imagery (C9)                 |  |
| <input type="checkbox"/> Drift Deposits (B3)   | <input type="checkbox"/> Presence of Reduced Iron (C4)              | <input type="checkbox"/> Stunted or Stressed Plants (D1)                           |  |
| <input type="checkbox"/> Algal Mat or Crust (B4)   | <input type="checkbox"/> Recent Iron Reduction in Tilled Soils (C6) | <input type="checkbox"/> Geomorphic Position (D2)                                  |  |
| <input type="checkbox"/> Iron Deposits (B5)  | <input type="checkbox"/> Thin Muck Surface (C7)                     | <input type="checkbox"/> FAC-Neutral Test (D5)                                     |  |
| <input type="checkbox"/> Inundation Visible on Aerial Imagery (B7)   | <input type="checkbox"/> Gauge or Well Data (D9)                    |  |  |
| <input type="checkbox"/> Sparsely Vegetated Concave Surface (B8)   | <input type="checkbox"/> Other (Explain in Remarks)                 |  |  |
| <b>Field Observations:</b>   |   |  |  |
| Surface Water Present?   | Yes _____ No <input checked="" type="checkbox"/>                    | Depth (inches): _____  |  |
| Water Table Present?   | Yes _____ No <input checked="" type="checkbox"/>                    | Depth (inches): _____  |  |
| Saturation Present?<br>(includes capillary fringe)   | Yes _____ No <input checked="" type="checkbox"/>                    | Depth (inches): _____  |  |
|  |   | <b>Wetland Hydrology Present?</b> Yes _____ No <input checked="" type="checkbox"/> |  |
| Describe Recorded Data (stream gauge, monitoring well, aerial photos, previous inspections), if available: |   |  |  |
| Remarks:   |   |  |  |

**WETLAND DETERMINATION DATA FORM – Midwest Region**

Project/Site: Adkins Station City/County: Pickaway Co. Darby Twp. Sampling Date: 11/18/20  
 Applicant/Owner: AEP State: OH Sampling Point: SP04  
 Investigator(s): A. Sjollema, C.Allen Section, Township, Range: \_\_\_\_\_  
 Landform (hillslope, terrace, etc.): Depression/Ditch Local relief (concave, convex, none): Concave  
 Slope (%): 1% Lat: 39.713476 Long: -83.178024 Datum: \_\_\_\_\_  
 Soil Map Unit Name: Crosby silt loam, southern Ohio till plain, 0-2% slopes NWI classification: N/A  
 Are climatic / hydrologic conditions on the site typical for this time of year? Yes  No \_\_\_\_\_ (If no, explain in Remarks.)  
 Are Vegetation N, Soil N, or Hydrology Y significantly disturbed? Are "Normal Circumstances" present? Yes \_\_\_\_\_ No   
 Are Vegetation N, Soil N, or Hydrology N naturally problematic? (If needed, explain any answers in Remarks.)

**SUMMARY OF FINDINGS – Attach site map showing sampling point locations, transects, important features, etc.**

|  |  |
|--|--|
| Hydrophytic Vegetation Present? Yes <input checked="" type="checkbox"/> No _____<br>Hydric Soil Present? Yes <input checked="" type="checkbox"/> No _____<br>Wetland Hydrology Present? Yes <input checked="" type="checkbox"/> No _____ | Is the Sampled Area within a Wetland? Yes _____ No <input checked="" type="checkbox"/> |
| Remarks: <u>Sample point found within constructed upland drainage feature, surrounded by gravel.</u>   |  |

**VEGETATION – Use scientific names of plants.**

| Tree Stratum (Plot size: <u>30'</u> )                         | Absolute % Cover | Dominant Species? | Indicator Status |   |  |
|---|------------------|-------------------|------------------|---|--|
| 1. _____  | _____            | _____             | _____            | <b>Dominance Test worksheet:</b><br>Number of Dominant Species That Are OBL, FACW, or FAC: <u>2</u> (A)<br><br>Total Number of Dominant Species Across All Strata: <u>2</u> (B)<br><br>Percent of Dominant Species That Are OBL, FACW, or FAC: <u>100%</u> (A/B)  |  |
| 2. _____  | _____            | _____             | _____            |   |  |
| 3. _____  | _____            | _____             | _____            |   |  |
| 4. _____  | _____            | _____             | _____            |   |  |
| 5. _____  | _____            | _____             | _____            |   |  |
| _____ = Total Cover   |                  |                   |                  | <b>Prevalence Index worksheet:</b><br>Total % Cover of: _____ Multiply by: _____<br>OBL species _____ x 1 = _____<br>FACW species _____ x 2 = _____<br>FAC species _____ x 3 = _____<br>FACU species _____ x 4 = _____<br>UPL species _____ x 5 = _____<br>Column Totals: _____ (A) _____ (B)<br><br>Prevalence Index = B/A = _____ |  |
| Sapling/Shrub Stratum (Plot size: <u>15'</u> )                | Absolute % Cover | Dominant Species? | Indicator Status |   |  |
| 1. _____  | _____            | _____             | _____            |   |  |
| 2. _____  | _____            | _____             | _____            |   |  |
| 3. _____  | _____            | _____             | _____            |   |  |
| 4. _____  | _____            | _____             | _____            |   |  |
| 5. _____  | _____            | _____             | _____            |   |  |
| _____ = Total Cover   |                  |                   |                  |   |  |
| Herb Stratum (Plot size: <u>5'</u> )                          | Absolute % Cover | Dominant Species? | Indicator Status |   |  |
| 1. <u>Panicum caprillare</u>                                  | <u>45</u>        | <u>Y</u>          | <u>FAC</u>       |   |  |
| 2. <u>Setaria pumila</u>                                      | <u>5</u>         | <u>Y</u>          | <u>FAC</u>       |   |  |
| 3. _____  | _____            | _____             | _____            |   |  |
| 4. _____  | _____            | _____             | _____            |   |  |
| 5. _____  | _____            | _____             | _____            |   |  |
| 6. _____  | _____            | _____             | _____            |   |  |
| 7. _____  | _____            | _____             | _____            |   |  |
| 8. _____  | _____            | _____             | _____            |   |  |
| 9. _____  | _____            | _____             | _____            |   |  |
| 10. _____   | _____            | _____             | _____            |   |  |
| <u>100</u> = Total Cover                                      |                  |                   |                  |   |  |
| Woody Vine Stratum (Plot size: <u>30'</u> )                   | Absolute % Cover | Dominant Species? | Indicator Status |   |  |
| 1. _____  | _____            | _____             | _____            |   |  |
| 2. _____  | _____            | _____             | _____            |   |  |
| _____ = Total Cover   |                  |                   |                  |   |  |
| Remarks: (Include photo numbers here or on a separate sheet.) |                  |                   |                  | <b>Hydrophytic Vegetation Present?</b> Yes <input checked="" type="checkbox"/> No _____   |  |

**SOIL**

Sampling Point: SP04

| Profile Description: (Describe to the depth needed to document the indicator or confirm the absence of indicators.)   |               |    |   |   |   |  |         |         |
|---|---------------|----|---|---|---|--|---------|---------|
| Depth (inches)  | Matrix        |    | Redox Features  |   |   |  | Texture | Remarks |
|   | Color (moist) | %  | Color (moist)   | % | Type <sup>1</sup>   | Loc <sup>2</sup>   |         |         |
| 0-14  | 10YR 3/2      | 95 | 5YR 3/4   | 3 | C   | PL   | SiC     |         |
|   |               |    | 5YR 4/6   | 2 | C   | M  |         |         |
| 14-20   | 10YR 3/2      | 94 | 5YR 3/4   | 3 | C   | PL   | SiC     |         |
|   |               |    | 10YR 6/6  | 3 | C   | M  |         |         |
|   |               |    |   |   |   |  |         |         |
|   |               |    |   |   |   |  |         |         |
|   |               |    |   |   |   |  |         |         |
|   |               |    |   |   |   |  |         |         |
| <sup>1</sup> Type: C=Concentration, D=Depletion, RM=Reduced Matrix, MS=Masked Sand Grains.  |               |    |   |   | <sup>2</sup> Location: PL=Pore Lining, M=Matrix.  |  |         |         |
| <b>Hydric Soil Indicators:</b>  |               |    | <b>Indicators for Problematic Hydric Soils<sup>3</sup>:</b>   |   |   |  |         |         |
| <input type="checkbox"/> Histosol (A1)<br><input type="checkbox"/> Histic Epipedon (A2)<br><input type="checkbox"/> Black Histic (A3)<br><input type="checkbox"/> Hydrogen Sulfide (A4)<br><input type="checkbox"/> Stratified Layers (A5)<br><input type="checkbox"/> 2 cm Muck (A10)<br><input type="checkbox"/> Depleted Below Dark Surface (A11)<br><input type="checkbox"/> Thick Dark Surface (A12)<br><input type="checkbox"/> Sandy Mucky Mineral (S1)<br><input type="checkbox"/> 5 cm Mucky Peat or Peat (S3) |               |    | <input type="checkbox"/> Sandy Gleyed Matrix (S4)<br><input type="checkbox"/> Sandy Redox (S5)<br><input type="checkbox"/> Stripped Matrix (S6)<br><input type="checkbox"/> Loamy Mucky Mineral (F1)<br><input type="checkbox"/> Loamy Gleyed Matrix (F2)<br><input type="checkbox"/> Depleted Matrix (F3)<br><input checked="" type="checkbox"/> Redox Dark Surface (F6)<br><input type="checkbox"/> Depleted Dark Surface (F7)<br><input type="checkbox"/> Redox Depressions (F8) |   |   | <input type="checkbox"/> Coast Prairie Redox (A16)<br><input type="checkbox"/> Dark Surface (S7)<br><input type="checkbox"/> Iron-Manganese Masses (F12)<br><input type="checkbox"/> Very Shallow Dark Surface (TF12)<br><input type="checkbox"/> Other (Explain in Remarks) |         |         |
| <b>Restrictive Layer (if observed):</b>   |               |    |   |   | <b>Hydric Soil Present?</b> Yes <input checked="" type="checkbox"/> No <input type="checkbox"/> |  |         |         |
| Type: <u>N/A</u><br>Depth (inches): _____   |               |    |   |   |   |  |         |         |
| Remarks:<br>parts of ditch does not have soils  |               |    |   |   |   |  |         |         |

**HYDROLOGY**

| Wetland Hydrology Indicators:   |  |   |
|---|--|---|
| Primary Indicators (minimum of one is required; check all that apply)   |  | Secondary Indicators (minimum of two required)  |
| <input type="checkbox"/> Surface Water (A1)   | <input type="checkbox"/> Water-Stained Leaves (B9)                             | <input type="checkbox"/> Surface Soil Cracks (B6)   |
| <input type="checkbox"/> High Water Table (A2)  | <input type="checkbox"/> Aquatic Fauna (B13)                                   | <input type="checkbox"/> Drainage Patterns (B10)  |
| <input type="checkbox"/> Saturation (A3)  | <input type="checkbox"/> True Aquatic Plants (B14)                             | <input type="checkbox"/> Dry-Season Water Table (C2)  |
| <input type="checkbox"/> Water Marks (B1)   | <input type="checkbox"/> Hydrogen Sulfide Odor (C1)                            | <input type="checkbox"/> Crayfish Burrows (C8)  |
| <input type="checkbox"/> Sediment Deposits (B2)   | <input checked="" type="checkbox"/> Oxidized Rhizospheres on Living Roots (C3) | <input type="checkbox"/> Saturation Visible on Aerial Imagery (C9)                                    |
| <input type="checkbox"/> Drift Deposits (B3)  | <input type="checkbox"/> Presence of Reduced Iron (C4)                         | <input type="checkbox"/> Stunted or Stressed Plants (D1)  |
| <input type="checkbox"/> Algal Mat or Crust (B4)  | <input type="checkbox"/> Recent Iron Reduction in Tilled Soils (C6)            | <input checked="" type="checkbox"/> Geomorphic Position (D2)  |
| <input type="checkbox"/> Iron Deposits (B5)   | <input type="checkbox"/> Thin Muck Surface (C7)                                | <input type="checkbox"/> FAC-Neutral Test (D5)  |
| <input type="checkbox"/> Inundation Visible on Aerial Imagery (B7)  | <input type="checkbox"/> Gauge or Well Data (D9)                               |   |
| <input type="checkbox"/> Sparsely Vegetated Concave Surface (B8)  | <input type="checkbox"/> Other (Explain in Remarks)                            |   |
| <b>Field Observations:</b>  |  | <b>Wetland Hydrology Present?</b> Yes <input checked="" type="checkbox"/> No <input type="checkbox"/> |
| Surface Water Present? Yes <input type="checkbox"/> No <input checked="" type="checkbox"/> Depth (inches): _____<br>Water Table Present? Yes <input type="checkbox"/> No <input checked="" type="checkbox"/> Depth (inches): _____<br>Saturation Present? (includes capillary fringe) Yes <input type="checkbox"/> No <input checked="" type="checkbox"/> Depth (inches): _____ |  |   |
| Describe Recorded Data (stream gauge, monitoring well, aerial photos, previous inspections), if available:  |  |   |
| Remarks:  |  |   |

**ADKINS STATION EXPANSION PROJECT, PICKAWAY COUNTY, OHIO**

Data Form  
January 20, 2021

**C.2 ORAM DATA FORMS**

|                    |  |  |
|--------------------|--|--|
| <b>Version 5.0</b> | <b>Ohio Rapid Assessment Method for Wetlands<br/>10 Page Form for Wetland Categorization</b>   |  |
|                    | <b>Background Information</b><br><b>Scoring Boundary Worksheet</b><br><b>Narrative Rating</b><br><b>Field Form Quantitative Rating</b><br><b>ORAM Summary Worksheet</b><br><b>Wetland Categorization Worksheet</b> | Ohio EPA, Division of Surface Water<br>Final: February 1, 2001 |

### Instructions

The investigator is *STRONGLY URGED* to read the Manual for Using the Ohio Rapid Assessment Method for Wetlands for further elaboration and discussion of the questions below prior to using the rating forms.

The Narrative Rating is designed to categorize a wetland or to provide alerts to the Rater based on the presence or possible presence of threatened or endangered species. The presence or proximity of such species is often an indicator of the quality and lack of disturbance of the wetland being evaluated. In addition, it is designed to categorize certain wetlands as very low quality (Category 1) or very high quality (Category 3) regardless of the wetland's score on the Quantitative Rating. In addition, the Narrative Rating also alerts the investigator that a particular wetland *may* be a Category 3 wetland, again, regardless of the wetland's score on the Quantitative Rating.

It is *VERY IMPORTANT* to properly and thoroughly answer each of the questions in the ORAM in order to properly categorize a wetland. To *properly* answer all the questions, the boundaries of the wetland being assessed must be correctly identified. Refer to Scoring Boundary worksheet and the User's Manual for a discussion of how to determine the "scoring boundaries." In some instances, the scoring boundaries may differ from the "jurisdictional boundaries."

Refer to the most recent ORAM Score Calibration Report for the scoring breakpoints between wetland categories. The most recent version of this document is posted on Ohio EPA's Division of Surface Water web page at: <http://www.epa.ohio.gov/dsw/wetlands/WetlandEcologySection.aspx>



### Background Information

|  |  |
|--|--|
| <b>Name:</b>   | Angela Sjollema  |
| <b>Date:</b>   | 11/18/20   |
| <b>Affiliation:</b>  | Stantec  |
| <b>Address:</b>  | 1500 Lake Shore Drive Suite 100, Columbus, OH 43204  |
| <b>Phone Number:</b>   | 614-486-4383   |
| <b>e-mail address:</b>   | angela.sjollema@stantec.com  |
| <b>Name of Wetland:</b>  | Wetland 1  |
| <b>Vegetation Communit(ies):</b>   | PEM  |
| <b>HGM Class(es):</b>  | Depression   |
| <b>Location of Wetland: include map, address, north arrow, landmarks, distances, roads, etc.</b> | <p>A hand-drawn map showing a corner of a property. A vertical line on the left and a horizontal line on the top represent boundaries. A diagonal line from the bottom-left corner to the top-right corner is labeled 'Adkins Rd'. A horizontal line extending from the top-right corner to the right is labeled 'Drummond Rd'. A star symbol is placed near the intersection of Adkins Rd and a vertical line, with the text '* Darby Power' written next to it. A north arrow is drawn in the top-left corner of the map area.</p> |
| <b>Lat/Long or UTM Coordinate</b>  | 39.710958, -83.175773  |
| <b>USGS Quad Name</b>  | Five Points  |
| <b>County</b>  | Pickaway   |
| <b>Township</b>  | Darby  |
| <b>Section and Subsection</b>  | N/A  |
| <b>Hydrologic Unit Code</b>  | 050600020301   |
| <b>Site Visit</b>  | 11/18/20   |
| <b>National Wetland Inventory Map</b>  | Yes  |
| <b>Ohio Wetland Inventory Map</b>  | No   |
| <b>Soil Survey</b>   | NRCS Pickaway County   |
| <b>Delineation report/map</b>  | Figure 4, Ecological Report  |

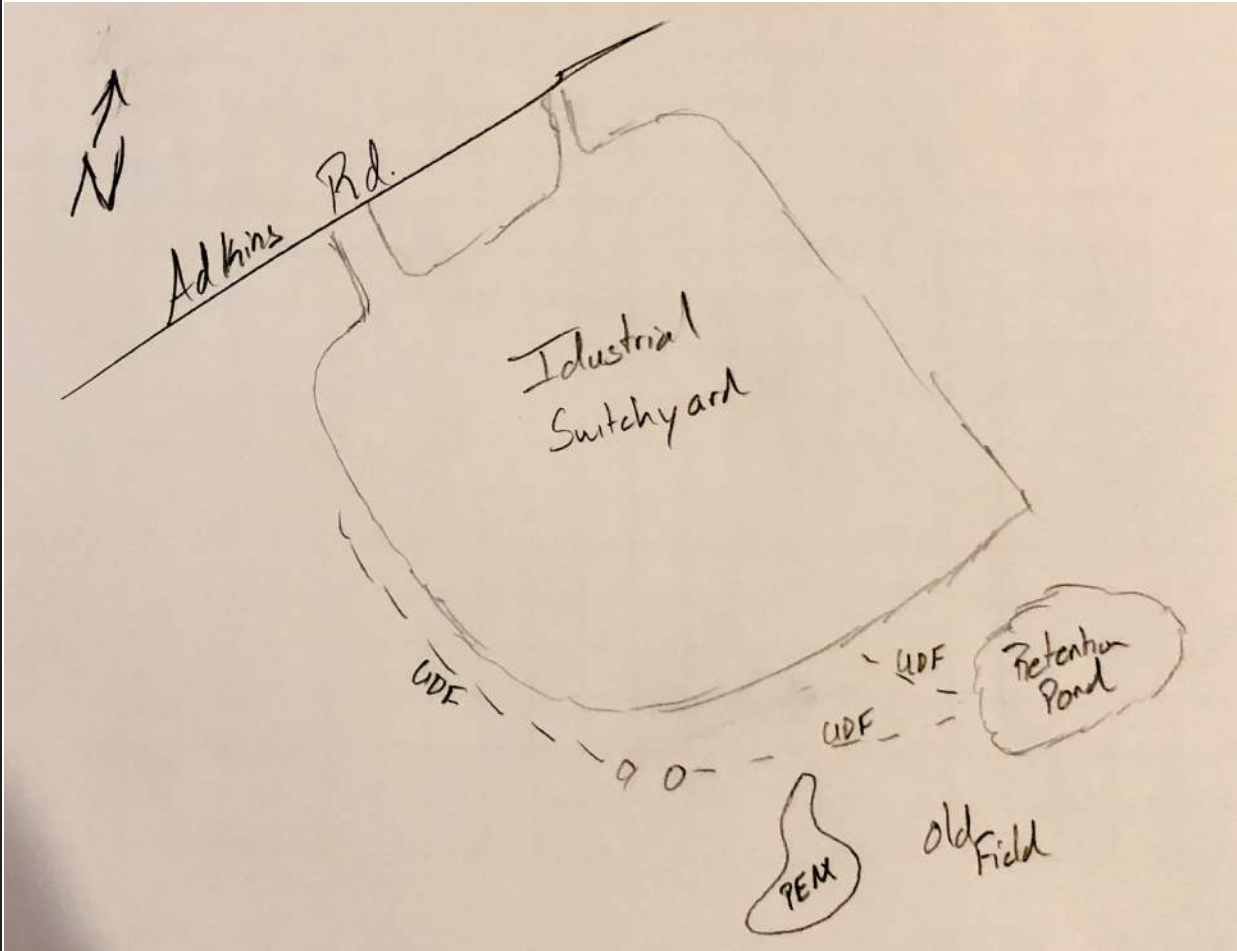
|  |                    |
|--|--------------------|
| <b>Name of Wetland:</b> Wetland 1  |                    |
| <b>Wetland Size (acres, hectares):</b> 0.02 ac.  |                    |
| <b>Sketch: Include north arrow, relationship with other surface waters, vegetation zones, etc.</b> |                    |
|                 |                    |
| <b>Comments, Narrative Discussion, Justification of Category Changes:</b>                          |                    |
| <b>Final score :</b> 16  | <b>Category:</b> 1 |



## Scoring Boundary Worksheet

INSTRUCTIONS. The initial step in completing the ORAM is to identify the “scoring boundaries” of the wetland being rated. In many instances this determination will be relatively easy and the scoring boundaries will coincide with the “jurisdictional boundaries.” For example, the scoring boundary of an isolated cattail marsh located in the middle of a farm field will likely be the same as that wetland’s jurisdictional boundaries. In other instances, however, the scoring boundary will not be as easily determined. Wetlands that are small or isolated from other surface waters often form large contiguous areas or heterogeneous complexes of wetland and upland. In separating wetlands for scoring purposes, the hydrologic regime of the wetland is the main criterion that should be used. Boundaries between contiguous or connected wetlands should be established where the volume, flow, or velocity of water moving through the wetland changes significantly. *Areas with a high degree of hydrologic interaction should be scored as a single wetland.* In determining a wetland’s scoring boundaries, use the guidelines in the ORAM Manual Section 5.0. In certain instances, it may be difficult to establish the scoring boundary for the wetland being rated. These problem situations include wetlands that form a patchwork on the landscape, wetlands divided by artificial boundaries like property fences, roads, or railroad embankments, wetlands that are contiguous with streams, lakes, or rivers, and estuarine or coastal wetlands. These situations are discussed below, however, it is recommended that Rater contact Ohio EPA, Division of Surface Water, 401/Wetlands Section if there are additional questions or a need for further clarification of the appropriate scoring boundaries of a particular wetland.

Wetland 1

Angela Sjollega

11/18/20

| #             | Steps in properly establishing scoring boundaries   | done?                               | not applicable           |
|---------------|---|-------------------------------------|--------------------------|
| <b>Step 1</b> | Identify the wetland area of interest. This may be the site of a proposed impact, a reference site, conservation site, etc.   | <input checked="" type="checkbox"/> | <input type="checkbox"/> |
| <b>Step 2</b> | Identify the locations where there is physical evidence that hydrology changes rapidly. Such evidence includes both natural and human-induced changes including, constrictions caused by berms or dikes, points where the water velocity changes rapidly at rapids or falls, points where significant inflows occur at the confluence of rivers, or other factors that may restrict hydrologic interaction between the wetlands or parts of a single wetland. | <input checked="" type="checkbox"/> | <input type="checkbox"/> |
| <b>Step 3</b> | Delineate the boundary of the wetland to be rated such that all areas of interest that are contiguous to and within the areas where the hydrology does not change significantly, i.e. areas that have a high degree of hydrologic interaction are included within the scoring boundary.   | <input checked="" type="checkbox"/> | <input type="checkbox"/> |
| <b>Step 4</b> | Determine if artificial boundaries, such as property lines, state lines, roads, railroad embankments, etc., are present. These should not be used to establish scoring boundaries unless they coincide with areas where the hydrologic regime changes.  | <input checked="" type="checkbox"/> | <input type="checkbox"/> |
| <b>Step 5</b> | In all instances, the Rater may enlarge the minimum scoring boundaries discussed here to score together wetlands that could be scored separately.   | <input checked="" type="checkbox"/> | <input type="checkbox"/> |
| <b>Step 6</b> | Consult ORAM Manual Section 5.0 for how to establish scoring boundaries for wetlands that form a patchwork on the landscape, divided by artificial boundaries, contiguous to streams, lakes or rivers, or for dual classifications.   | <input checked="" type="checkbox"/> | <input type="checkbox"/> |

**End of Scoring Boundary Determination. Begin Narrative Rating on next page.**

# Narrative Rating

INSTRUCTIONS. Answer each of the following questions. Questions 1, 2, 3 and 4 should be answered based on information obtained from the site visit or the literature *and* by submitting a Data Services Request to the Ohio Department of Natural Resources, Division of Natural Areas and Preserves, Natural Heritage Data Services, 1889 Fountain Square Court, Building F-1, Columbus, Ohio 43224, 614-265-6453 (phone), 614-265-3096 (fax), <http://www.dnr.state.oh.us/dnap>. The remaining questions are designed to be answered primarily by the results of the site visit. Refer to the User's Manual for descriptions of these wetland types. Note: "Critical habitat" is legally defined in the Endangered Species Act and is the geographic area containing physical or biological features essential to the conservation of a listed species or as an area that may require special management considerations or protection. The Rater should contact the Region 3 Headquarters or the Columbus Ecological Services Office for updates as to whether critical habitat has been designated for other federally listed threatened or endangered species. "Documented" means the wetland is listed in the appropriate State of Ohio database.

Wetland 1

Angela Sjollem

11/18/20

| #  | Question   | Circle one   |   |
|----|--|--|---|
| 1  | <p><b>Critical Habitat.</b> Is the wetland in a township, section, or subsection of a United States Geological Survey 7.5 minute Quadrangle that has been designated by the U.S. Fish and Wildlife Service as "critical habitat" for any threatened or endangered plant or animal species? Note: as of January 1, 2001, of the federally listed endangered or threatened species which can be found in Ohio, the Indiana Bat has had critical habitat designated (50 CFR 17.95(a)) and the piping plover has had critical habitat proposed (65 FR 41812 July 6, 2000).</p> | YES <input type="checkbox"/><br><br>Wetland should be evaluated for possible Category 3 status<br><br>Go to Question 2 | NO <input checked="" type="checkbox"/><br><br>Go to Question 2  |
| 2  | <p><b>Threatened or Endangered Species.</b> Is the wetland known to contain an individual of, or documented occurrences of federal or state-listed threatened or endangered plant or animal species?</p>   | YES <input type="checkbox"/><br><br>Wetland is a Category 3 wetland.<br><br>Go to Question 3                           | NO <input checked="" type="checkbox"/><br><br>Go to Question 3  |
| 3  | <p><b>Documented High Quality Wetland.</b> Is the wetland on record in Natural Heritage Database as a high quality wetland?</p>  | YES <input type="checkbox"/><br><br>Wetland is a Category 3 wetland<br><br>Go to Question 4                            | NO <input checked="" type="checkbox"/><br><br>Go to Question 4  |
| 4  | <p><b>Significant Breeding or Concentration Area.</b> Does the wetland contain documented regionally significant breeding or nonbreeding waterfowl, neotropical songbird, or shorebird concentration areas?</p>  | YES <input type="checkbox"/><br><br>Wetland is a Category 3 wetland<br><br>Go to Question 5                            | NO <input checked="" type="checkbox"/><br><br>Go to Question 5  |
| 5  | <p><b>Category 1 Wetlands.</b> Is the wetland less than 0.5 hectares (1 acre) in size and <b>hydrologically isolated</b> and either 1) comprised of vegetation that is dominated (greater than eighty per cent areal cover) by <i>Phalaris arundinacea</i>, <i>Lythrum salicaria</i>, or <i>Phragmites australis</i>, or 2) an acidic pond created or excavated on mined lands that has little or no vegetation?</p>   | YES <input type="checkbox"/><br><br>Wetland is a Category 1 wetland<br><br>Go to Question 6                            | NO <input checked="" type="checkbox"/><br><br>Go to Question 6  |
| 6  | <p><b>Bogs.</b> Is the wetland a peat-accumulating wetland that 1) has no significant inflows or outflows, 2) supports acidophilic mosses, particularly <i>Sphagnum</i> spp., 3) the acidophilic mosses have &gt;30% cover, 4) at least one species from Table 1 is present, and 5) the cover of invasive species (see Table 1) is &lt;25%?</p>  | YES <input type="checkbox"/><br><br>Wetland is a Category 3 wetland<br><br>Go to Question 7                            | NO <input checked="" type="checkbox"/><br><br>Go to Question 7  |
| 7  | <p><b>Fens.</b> Is the wetland a carbon accumulating (peat, muck) wetland that is saturated during most of the year, primarily by a discharge of free flowing, mineral rich, ground water with a circumneutral ph (5.5-9.0) and with one or more plant species listed in Table 1 and the cover of invasive species listed in Table 1 is &lt;25%?</p>   | YES <input type="checkbox"/><br><br>Wetland is a Category 3 wetland<br><br>Go to Question 8a                           | NO <input checked="" type="checkbox"/><br><br>Go to Question 8a |
| 8a | <p><b>"Old Growth Forest."</b> Is the wetland a forested wetland and is the forest characterized by, but not limited to, the following characteristics: overstory canopy trees of great age (exceeding at least 50% of a projected maximum attainable age for a species); little or no evidence of human-caused understory disturbance during the past 80 to 100 years; an all-aged structure and multilayered canopies; aggregations of canopy trees interspersed with canopy gaps; and significant numbers of standing dead snags and downed logs?</p>                   | YES <input type="checkbox"/><br><br>Wetland is a Category 3 wetland.<br><br>Go to Question 8b                          | NO <input checked="" type="checkbox"/><br><br>Go to Question 8b |

|    |   |  |  |
|----|---|--|--|
| 8b | <b>Mature forested wetlands.</b> Is the wetland a forested wetland with 50% or more of the cover of upper forest canopy consisting of deciduous trees with large diameters at breast height (dbh), generally diameters greater than 45cm (17.7in) dbh?  | YES <input type="checkbox"/><br><br>Wetland should be evaluated for possible Category 3 status.<br><br>Go to Question 9a           | NO <input checked="" type="checkbox"/><br><br>Go to Question 9a            |
| 9a | <b>Lake Erie coastal and tributary wetlands.</b> Is the wetland located at an elevation less than 575 feet on the USGS map, adjacent to this elevation, or along a tributary to Lake Erie that is accessible to fish?   | YES <input type="checkbox"/><br><br>Go to Question 9b  | NO <input checked="" type="checkbox"/><br><br>Go to Question 10            |
| 9b | Does the wetland's hydrology result from measures designed to prevent erosion and the loss of aquatic plants, i.e. the wetland is partially hydrologically restricted from Lake Erie due to lakeward or landward dikes or other hydrological controls?  | YES <input type="checkbox"/><br><br>Wetland should be evaluated for possible Category 3 status<br><br>Go to Question 10            | NO <input type="checkbox"/><br><br>Go to Question 9c                       |
| 9c | Are Lake Erie water levels the wetland's primary hydrological influence, i.e. the wetland is hydrologically unrestricted (no lakeward or upland border alterations), or the wetland can be characterized as an "estuarine" wetland with lake and river influenced hydrology. These include sandbar deposition wetlands, estuarine wetlands, river mouth wetlands, or those dominated by submersed aquatic vegetation.   | YES <input type="checkbox"/><br><br>Go to Question 9d  | NO <input type="checkbox"/><br><br>Go to Question 10                       |
| 9d | Does the wetland have a predominance of native species within its vegetation communities, although non-native or disturbance tolerant native species can also be present?   | YES <input type="checkbox"/><br><br>Wetland is a Category 3 wetland<br><br>Go to Question 10                                       | NO <input type="checkbox"/><br><br>Go to Question 9e                       |
| 9e | Does the wetland have a predominance of non-native or disturbance tolerant native plant species within its vegetation communities?  | YES <input type="checkbox"/><br><br>Wetland should be evaluated for possible Category 3 status<br><br>Go to Question 10            | NO <input type="checkbox"/><br><br>Go to Question 10                       |
| 10 | <b>Lake Plain Sand Prairies (Oak Openings)</b> Is the wetland located in Lucas, Fulton, Henry, or Wood Counties and can the wetland be characterized by the following description: the wetland has a sandy substrate with interspersed organic matter, a water table often within several inches of the surface, and often with a dominance of the gramineous vegetation listed in Table 1 (woody species may also be present). The Ohio Department of Natural Resources Division of Natural Areas and Preserves can provide assistance in confirming this type of wetland and its quality. | YES <input type="checkbox"/><br><br>Wetland is a Category 3 wetland.<br><br>Go to Question 11                                      | NO <input checked="" type="checkbox"/><br><br>Go to Question 11            |
| 11 | <b>Relict Wet Prairies.</b> Is the wetland a relict wet prairie community dominated by some or all of the species in Table 1. Extensive prairies were formerly located in the Darby Plains (Madison and Union Counties), Sandusky Plains (Wyandot, Crawford, and Marion Counties), northwest Ohio (e.g. Erie, Huron, Lucas, Wood Counties), and portions of western Ohio Counties (e.g. Darke, Mercer, Miami, Montgomery, Van Wert etc.).   | YES <input type="checkbox"/><br><br>Wetland should be evaluated for possible Category 3 status<br><br>Complete Quantitative Rating | NO <input checked="" type="checkbox"/><br><br>Complete Quantitative Rating |

**Table 1. Characteristic plant species.**

| <b>invasive/exotic spp</b>   | <b>fen species</b>                           | <b>bog species</b>                            | <b>Oak Opening species</b>      | <b>wet prairie species</b>       |
|------------------------------|--|---|---------------------------------|----------------------------------|
| <i>Lythrum salicaria</i>     | <i>Zygadenus elegans</i> var. <i>glaucus</i> | <i>Calla palustris</i>                        | <i>Carex cryptolepis</i>        | <i>Calamagrostis canadensis</i>  |
| <i>Myriophyllum spicatum</i> | <i>Cacalia plantaginea</i>                   | <i>Carex atlantica</i> var. <i>capillacea</i> | <i>Carex lasiocarpa</i>         | <i>Calamagrostis stricta</i>     |
| <i>Najas minor</i>           | <i>Carex flava</i>                           | <i>Carex echinata</i>                         | <i>Carex stricta</i>            | <i>Carex atherodes</i>           |
| <i>Phalaris arundinacea</i>  | <i>Carex sterilis</i>                        | <i>Carex oligosperma</i>                      | <i>Cladium mariscoides</i>      | <i>Carex buxbaumii</i>           |
| <i>Phragmites australis</i>  | <i>Carex stricta</i>                         | <i>Carex trisperma</i>                        | <i>Calamagrostis stricta</i>    | <i>Carex pellita</i>             |
| <i>Potamogeton crispus</i>   | <i>Deschampsia caespitosa</i>                | <i>Chamaedaphne calyculata</i>                | <i>Calamagrostis canadensis</i> | <i>Carex sartwellii</i>          |
| <i>Ranunculus ficaria</i>    | <i>Eleocharis rostellata</i>                 | <i>Decodon verticillatus</i>                  | <i>Quercus palustris</i>        | <i>Gentiana andrewsii</i>        |
| <i>Rhamnus frangula</i>      | <i>Eriophorum viridicarinatum</i>            | <i>Eriophorum virginicum</i>                  |                                 | <i>Helianthus grosseserratus</i> |
| <i>Typha angustifolia</i>    | <i>Gentianopsis</i> spp.                     | <i>Larix laricina</i>                         |                                 | <i>Liatris spicata</i>           |
| <i>Typha xglauca</i>         | <i>Lobelia kalmii</i>                        | <i>Nemopanthus mucronatus</i>                 |                                 | <i>Lysimachia quadriflora</i>    |
|                              | <i>Parnassia glauca</i>                      | <i>Scheuchzeria palustris</i>                 |                                 | <i>Lythrum alatum</i>            |
|                              | <i>Potentilla fruticosa</i>                  | <i>Sphagnum</i> spp.                          |                                 | <i>Pycnanthemum virginianum</i>  |
|                              | <i>Rhamnus alnifolia</i>                     | <i>Vaccinium macrocarpon</i>                  |                                 | <i>Silphium terebinthinaceum</i> |
|                              | <i>Rhynchospora capillacea</i>               | <i>Vaccinium corymbosum</i>                   |                                 | <i>Sorghastrum nutans</i>        |
|                              | <i>Salix candida</i>                         | <i>Vaccinium oxycoccos</i>                    |                                 | <i>Spartina pectinata</i>        |
|                              | <i>Salix myricoides</i>                      | <i>Woodwardia virginica</i>                   |                                 | <i>Solidago riddellii</i>        |
|                              | <i>Salix serissima</i>                       | <i>Xyris difformis</i>                        |                                 |                                  |
|                              | <i>Solidago ohioensis</i>                    |   |                                 |                                  |
|                              | <i>Tofieldia glutinosa</i>                   |   |                                 |                                  |
|                              | <i>Triglochin maritimum</i>                  |   |                                 |                                  |
|                              | <i>Triglochin palustre</i>                   |   |                                 |                                  |

**End of Narrative Rating. Begin Quantitative Rating on next page.**

|                        |                                  |                       |
|------------------------|----------------------------------|-----------------------|
| <b>Site:</b> Wetland 1 | <b>Rater(s):</b> Angela Sjollema | <b>Date:</b> 11/18/20 |
|------------------------|----------------------------------|-----------------------|

|            |          |
|------------|----------|
| 0          | 0        |
| max 6 pts. | subtotal |

### Metric 1. Wetland Area (size).

- Select one size class and assign score.
- >50 acres (>20.2ha) (6 pts)
  - 25 to <50 acres (10.1 to <20.2ha) (5 pts)
  - 10 to <25 acres (4 to <10.1ha) (4 pts)
  - 3 to <10 acres (1.2 to <4ha) (3 pts)
  - 0.3 to <3 acres (0.12 to <1.2ha) (2pts)
  - 0.1 to <0.3 acres (0.04 to <0.12ha) (1 pt)
  - <0.1 acres (0.04ha) (0 pts)

|             |          |
|-------------|----------|
| 4           | 4        |
| max 14 pts. | subtotal |

### Metric 2. Upland buffers and surrounding land use.

- 2a. Calculate average buffer width. Select only one and assign score. Do not double check.
- WIDE. Buffers average 50m (164ft) or more around wetland perimeter (7)
  - MEDIUM. Buffers average 25m to <50m (82 to <164ft) around wetland perimeter (4)
  - NARROW. Buffers average 10m to <25m (32ft to <82ft) around wetland perimeter (1)
  - VERY NARROW. Buffers average <10m (<32ft) around wetland perimeter (0)
- 2b. Intensity of surrounding land use. Select one or double check and average.
- VERY LOW. 2nd growth or older forest, prairie, savannah, wildlife area, etc. (7)
  - LOW. Old field (>10 years), shrub land, young second growth forest. (5)
  - MODERATELY HIGH. Residential, fenced pasture, park, conservation tillage, new fallow field. (3)
  - HIGH. Urban, industrial, open pasture, row cropping, mining, construction. (1)

|             |          |
|-------------|----------|
| 11          | 15       |
| max 30 pts. | subtotal |

### Metric 3. Hydrology.

- 3a. Sources of Water. Score all that apply.
- High pH groundwater (5)
  - Other groundwater (3)
  - Precipitation (1)
  - Seasonal/Intermittent surface water (3)
  - Perennial surface water (lake or stream) (5)
- 3b. Connectivity. Score all that apply.
- 100 year floodplain (1)
  - Between stream/lake and other human use (1)
  - Part of wetland/upland (e.g. forest), complex (1)
  - Part of riparian or upland corridor (1)
- 3c. Maximum water depth. Select only one and assign score.
- >0.7 (27.6in) (3)
  - 0.4 to 0.7m (15.7 to 27.6in) (2)
  - <0.4m (<15.7in) (1)
- 3d. Duration inundation/saturation. Score one or dbl check.
- Semi- to permanently inundated/saturated (4)
  - Regularly inundated/saturated (3)
  - Seasonally inundated (2)
  - Seasonally saturated in upper 30cm (12in) (1)
- 3e. Modifications to natural hydrologic regime. Score one or double check and average.
- None or none apparent (12)
  - Recovered (7)
  - Recovering (3)
  - Recent or no recovery (1)

|   |  |
|---|--|
| Check all disturbances observed   |  |
| <ul style="list-style-type: none"> <li><input type="checkbox"/> ditch</li> <li><input checked="" type="checkbox"/> tile</li> <li><input type="checkbox"/> dike</li> <li><input type="checkbox"/> weir</li> <li><input type="checkbox"/> stormwater input</li> </ul> | <ul style="list-style-type: none"> <li><input type="checkbox"/> point source (nonstormwater)</li> <li><input type="checkbox"/> filling/grading</li> <li><input type="checkbox"/> road bed/RR track</li> <li><input type="checkbox"/> dredging</li> <li><input type="checkbox"/> other _____</li> </ul> |

|             |          |
|-------------|----------|
| 5           | 20       |
| max 20 pts. | subtotal |

### Metric 4. Habitat Alteration and Development.

- 4a. Substrate disturbance. Score one or double check and average.
- None or none apparent (4)
  - Recovered (3)
  - Recovering (2)
  - Recent or no recovery (1)
- 4b. Habitat development. Select only one and assign score.
- Excellent (7)
  - Very good (6)
  - Good (5)
  - Moderately good (4)
  - Fair (3)
  - Poor to fair (2)
  - Poor (1)
- 4c. Habitat alteration. Score one or double check and average.
- None or none apparent (9)
  - Recovered (6)
  - Recovering (3)
  - Recent or no recovery (1)

|   |  |
|---|--|
| Check all disturbances observed   |  |
| <ul style="list-style-type: none"> <li><input checked="" type="checkbox"/> mowing</li> <li><input type="checkbox"/> grazing</li> <li><input type="checkbox"/> clearcutting</li> <li><input type="checkbox"/> selective cutting</li> <li><input type="checkbox"/> woody debris removal</li> <li><input type="checkbox"/> toxic pollutants</li> </ul> | <ul style="list-style-type: none"> <li><input type="checkbox"/> shrub/sapling removal</li> <li><input type="checkbox"/> herbaceous/aquatic bed removal</li> <li><input type="checkbox"/> sedimentation</li> <li><input type="checkbox"/> dredging</li> <li><input type="checkbox"/> farming</li> <li><input type="checkbox"/> nutrient enrichment</li> </ul> |

|                    |
|--------------------|
| 20                 |
| subtotal this page |

|                        |                                  |                       |
|------------------------|----------------------------------|-----------------------|
| <b>Site:</b> Wetland 1 | <b>Rater(s):</b> Angela Sjollema | <b>Date:</b> 11/18/20 |
|------------------------|----------------------------------|-----------------------|

20

subtotal first page

|             |          |
|-------------|----------|
| 0           | 20       |
| max 10 pts. | subtotal |

### Metric 5. Special Wetlands.

Check all that apply and score as indicated.

- Bog (10)
- Fen (10)
- Old growth forest (10)
- Mature forested wetland (5)
- Lake Erie coastal/tributary wetland-unrestricted hydrology (10)
- Lake Erie coastal/tributary wetland-restricted hydrology (5)
- Lake Plain Sand Prairies (Oak Openings) (10)
- Relict Wet Prairies (10)
- Known occurrence state/federal threatened or endangered species (10)
- Significant migratory songbird/water fowl habitat or usage (10)
- Category 1 Wetland. See Question 1 Qualitative Rating (-10)

|             |          |
|-------------|----------|
| -4          | 16       |
| max 20 pts. | subtotal |

### Metric 6. Plant communities, interspersions, microtopography.

6a. Wetland Vegetation Communities.

Score all present using 0 to 3 scale.

- Aquatic bed
- Emergent
- Shrub
- Forest
- Mudflats
- Open water
- Other \_\_\_\_\_

6b. horizontal (plan view) Interspersion.

Select only one.

- High (5)
- Moderately high(4)
- Moderate (3)
- Moderately low (2)
- Low (1)
- None (0)

6c. Coverage of invasive plants. Refer to Table 1 ORAM long form for list. Add or deduct points for coverage

- Extensive >75% cover (-5)
- Moderate 25-75% cover (-3)
- Sparse 5-25% cover (-1)
- Nearly absent <5% cover (0)
- Absent (1)

6d. Microtopography.

Score all present using 0 to 3 scale.

- 0 Vegetated hummocks/tussucks
- 0 Coarse woody debris >15cm (6in)
- 0 Standing dead >25cm (10in) dbh
- 0 Amphibian breeding pools

#### Vegetation Community Cover Scale

|   |   |
|---|---|
| 0 | Absent or comprises <0.1ha (0.2471 acres) contiguous area   |
| 1 | Present and either comprises small part of wetland's vegetation and is of moderate quality, or comprises a significant part but is of low quality |
| 2 | Present and either comprises significant part of wetland's vegetation and is of moderate quality or comprises a small part and is of high quality |
| 3 | Present and comprises significant part, or more, of wetland's vegetation and is of high quality   |

#### Narrative Description of Vegetation Quality

|      |  |
|------|--|
| low  | Low spp diversity and/or predominance of nonnative or disturbance tolerant native species  |
| mod  | Native spp are dominant component of the vegetation, although nonnative and/or disturbance tolerant native spp can also be present, and species diversity moderate to moderately high, but generally w/o presence of rare threatened or endangered spp |
| high | A predominance of native species, with nonnative spp and/or disturbance tolerant native spp absent or virtually absent, and high spp diversity and often, but not always, the presence of rare, threatened, or endangered spp                          |

#### Mudflat and Open Water Class Quality

|   |   |
|---|---|
| 0 | Absent <0.1ha (0.247 acres)             |
| 1 | Low 0.1 to <1ha (0.247 to 2.47 acres)   |
| 2 | Moderate 1 to <4ha (2.47 to 9.88 acres) |
| 3 | High 4ha (9.88 acres) or more           |

#### Microtopography Cover Scale

|   |  |
|---|--|
| 0 | Absent   |
| 1 | Present very small amounts or if more common of marginal quality                               |
| 2 | Present in moderate amounts, but not of highest quality or in small amounts of highest quality |
| 3 | Present in moderate or greater amounts and of highest quality                                  |

16

**End of Quantitative Rating. Complete Categorization Worksheets.**

# ORAM Summary Worksheet

Wetland 1

Angela Sjollema

11/18/20

|                                  |   | <b>circle<br/>answer or<br/>insert<br/>score</b>     | <b>Result</b>  |
|----------------------------------|---|--|--|
| Narrative Rating                 | Question 1. Critical Habitat  | NO   | If yes, Category 3.                                  |
|                                  | Question 2. Threatened or Endangered Species                        | NO   | If yes, Category 3.                                  |
|                                  | Question 3. High Quality Natural Wetland                            | NO   | If yes, Category 3.                                  |
|                                  | Question 4. Significant bird habitat                                | NO   | If yes, Category 3.                                  |
|                                  | Question 5. Category 1 Wetlands                                     | NO   | If yes, Category 1.                                  |
|                                  | Question 6. Bogs  | NO   | If yes, Category 3.                                  |
|                                  | Question 7. Fens  | NO   | If yes, Category 3.                                  |
|                                  | Question 8a. Old Growth Forest                                      | NO   | If yes, Category 3.                                  |
|                                  | Question 8b. Mature Forested Wetland                                | NO   | If yes, evaluate for Category 3; may also be 1 or 2. |
|                                  | Question 9b. Lake Erie Wetlands - Restricted                        | NO   | If yes, evaluate for Category 3; may also be 1 or 2. |
|                                  | Question 9d. Lake Erie Wetlands – Unrestricted with native plants   | NO   | If yes, Category 3                                   |
|                                  | Question 9e. Lake Erie Wetlands - Unrestricted with invasive plants | NO   | If yes, evaluate for Category 3; may also be 1 or 2. |
|                                  | Question 10. Oak Openings   | NO   | If yes, Category 3                                   |
| Question 11. Relict Wet Prairies | NO  | If yes, evaluate for Category 3; may also be 1 or 2. |  |
| Quantitative Rating              | Metric 1. Size  | 0  |  |
|                                  | Metric 2. Buffers and surrounding land use                          | 4  |  |
|                                  | Metric 3. Hydrology   | 11   |  |
|                                  | Metric 4. Habitat   | 5  |  |
|                                  | Metric 5. Special Wetland Communities                               | 0  |  |
|                                  | Metric 6. Plant communities, interspersions, microtopography        | -4   |  |
|                                  | TOTAL SCORE   | 16   | Category based on score breakpoints<br>Category 1    |

**Complete Wetland Categorization Worksheet.**



## Wetland Categorization Worksheet

| Choices  | Circle one  |  | Evaluation of Categorization Result of ORAM   |
|--|---|--|---|
| Did you answer "Yes" to any of the following questions:<br><br>Narrative Rating Nos. 2, 3, 4, 6, 7, 8a, 9d, 10   | YES <input type="checkbox"/><br><br>Wetland is categorized as a Category 3 wetland  | NO <input checked="" type="checkbox"/>   | Is quantitative rating score <i>less</i> than the Category 2 scoring threshold ( <i>excluding</i> gray zone)? If yes, reevaluate the category of the wetland using the narrative criteria in OAC Rule 3745-1-54(C) and biological and/or functional assessments to determine if the wetland has been over-categorized by the ORAM   |
| Did you answer "Yes" to any of the following questions:<br><br>Narrative Rating Nos. 1, 8b, 9b, 9e, 11   | YES <input type="checkbox"/><br><br>Wetland should be evaluated for possible Category 3 status  | NO <input checked="" type="checkbox"/>   | Evaluate the wetland using the 1) narrative criteria in OAC Rule 3745-1-54(C) and 2) the quantitative rating score. If the wetland is determined to be a Category 3 wetland using either of these, it should be categorized as a Category 3 wetland. Detailed biological and/or functional assessments may also be used to determine the wetland's category.  |
| Did you answer "Yes" to<br><br>Narrative Rating No. 5  | YES <input type="checkbox"/><br><br>Wetland is categorized as a Category 1 wetland  | NO <input checked="" type="checkbox"/>   | Is quantitative rating score <i>greater</i> than the Category 2 scoring threshold ( <i>including</i> any gray zone)? If yes, reevaluate the category of the wetland using the narrative criteria in OAC Rule 3745-1-54(C) and biological and/or functional assessments to determine if the wetland has been under-categorized by the ORAM   |
| Does the quantitative score fall within the scoring range of a Category 1, 2, or 3 wetland?  | YES <input checked="" type="checkbox"/><br><br>Wetland is assigned to the appropriate category based on the scoring range   | NO <input type="checkbox"/>  | If the score of the wetland is located within the scoring range for a particular category, the wetland should be assigned to that category. In all instances however, the narrative criteria described in OAC Rule 3745-1-54(C) can be used to clarify or change a categorization based on a quantitative score.  |
| Does the quantitative score fall with the "gray zone" for Category 1 or 2 or Category 2 or 3 wetlands?   | YES <input type="checkbox"/><br><br>Wetland is assigned to the higher of the two categories or assigned to a category based on detailed assessments and the narrative criteria  | NO <input checked="" type="checkbox"/>   | Rater has the option of assigning the wetland to the higher of the two categories or to assign a category based on the results of a nonrapid wetland assessment method, e.g. functional assessment, biological assessment, etc, and a consideration of the narrative criteria in OAC rule 3745-1-54(C).   |
| Does the wetland otherwise exhibit <i>moderate OR superior</i> hydrologic OR habitat, OR recreational functions AND the wetland was <i>not</i> categorized as a Category 2 wetland (in the case of moderate functions) or a Category 3 wetland (in the case of superior functions) by this method? | YES <input type="checkbox"/><br><br>Wetland was undercategorized by this method. A written justification for recategorization should be provided on Background Information Form | NO <input checked="" type="checkbox"/><br><br>Wetland is assigned to category as determined by the ORAM. | A wetland may be undercategorized using this method, but still exhibit one or more superior functions, e.g. a wetland's biotic communities may be degraded by human activities, but the wetland may still exhibit superior hydrologic functions because of its type, landscape position, size, local or regional significance, etc. In this circumstance, the narrative criteria in OAC Rule 3745-1-54(C)(2) and (3) are controlling, and the under-categorization should be corrected. A written justification with supporting reasons or information for this determination should be provided. |

### Final Category

| Choose one | Category 1                          | Category 2               | Category 3               |
|------------|-------------------------------------|--------------------------|--------------------------|
| Category 1 | <input checked="" type="checkbox"/> | <input type="checkbox"/> | <input type="checkbox"/> |

**End of Ohio Rapid Assessment Method for Wetlands.**



Representative Photographs  
January 20, 2021

## **Appendix D REPRESENTATIVE PHOTOGRAPHS**

### **D.1 WETLAND AND WATERBODY PHOTOGRAPHS**



Photo Location 1. View of wetland determination sample point SP01. Photograph taken facing east.



Photo Location 1. View of wetland determination sample point SP01 soil profile.



AEP Ohio Transmission Company, Inc.  
Adkins Station Expansion Project  
Pickaway County, Ohio



Photo Location 2. View of upland drainage feature. Photograph taken facing southeast.



Photo Location 3. View of Open Water 1, storm water retention pond. Photograph taken facing southeast.



AEP Ohio Transmission Company, Inc.  
Adkins Station Expansion Project  
Pickaway County, Ohio



Photo Location 4. View of Open Water 1, storm water retention pond. Photograph taken facing northwest.



Photo Location 5. View of rock channel outlet. Photograph taken facing northwest.



AEP Ohio Transmission Company, Inc.  
Adkins Station Expansion Project  
Pickaway County, Ohio



Photo Location 6. View of upland drainage feature. Photograph taken facing northwest.



Photo Location 6. View of rock check dam.





Photo Location 7. View wetland determination sample point SP02 (Wetland 1). Photograph taken facing northwest.



Photo Location 7. View of wetland determination sample point SP02 soil profile.



AEP Ohio Transmission Company, Inc.  
Adkins Station Expansion Project  
Pickaway County, Ohio



Photo Location 8. View of wetland determination sample point SP02 (Wetland 1). Photograph taken facing north.



Photo Location 8. View of wetland determination sample point SP02 (Wetland 1). Photograph taken facing east.



AEP Ohio Transmission Company, Inc.  
Adkins Station Expansion Project  
Pickaway County, Ohio



Photo Location 8. View of wetland determination sample point SP02 (Wetland 1). Photograph taken facing south.



Photo Location 8. View of wetland determination sample point SP02 (Wetland 1). Photograph taken facing west.



AEP Ohio Transmission Company, Inc.  
Adkins Station Expansion Project  
Pickaway County, Ohio



Photo Location 9. View of wetland determination sample point SP03 (upland). Photograph taken facing northwest.



Photo Location 9. View of wetland determination sample point SP03 soil profile.





Photo Location 10. View of wetland determination sample point SP04 (upland). Photograph taken facing southwest.



Photo Location 10. View of wetland determination sample point SP04 soil profile.

**ADKINS STATION EXPANSION PROJECT, PICKAWAY COUNTY, OHIO**

Representative Photographs  
January 20, 2021

**D.2 HABITAT PHOTOGRAPHS**



AEP Ohio Transmission Company, Inc.  
Adkins Station Expansion Project  
Pickaway County, Ohio



Photo Location 1. View of old field habitat. Photograph taken facing southwest.



Photo Location 2. View of Industrial habitat. Photograph taken facing north.

AEP Ohio Transmission Company, Inc.  
Adkins Station Expansion Project  
Pickaway County, Ohio



Photo Location 3. View of maintained lawn. Photograph taken facing northeast.



Photo Location 4. View of old field, left, and maintained lawn, center. Photograph taken facing southeast.



AEP Ohio Transmission Company, Inc.  
Adkins Station Expansion Project  
Pickaway County, Ohio



Photo Location 5. View of industrial habitat. Photograph taken facing south.



Photo Location 6. View of agricultural field. Photograph taken facing southeast.

AEP Ohio Transmission Company, Inc.  
Adkins Station Expansion Project  
Pickaway County, Ohio



Photo Location 7. View of agricultural field. Photograph taken facing east.



**ADKINS STATION EXPANSION PROJECT, PICKAWAY COUNTY, OHIO**

Agency Correspondence  
January 20, 2021

**Appendix E AGENCY CORRESPONDENCE**



# Ohio Department of Natural Resources

MIKE DEWINE, GOVERNOR

MARY MERTZ, DIRECTOR

## Office of Real Estate

*John Kessler, Chief*

2045 Morse Road – Bldg. E-2

Columbus, OH 43229

Phone: (614) 265-6621

Fax: (614) 267-4764

January 11, 2021

Kim Carter  
Stantec  
1500 Lake Shore Drive Suite 100  
Columbus OH 43204-3800

**Re:** 20-1079; Adkins Station Expansion Project

**Project:** The proposed project involves expansion of the existing Adkins Substation.

**Location:** The proposed project is located in Darby Township, Pickaway County, Ohio.

The Ohio Department of Natural Resources (ODNR) has completed a review of the above referenced project. These comments were generated by an inter-disciplinary review within the Department. These comments have been prepared under the authority of the Fish and Wildlife Coordination Act (48 Stat. 401, as amended; 16 U.S.C. 661 et seq.), the National Environmental Policy Act, the Coastal Zone Management Act, Ohio Revised Code and other applicable laws and regulations. These comments are also based on ODNR's experience as the state natural resource management agency and do not supersede or replace the regulatory authority of any local, state or federal agency nor relieve the applicant of the obligation to comply with any local, state or federal laws or regulations.

**Natural Heritage Database:** The Natural Heritage Database has no records at or within a one-mile radius of the project area.

A review of the Ohio Natural Heritage Database indicates there are no other records of state endangered or threatened plants or animals within the project area. There are also no records of state potentially threatened plants, special interest or species of concern animals, or any federally listed species. In addition, we are unaware of any unique ecological sites, geologic features, animal assemblages, scenic rivers, state wildlife areas, state nature preserves, state or national parks, state or national forests, national wildlife refuges, or other protected natural areas within the project area. The review was performed on the project area you specified in your request as well as an additional one-mile radius. Records searched date from 1980.

Please note that Ohio has not been completely surveyed and we rely on receiving information from many sources. Therefore, a lack of records for any particular area is not a statement that rare species or unique features are absent from that area. Although all types of plant communities have been surveyed, we only maintain records on the highest quality areas.

**Fish and Wildlife:** The Division of Wildlife (DOW) has the following comments.

The DOW recommends that impacts to streams, wetlands and other water resources be avoided and minimized to the fullest extent possible, and that best management practices be utilized to minimize erosion and sedimentation.

The project is within the vicinity of records for the Indiana bat (*Myotis sodalis*), a state endangered and federally endangered species. Because presence of state endangered bat species has been established in the area, summer tree cutting is not recommended, and additional summer surveys would not constitute presence/absence in the area. However, limited summer tree cutting inside this buffer may be acceptable after further consultation with DOW (contact Sarah Stankavich, [sarah.stankavich@dnr.state.oh.us](mailto:sarah.stankavich@dnr.state.oh.us)).

In addition, the entire state of Ohio is within the range of the Indiana bat (*Myotis sodalis*), a state endangered and federally endangered species, the northern long-eared bat (*Myotis septentrionalis*), a state endangered and federally threatened species, the little brown bat (*Myotis lucifugus*), a state endangered species, and the tricolored bat (*Perimyotis subflavus*), a state endangered species. During the spring and summer (April 1 through September 30), these bat species predominately roost in trees behind loose, exfoliating bark, in crevices and cavities, or in the leaves. However, these species are also dependent on the forest structure surrounding roost trees. The DOW recommends tree cutting only occur from October 1 through March 31, conserving trees with loose, shaggy bark and/or crevices, holes, or cavities, as well as trees with DBH  $\geq$  20 if possible.

The DOW also recommends that a desktop habitat assessment, followed by a field assessment if needed, is conducted to determine if there are potential hibernaculum(a) present within the project area. Information about how to conduct habitat assessments can be found in the current USFWS “Range-wide Indiana Bat Survey Guidelines.” If a habitat assessment finds that potential hibernacula are present within 0.25 miles of the project area, please send this information to Sarah Stankavich, [sarah.stankavich@dnr.state.oh.us](mailto:sarah.stankavich@dnr.state.oh.us) for project recommendations. If a potential or known hibernaculum is found, the DOW recommends a 0.25-mile tree cutting and subsurface disturbance buffer around the hibernaculum entrance, however, limited summer or winter tree cutting may be acceptable after consultation with DOW. If no tree cutting or subsurface impacts to a hibernaculum are proposed, this project is not likely to impact these species.

The project is within the range of the following listed mussel species:

Federally Endangered

clubshell (*Pleurobema clava*)  
fanshell (*Cyprogenia stegaria*)  
northern riffleshell (*Epioblasma torulosa rangiana*)  
purple cat’s paw (*Epioblasma o. obliquata*)  
rayed bean (*Villosa fabalis*)  
snuffbox (*Epioblasma triquetra*)

Federally Threatened

rabbitsfoot (*Quadrula cylindrica cylindrica*)

State Endangered

butterfly (*Ellipsaria lineolata*)  
ebonyshell (*Fusconaia ebenus*)  
elephant-ear (*Elliptio crassidens*)  
long-solid (*Fusconaia maculata maculata*)

Ohio pigtoe (*Pleurobema cordatum*)  
pyramid pigtoe (*Pleurobema rubrum*)  
sharp-ridged pocketbook (*Lampsilis ovata*)  
washboard (*Megaloniaias nervosa*)

State Threatened

black sandshell (*Ligumia recta*)  
fawnsfoot (*Truncilla donaciformis*)  
pondhorn (*Unio merus tetralasmus*)  
threehorn wartyback (*Obliquaria reflexa*)

Due to the location, and that there is no in-water work proposed in a perennial stream of sufficient size, this project is not likely to impact these species.

The project is within the range of the following listed fish species:

Federally Endangered

Scioto madtom (*Noturus trautmani*)

State Endangered

bigeye shiner (*Notropis boops*)  
goldeye (*Hiodon alosoides*)  
northern brook lamprey (*Ichthyomyzon fossor*)  
northern madtom (*Noturus stigmosus*)  
shortnose gar (*Lepisosteus platostomus*)  
spotted darter (*Etheostoma maculatum*)  
shovelnose sturgeon (*Scaphirhynchus platyrhynchus*)

State Threatened

blue sucker (*Cycleptus elongatus*)  
lake chubsucker (*Erimyzon sucetta*)  
paddlefish (*Polyodon spathula*)  
Tippecanoe darter (*Etheostoma tippecanoe*)

The DOW recommends no in-water work in perennial streams from April 15 through June 30 to reduce impacts to indigenous aquatic species and their habitat. If no in-water work is proposed in a perennial stream, this project is not likely to impact these or other aquatic species.

The project is within the range of the lark sparrow (*Chondestes grammacus*), a state endangered bird. This sparrow nests in grassland habitats with scattered shrub layers, disturbed open areas, as well as patches of bare soil. In the Oak Openings area west of Toledo, lark sparrows occupy open grass and shrubby fields along sandy beach ridges. These summer residents normally migrate out of Ohio shortly after their young fledge or leave the nest. If this type of habitat will be impacted, construction should be avoided in this habitat during the species' nesting period of May 1 to June 30. If this habitat will not be impacted, this project is not likely to impact this species.

The project is within the range of the least bittern (*Ixobrychus exilis*), a state threatened bird. This secretive marsh species prefers dense emergent wetlands with thick stands of cattails, sedges, sawgrass or other semiaquatic vegetation interspersed with woody vegetation and open water. If this type of habitat will be impacted, construction should be avoided in this habitat during the species' nesting period of May 1 to July 31. If this type of habitat will not be impacted, this project is not likely to impact this species.

The project is within the range of the northern harrier (*Circus hudsonis*), a state endangered bird. This is a common migrant and winter species. Nesters are much rarer, although they occasionally breed in large marshes and grasslands. Harriers often nest in loose colonies. The female builds a nest out of sticks on the ground, often on top of a mound. Harriers hunt over grasslands. If this type of habitat will be impacted, construction should be avoided in this habitat during the species' nesting period of May 15 to August 1. If this habitat will not be impacted, this project is not likely to impact this species.

The project is within the range of the sandhill crane (*Grus canadensis*), a state threatened species. Sandhill cranes are primarily a wetland-dependent species. On their wintering grounds, they will utilize agricultural fields; however, they roost in shallow, standing water or moist bottomlands. On breeding grounds, they require a rather large tract of wet meadow, shallow marsh, or bog for nesting. If grassland, prairie, or wetland habitat will be impacted, construction should be avoided in this habitat during the species' nesting period of April 1 to September 1. If this habitat will not be impacted, this project is not likely to have an impact on this species.

The project is within the range of the upland sandpiper (*Bartramia longicauda*), a state endangered bird. Nesting upland sandpipers utilize dry grasslands including native grasslands, seeded grasslands, grazed and ungrazed pasture, hayfields, and grasslands established through the Conservation Reserve Program (CRP). If this type of habitat will be impacted, construction should be avoided in this habitat during the species' nesting period of April 15 to July 31. If this type of habitat will not be impacted, this project is not likely to impact this species.

Due to the potential of impacts to federally listed species, as well as to state listed species, we recommend that this project be coordinated with the U.S. Fish & Wildlife Service.

**Water Resources:** The Division of Water Resources has the following comment.

The local floodplain administrator should be contacted concerning the possible need for any floodplain permits or approvals for this project. Your local floodplain administrator contact information can be found at the website below.

[http://water.ohiodnr.gov/portals/soilwater/pdf/floodplain/Floodplain%20Manager%20Community%20Contact%20List\\_8\\_16.pdf](http://water.ohiodnr.gov/portals/soilwater/pdf/floodplain/Floodplain%20Manager%20Community%20Contact%20List_8_16.pdf)

ODNR appreciates the opportunity to provide these comments. Please contact Sarah Tebbe, Environmental Specialist, at [Sarah.Tebbe@dnr.ohio.gov](mailto:Sarah.Tebbe@dnr.ohio.gov) if you have questions about these comments or need additional information.

Mike Pettegrew  
Environmental Services Administrator (Acting)

# United States Department of the Interior

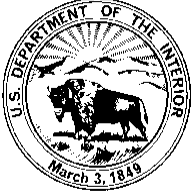

## FISH AND WILDLIFE SERVICE

Ecological Services  
4625 Morse Road, Suite 104  
Columbus, Ohio 43230  
(614) 416-8993 / FAX (614) 416-8994

November 17, 2020

Ms. Carter  
Stantec Consulting Services Inc.  
1500 Lake Shore Drive, Suite 100  
Columbus, OH 43204-3800

TAILS# 03E15000-2021-TA-0326

Re: Adkins Station Expansion Project, Pickaway County, Ohio

Dear Ms. Carter,

We have received your recent correspondence requesting information about the subject proposal. There are no Federal wilderness areas, wildlife refuges or designated critical habitat within the vicinity of the project area.

**FEDERALLY LISTED, PROPOSED, AND CANDIDATE SPECIES COMMENTS:** Due to the project, type, size, and location, we do not anticipate adverse effects to federally endangered, threatened, proposed, or candidate species. Should the project design change, or during the term of this action, additional information on listed or proposed species or their critical habitat become available, or if new information reveals effects of the action that were not previously considered, consultation with the U.S. Fish and Wildlife Service should be initiated to assess any potential impacts.

If you have questions, or if we can be of further assistance in this matter, please contact our office at (614) 416-8993 or [ohio@fws.gov](mailto:ohio@fws.gov).

Sincerely,

Patrice Ashfield  
Field Office Supervisor

**This foregoing document was electronically filed with the Public Utilities  
Commission of Ohio Docketing Information System on**

**4/28/2023 2:15:46 PM**

**in**

**Case No(s). 23-0042-EL-BNR**

Summary: Notice Construction Notice electronically filed by Hector Garcia-Santana  
on behalf of Ohio Power Company.